

All changes and additional exterior work must be approved by the HDLC

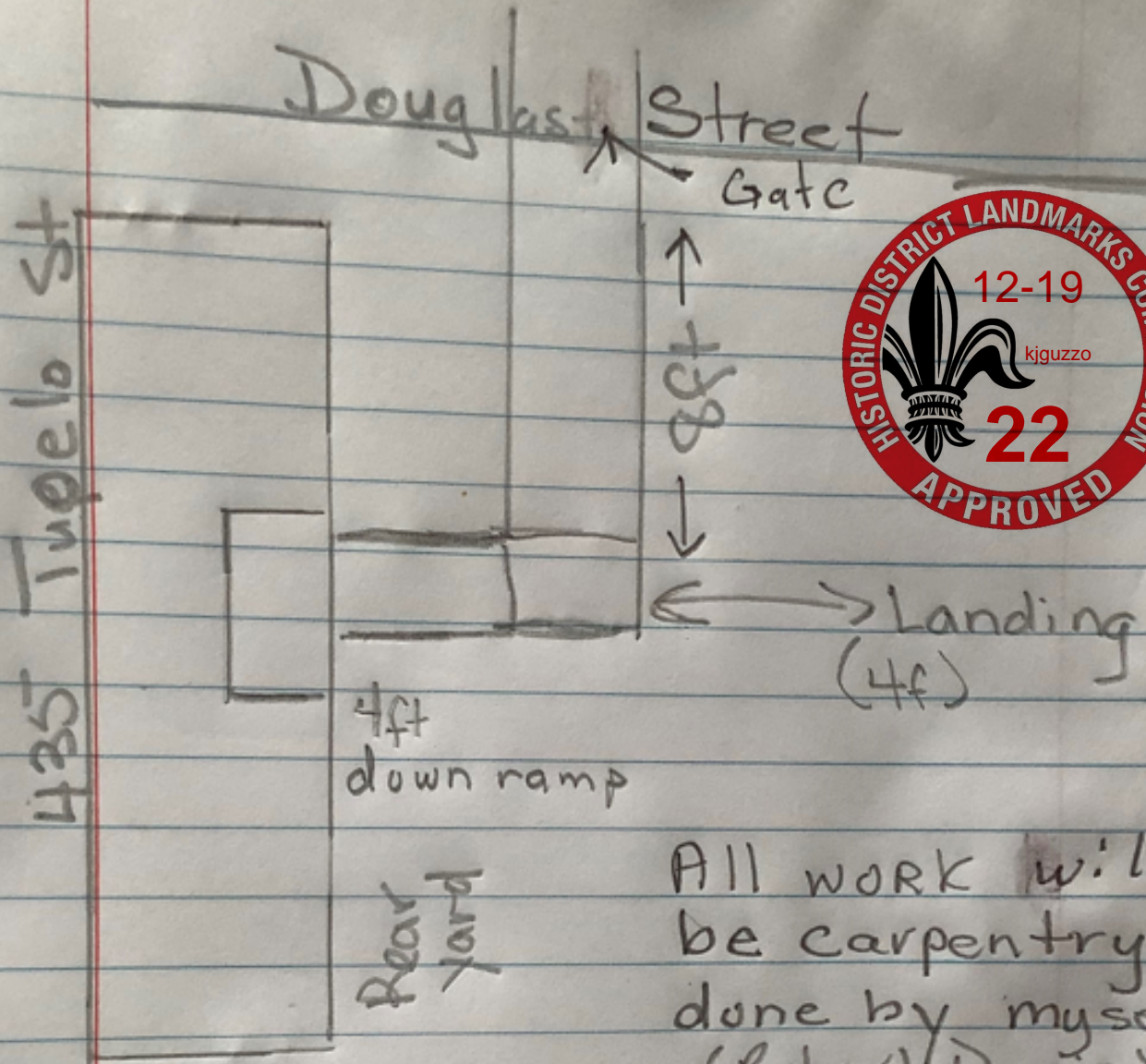

As per applicant email. ramp to be carpentry, constructed of pressure treated wood, anchored to concrete with metal plates. No additional fixtures or elements to be added without HDLC approval.

All work will be carpentry done by myself (Robert Davis). I am a retired carpenter and have filed required exemption affidavits. See attached.

My mother lives with me and we need this ASAP.

Thank you.

All changes and additional exterior work must be approved by the HDLC

435 Tulpe Lo St
Rear of
House



Back Yard

As per applicant email. ramp to be carpentry, constructed of pressure treated wood, anchored to concrete with metal plates. No additional fixtures or elements to be added without HDLC approval.

8 Foot

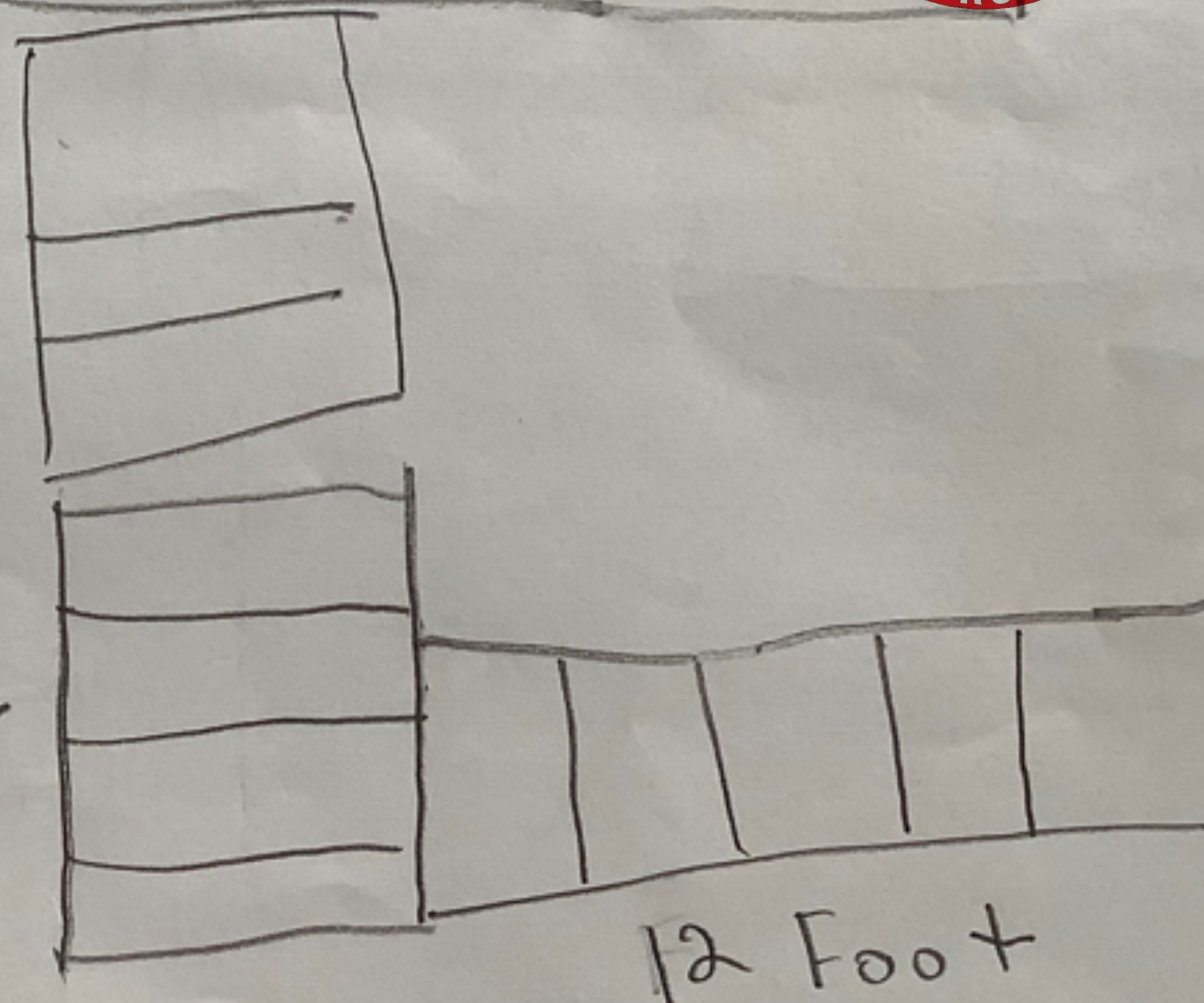

12 Foot

All changes and additional exterior work must be approved by the HDLC

435 Tuepelo St

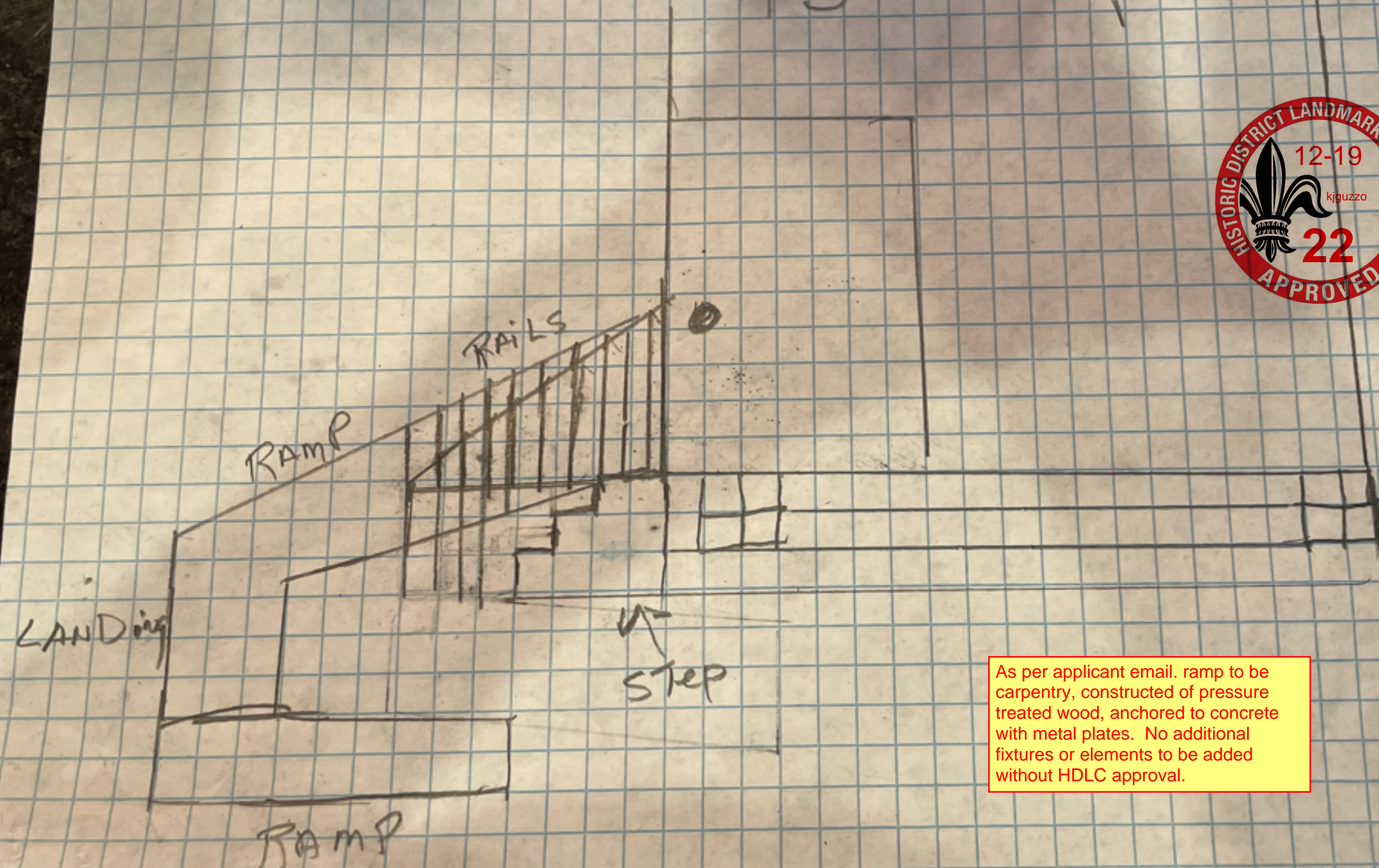

As per applicant email. ramp to be carpentry, constructed of pressure treated wood, anchored to concrete with metal plates. No additional fixtures or elements to be added without HDLC approval.