

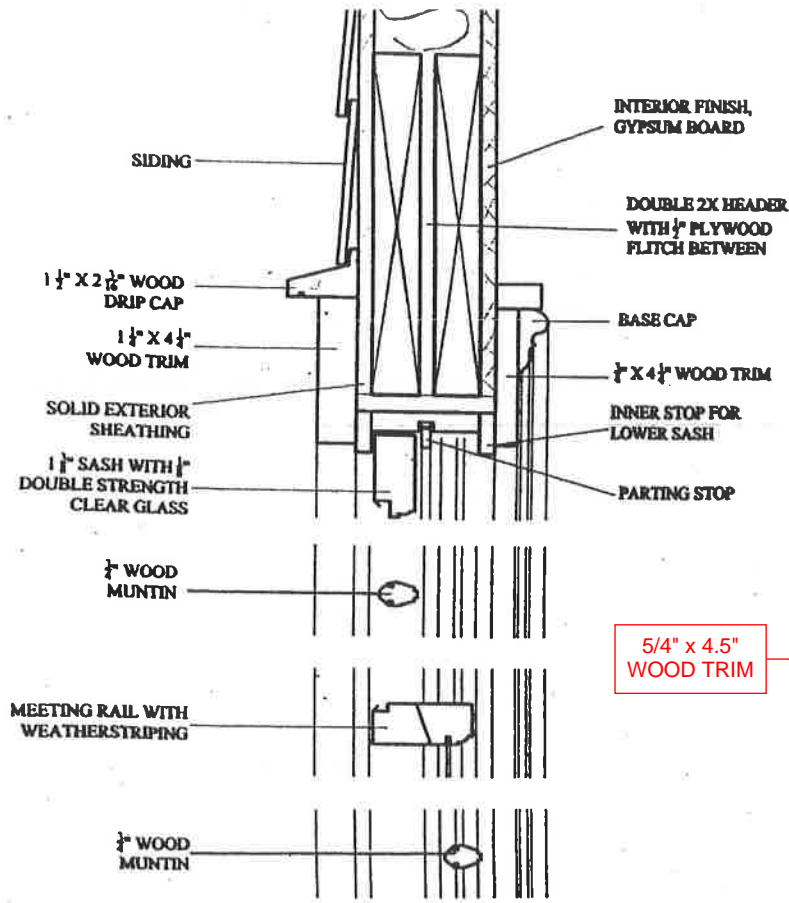

# WINDOW DETAIL

WINDOWS MUST BE RECESS MOUNTED INTO THE OPENING



5/4" x 4.5" WOOD TRIM

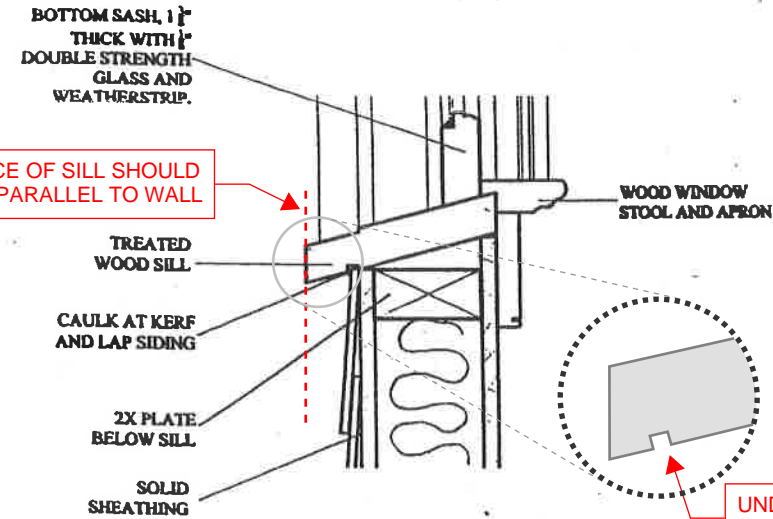
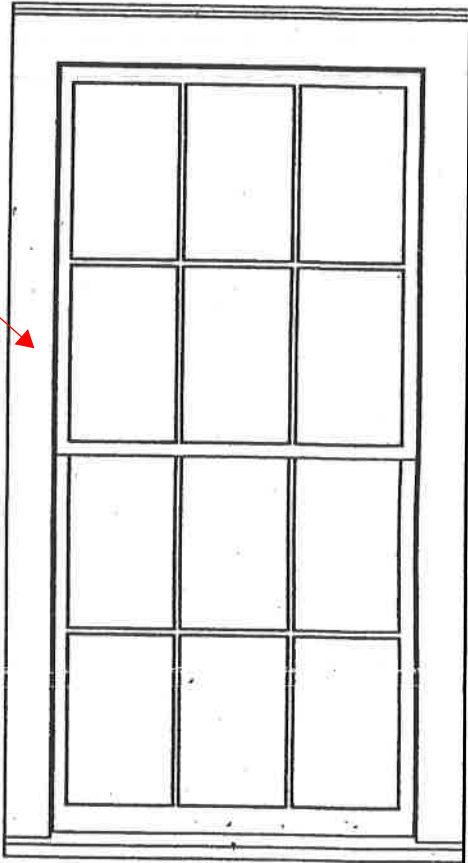

SECTION  
3" = 1'

EXTERIOR ELEVATION  
1 1/2" = 1'

UNDERSIDE OF SILL SHOULD HAVE A ROUTED DRIP LINE

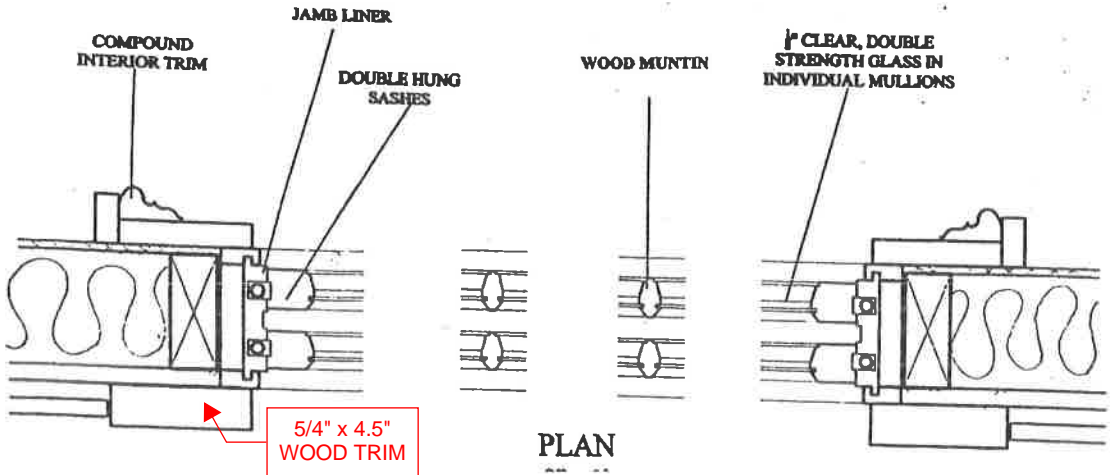

PLAN

# HDLC + VCC

## APPROVED MORTAR FORMULA

### MORTAR

- 1 part Portland Cement
- 3 parts lime
- 9 parts sand
- enough water to form a workable mix

### STUCCO

base coat - consists of 2 coats for 5/8" total thickness

- 1 part Portland Cement
- 3 parts lime
- 9 parts sand
- 6 lbs./cubic yard hair or fiber
- enough water to form a workable mix

finish coat – 1/4" total thickness

- 1 part Portland Cement
- 3 parts lime
- 9 parts sand
- enough water to form a workable mix



Downspouts to be located on side elevations

