

Legend

- Pier
- Adjust Pier: (A)
- Replace Pier: (R)
- Install Pier: (I)
- Elevation (in): -1.0
- Install Sill:

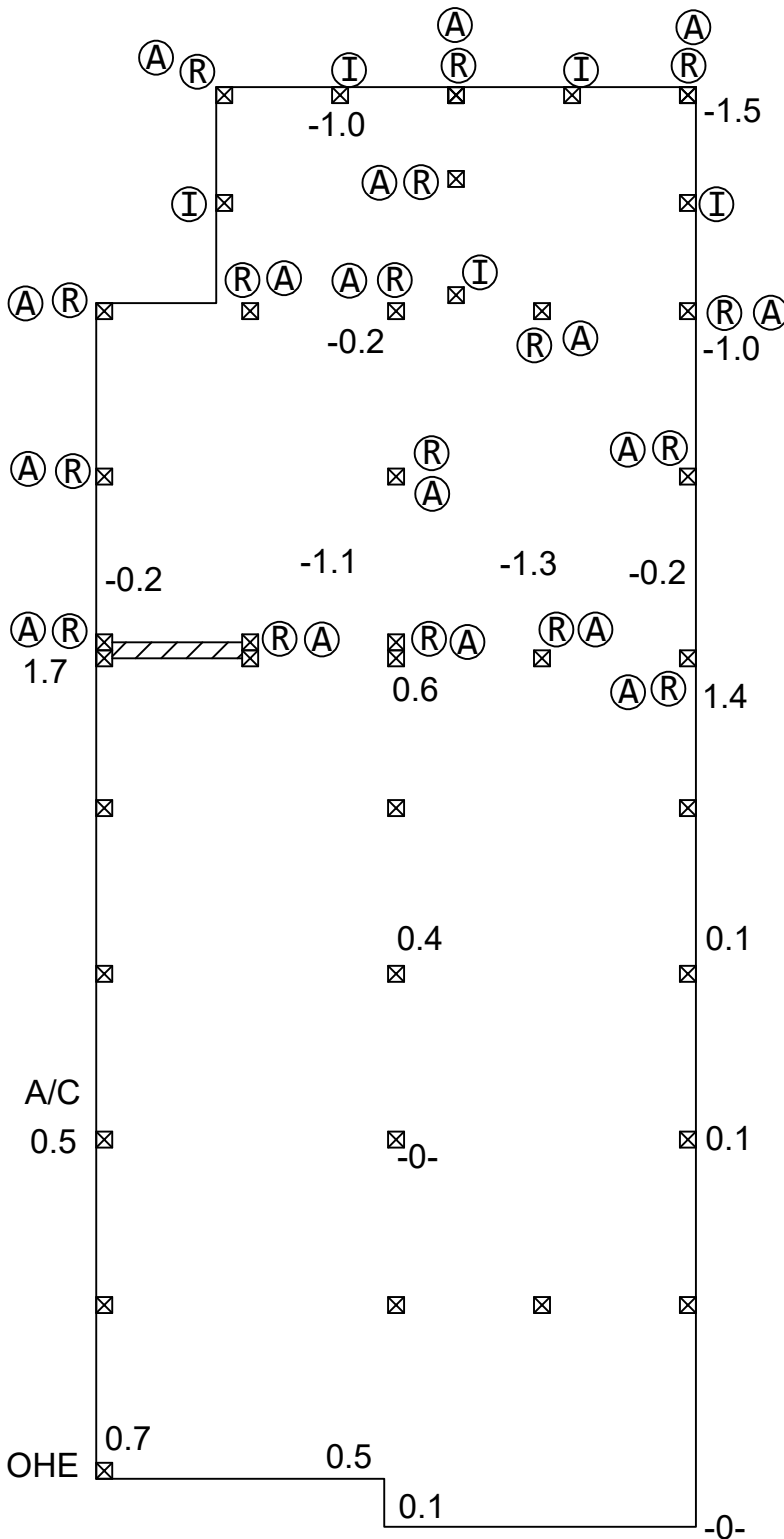

Any changes to or deviations from approved plans must be immediately reported to the Department of Safety and Permits and work must stop until the revised plans have been examined and approved.

Work beyond that which is specified on these approved drawings is not authorized. Performing work beyond the scope of these plans is subject to fines as prescribed in Section 102.2 of the New Orleans Amendments to the International Building Code and/or revocation of the building permit.

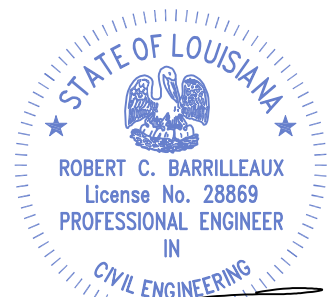
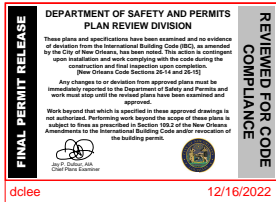

Robert C. Barrilleaux
11/22/22

Notes:

- 1) Home has a wood framed foundation and has experienced settlement. Home is to be leveled by adjusting piers as shown. Home will undergo and approximately 1.5" lift to bring home back to level.
- 2) Piers shall be adjusted by addition of 3000 psi precast concrete or steel shims with non-shrink grout around them.
- 3) Measurements for basis of design provided by Davie Shoring, including elevations, sill/pier location, and house measurements. If pier location or other features are different than plan, engineer is to be contacted to modify design as needed.
- 4) Shoring is planned to be completed with:

- Replace Piers: 17
- Adjust Piers: 17
- Install Piers: 5
- Poured Concrete pad: 22
- Install Sill: 25 LF

Pier Placement Shoring Plan
Lift Company: Davie Shoring, Inc.

4322 Rayne Drive
New Orleans, LA



Date: 11/22/2022 Scale: 1" = 8'
Drawn by: JQ Revised:

Existing Joist

Existing Sill

2 - Hurricane Strap
14" x 1-1/4" min.

Termite Shield

2-#5 rebar and blocks
filled with 3000# concrete

Rebar set at least 4"
into new footing to then
"L" at least 6" as shown.
If precast footings are
used, rebar shall be pin
connected to footing

Poured concrete footing
to be min. 24"x24"x8"
with rebar

Existing piers, if present, shall
be sawcut below grade so that
they extend no more than 2"
into bottom of new footing.

Note: Piers shall "L" at all
corners and "T" at all sill
intersections.
If any piers are over 4' in height,
they shall be double stacked &
alternating direction.

FINAL PERMIT RELEASE

DEPARTMENT OF SAFETY AND PERMITS
PLAN REVIEW DIVISION

These plans and specifications have been examined and no evidence of deviation from the International Building Code (IBC), as amended by the City of New Orleans, has been noted. This approval is contingent upon construction and work complying with the code during the construction and final inspection only.

Any changes to or deviation from approved plans must be immediately reported to the Department of Safety and Permits and work must stop until the revised plans have been reviewed and approved.

Work beyond that which is specified in these approved drawings is not authorized. Performing work beyond the scope of these plans is subject to those as prescribed in Section 102.2 of the New Orleans Amendments to the International Building Code under jurisdiction of the building permit.

By: R. Barrilleaux, PE
Chief Plan Examiner

REVIEWED FOR CODE COMPLIANCE

dclee 12/16/2022

Typical Detail for Support of
Wood Frame House on Footing
Lift Company: Davie Shoring, Inc.

4322 Rayne Drive
New Orleans, LA



Engineers - Land Surveyors - Environmental Consultants
ph: (985)-542-0391 fax: (985)-542-6515
42333 Deluxe Plaza Suite 8 Hammond, LA
Engineer - Robert C. Barrilleaux, PE # 28869

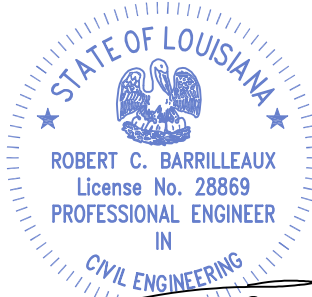

Robert C. Barrilleaux
11/22/22

Date: 11/22/2022 Scale: 1" = 4'

Drawn by: TB Revised: N/A