

WIND BORNE DEBRIS PROTECTION

WINDOWS IN BUILDING LOCATED IN WIND BORNE DEBRIS REGIONS SHALL HAVE GLAZED OPENINGS PROTECTED FROM WIND BORNE DEBRIS. WOOD STRUCTURAL PANELS WITH A MIN. THICKNESS OF 1/2" AND A MAX. SPAN OF 8 FEET SHALL BE PERMITTED FOR OPENING PROTECTION IN ONE AND TWO STORY BUILDINGS. PANELS SHALL BE PRECUT TO COVER THE GLAZED OPENINGS WITH ATTACHMENT HARDWARE PROVIDED.

CODE COMPLIANCE:

WIND SPEED 130 MPH.

1. THE 2015 INTERNATIONAL RESIDENTIAL CODE.
2. WOOD FRAME CONSTRUCTION MANUAL FOR ONE AND TWO FAMILY DWELLINGS. (WFCM).
3. INTERNATIONAL CODE COUNCIL (ICC) STANDARD FOR RESIDENTIAL CONSTRUCTION IN HIGH WIND REGIONS (ICC600).

JAHNCKE ROAD OR CANAL

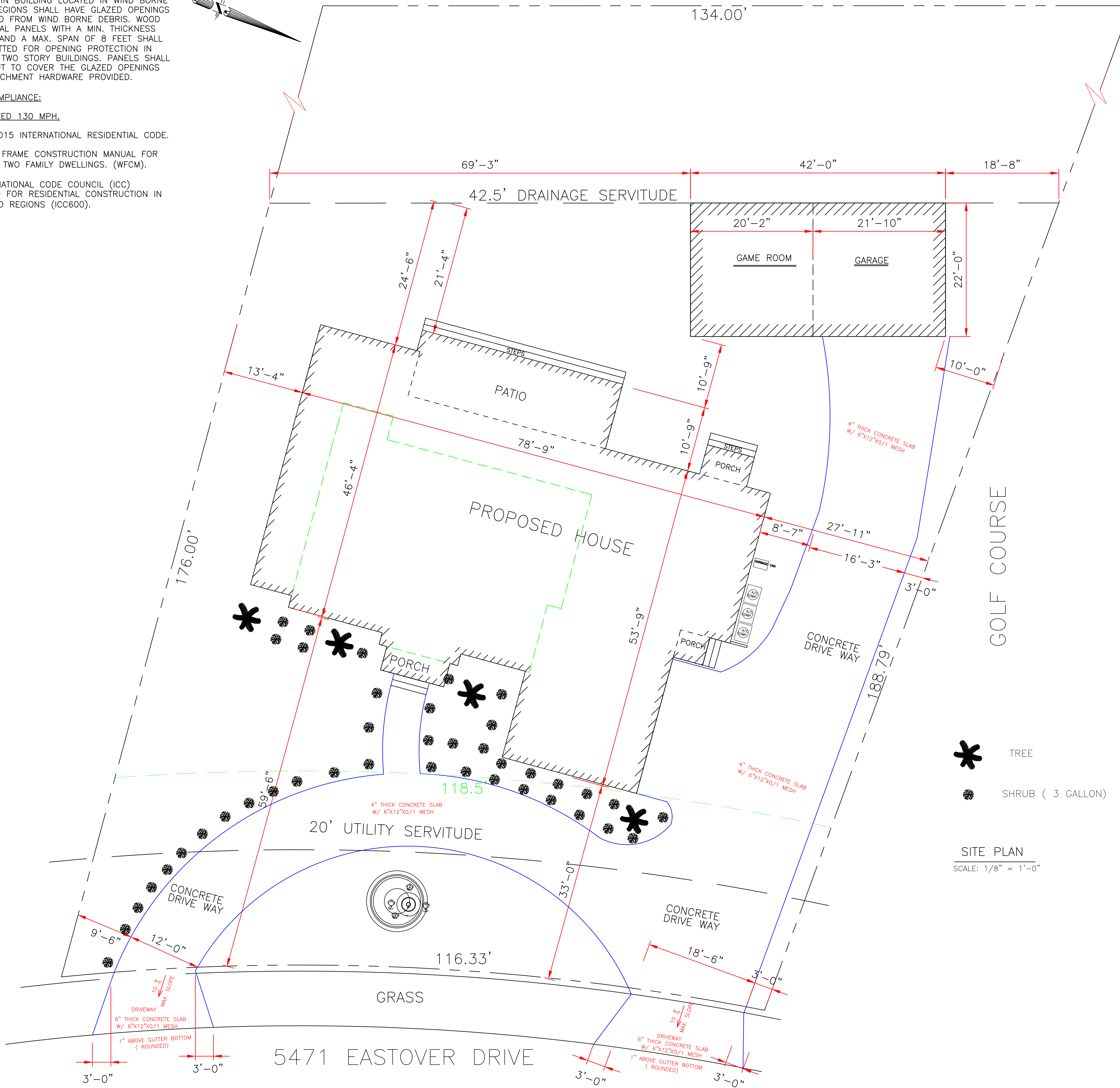

SQUARE FOOTAGE	
1ST LIVING	2904
2ND LIVING	738
ATTIC	425
PDRCHES	95
PATIO	363
GARAGE	527
TOTAL	5052

- TREE
- SHRUB (3 GALLON)

SITE PLAN
SCALE: 1/8" = 1'-0"

THESE PLANS HAVE BEEN PROPERLY EXAMINED BY THE UNDERSIGNED. I HAVE DETERMINED THAT THEY COMPLY WITH THE FOLLOWING EXISTING STATE AND LOCAL BUILDING CODES FOR THE JURISDICTION IN WHICH THE RESIDENCE IS TO BE LOCATED.

	LARRY TRUMBATURU	ROBERT DEANY 5471 EASTOVER DRIVE ORLEANS PARISH, LA	
	8307 LAFITTE CT. CHALMETTE, LA 70043	DATE 08/02/22	SHEET NO.
	504-1279-3508	REV 09/30/22	1 OF 12