



# Orleans Parish, LA

## Summary

Tax Bill Number	614344410
Municipal District	6
Location Address	4303 S ROMAN ST
Property Class	R - RESIDENTIAL
Special Tax District	6-BRDM
	<a href="#">Show Special Tax District Map</a>
Subdivision Name	
Zoning District	<a href="#">Show Viewer (41048566)</a>
Land Area (sq ft)	5206
Building Area (sq ft)	3470
Revised Bldg Area (sq ft)	0
Square	720
Book	05
Lot/Folio	A/047
Line	010
Legal Description	1. SQ 720 LOT A S ROMAN & 2. GEN PERSHING 38X137 S-RAISED-W
Assessment Area	SOUTH BROADMOOR
	<a href="#">Show Assessment Area Map</a>
Parcel Map	<a href="#">Show Parcel Map</a>



## Owners

[HARRIS GWENDOLYN](#)  
4302 S ROMAN ST  
NEW ORLEANS LA 70125 0000

## Notices

[2023 Assessment Notice \(PDF\)](#)

## Quick Links

[Estimate Taxes](#)

[Tax Information](#)

## Valuation

	2023 Uncertified	2022 Certified	2021 Certified
Land Value	\$41,600	\$41,600	\$41,600
+ Building Value	\$236,700	\$224,900	\$236,700
= Total Value	<b>\$278,300</b>	<b>\$266,500</b>	<b>\$278,300</b>
Assessed Land Value	\$4,160	\$4,160	\$4,160
+ Assessed Building Value	\$23,670	\$22,490	\$23,670
= Total Assessed Value	<b>\$27,830</b>	<b>\$26,650</b>	<b>\$27,830</b>
- Homestead Exemption Value	\$0	\$0	\$0
= Taxable Assessment	<b>\$27,830</b>	<b>\$26,650</b>	<b>\$27,830</b>

---

**Special Assessment Treatment**

---

Age Freeze

---

Disability Freeze

---

Assessment Change

---

Tax Contract

---

**Sales**

Sale/Transfer Date	Price	Grantor	Grantee	Notarial Archive Number	Instrument Number
5/24/2021	\$0	ALLEN GARY	HARRIS GWENDOLYN	202153525	704213
7/7/2017	\$0	ALLEN NORMAN	THE ESTATE OF NORMAN ALLEN	201732042	624087
10/31/2011	\$4,670	ALLEN NORMAN	ALLEN NORMAN	201142486	0
5/11/2008	\$0	THE ESTATE OF NORMAN ALLEN	ALLEN GARY	201823454	640045

**Photos****Sketches**

	Room Type	Area
	A	1539
	B	474
	C	243
	D	42
	E	38

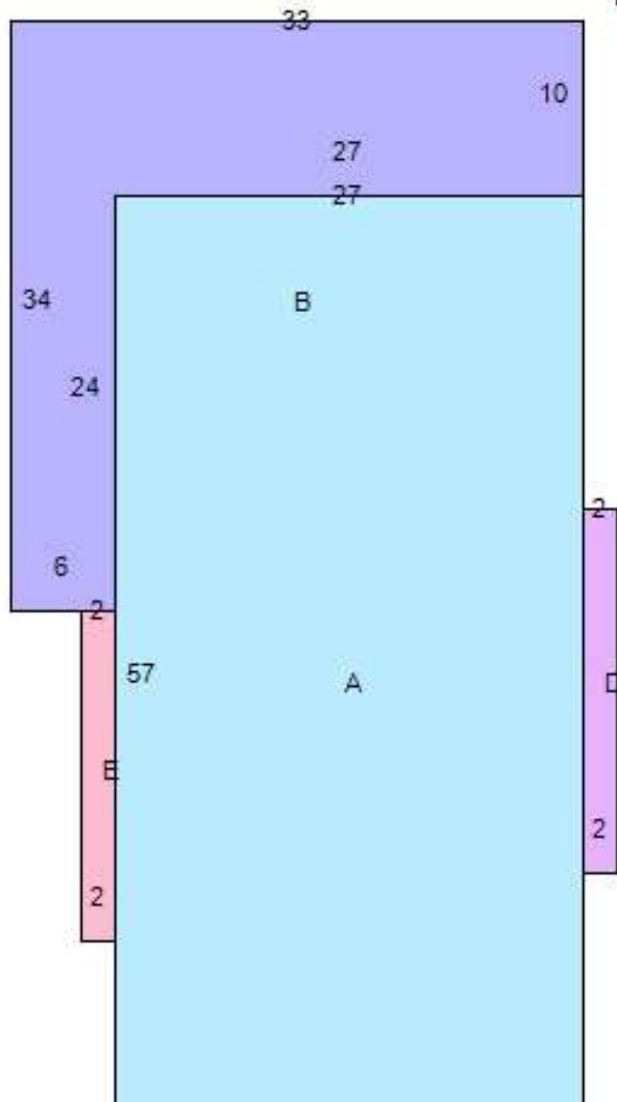

	27	
	27	
9	C	9
	27	

**No data available for the following modules:** Change Orders.

The Orleans Parish Assessor's Office makes every effort to produce the most accurate information possible. No warranties, expressed or implied, are provided for the data herein, its use or interpretation.

[User Privacy Policy](#)  
[GDPR Privacy Notice](#)

[Last Data Upload: 10/24/2022, 6:36:44 AM](#)

Developed by  
 Schneider  
GEOSPATIAL

Version 2.3.226