

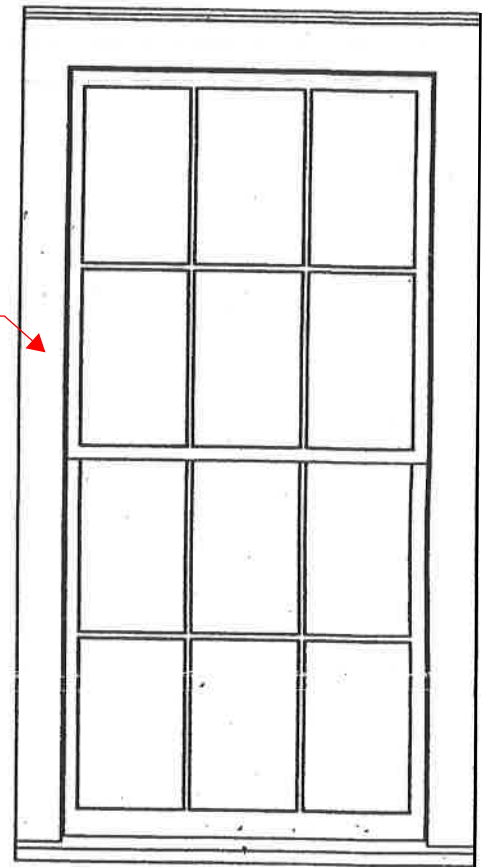

WINDOW DETAIL

WINDOWS MUST BE RECESS MOUNTED INTO THE OPENING

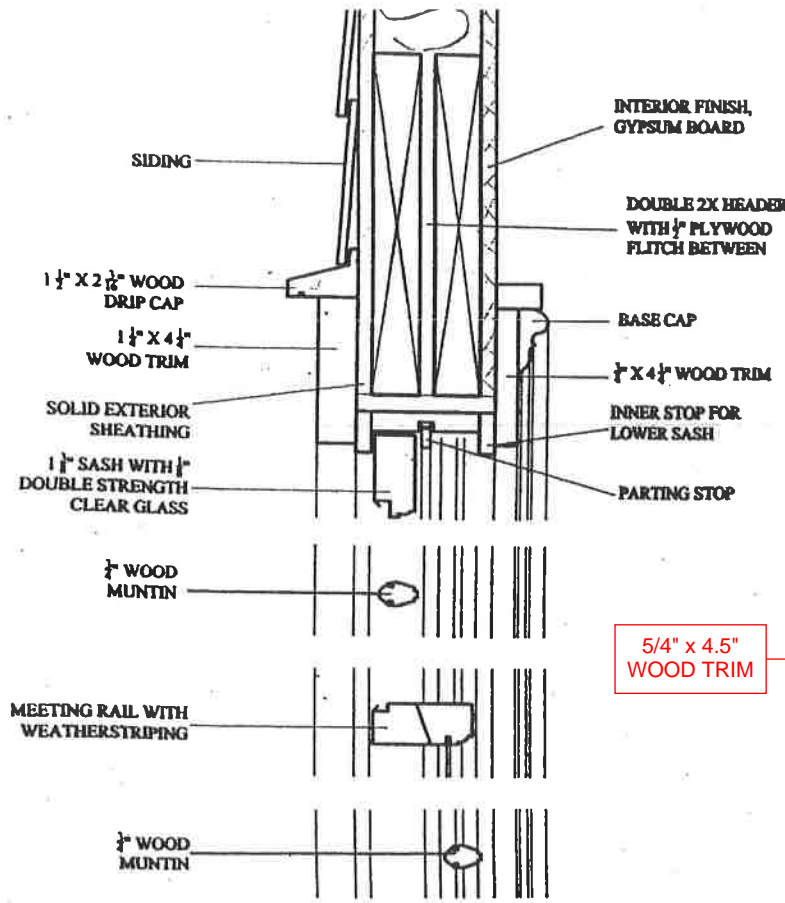

EXTERIOR ELEVATION
1 1/2" = 1'

FACE OF SILL SHOULD BE PARALLEL TO WALL

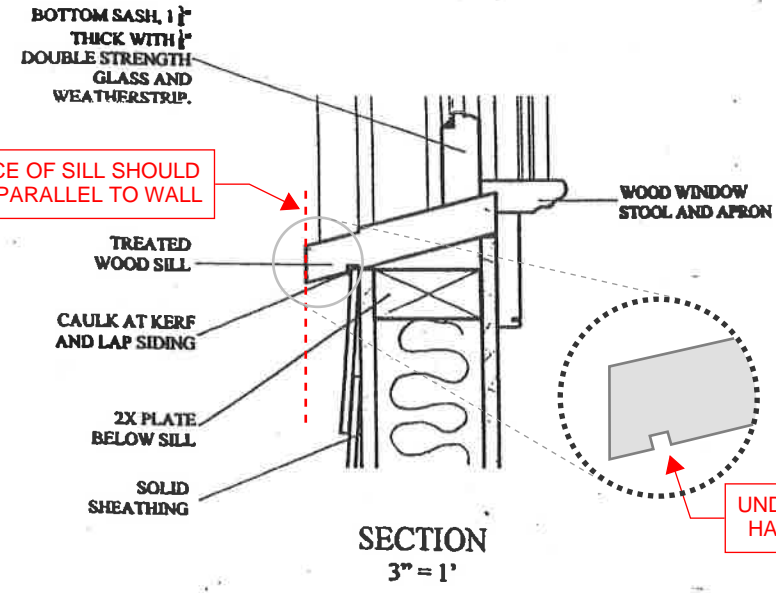

UNDERSIDE OF SILL SHOULD HAVE A ROUTED DRIP LINE

SECTION
3" = 1'

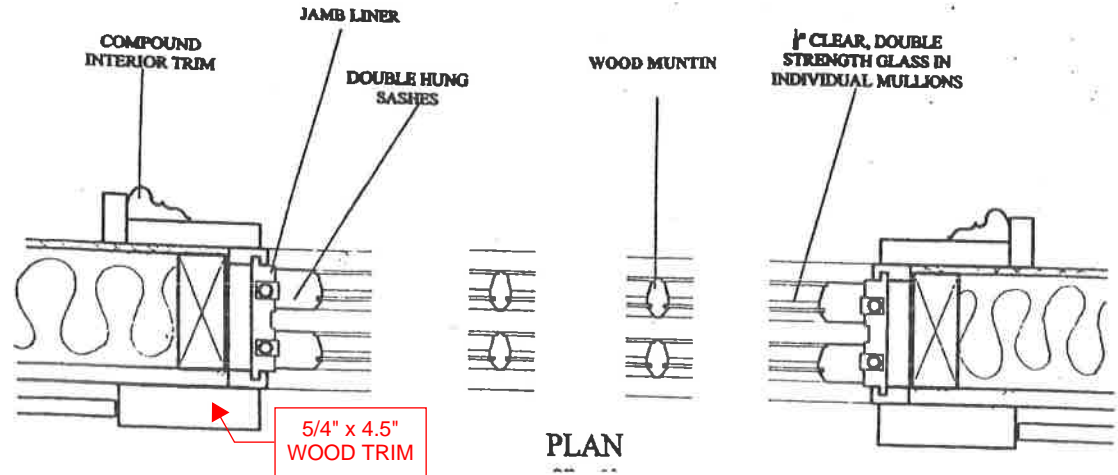

PLAN

Replace existing windows at side elevations with new wood windows to match existing in size. All new windows to be recess-mounted with clear, non-tinted and non-textured glass.



LINE ITEM QUOTES

The following is a schedule of the windows and doors for this project. For additional unit details, please see Line Item Quotes. Additional charges, tax or Terms and Conditions may apply. Detail pricing is per unit.

Line #1	Mark Unit:	Net Price:		1,530.91
Qty: 6		Ext. Net Price:	USD	9,185.46

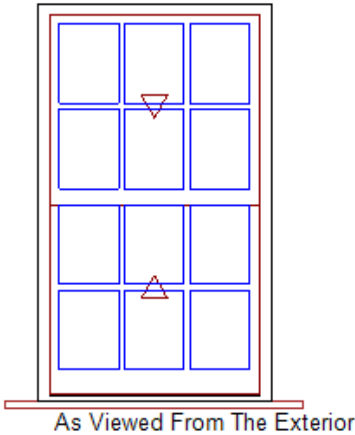

Entered As: FS
MO 36" X 60 1/4"
FS 35 1/2" X 60"
RO 36 1/2" X 60 1/2"
Egress Information
 Width: 31 15/16" Height: 23 3/4"
 Net Clear Opening: 5.27 SqFt
Performance Information
 U-Factor: 0.29
 Solar Heat Gain Coefficient: 0.26
 Visible Light Transmittance: 0.45
 Condensation Resistance: 57
 CPD Number: MAR-N-68-05573-00001
 ENERGY STAR: NC

Primed Pine Exterior
 Primed Pine Interior
 Back Prime
 Ultimate Wood Double Hung
 Frame Size w/ Subsill
 35 1/2" X 60"
 Rough Opening w/ Subsill
 36 1/2" X 60 1/2"
 Top Sash
 Primed Pine Sash Exterior
 Primed Pine Sash Interior
 IG
 Low E2 w/Argon
 Black Perimeter and Spacer Bar
 7/8" SDL - With Spacer Bar - Black
 Rectangular - Special Cut 3W2H
 Primed Pine Ext - Primed Pine Int
 Ovolo Exterior Glazing Profile
 Ovolo Interior Glazing Profile
 Bottom Sash
 Primed Pine Sash Exterior
 Primed Pine Sash Interior
 IG
 Low E2 w/Argon
 Black Perimeter and Spacer Bar
 7/8" SDL - With Spacer Bar - Black
 Rectangular - Special Cut 3W2H
 Primed Pine Ext - Primed Pine Int
 Ovolo Exterior Glazing Profile
 Ovolo Interior Glazing Profile
 White Sash Lock
 White Jamb Hardware
 Extruded Aluminum Screen
 Stone White Surround
 Bright View Mesh
 ***Screen/Combo Ship Loose
 6 9/16" Jambs
 Exterior Casing - None
 Primed Pine Standard Subsill
 Non Finger-Jointed Subsill
 5" Long Sill Horns
 Non Finger-Jointed Sill
 No Installation Method
 ***Note: Screen/Combo/Storm OSM based on factory applied casing and subsill.
 Field application may require special sizing.
 ***Note: Unit Availability and Price is Subject to Change

Line #2	Mark Unit:	Net Price:		1,465.04
Qty: 1		Ext. Net Price:	USD	1,465.04



Primed Pine Exterior
 Primed Pine Interior
 Back Prime
 Ultimate Wood Double Hung
 Frame Size w/ Subsill
 35 1/2" X 54"
 Rough Opening w/ Subsill
 36 1/2" X 54 1/2"
 Top Sash

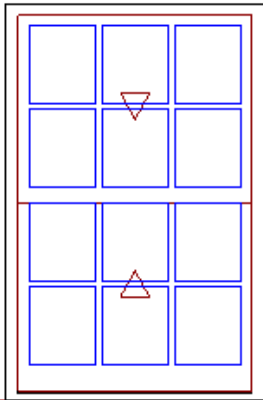

As Viewed From The Exterior

Entered As: FS

MO 36" X 54 1/4"

FS 35 1/2" X 54"

RO 36 1/2" X 54 1/2"

Egress Information

Width: 31 15/16" Height: 20 3/4"

Net Clear Opening: 4.60 SqFt

Performance Information

U-Factor: 0.29

Solar Heat Gain Coefficient: 0.26

Visible Light Transmittance: 0.45

Condensation Resistance: 57

CPD Number: MAR-N-68-05573-00001

ENERGY STAR: NC

- Primed Pine Sash Exterior
- Primed Pine Sash Interior
- IG
- Low E2 w/Argon
- Black Perimeter and Spacer Bar
- 7/8" SDL - With Spacer Bar - Black
- Rectangular - Special Cut 3W2H
- Primed Pine Ext - Primed Pine Int
- Ovolo Exterior Glazing Profile
- Ovolo Interior Glazing Profile
- Bottom Sash
- Primed Pine Sash Exterior
- Primed Pine Sash Interior
- IG
- Low E2 w/Argon
- Black Perimeter and Spacer Bar
- 7/8" SDL - With Spacer Bar - Black
- Rectangular - Special Cut 3W2H
- Primed Pine Ext - Primed Pine Int
- Ovolo Exterior Glazing Profile
- Ovolo Interior Glazing Profile
- White Sash Lock
- White Jamb Hardware
- Aluminum Screen
- Stone White Surround
- Bright View Mesh
- ***Screen/Combo Ship Loose
- 6 9/16" Jambs
- Exterior Casing - None
- Primed Pine Standard Subsill
- Non Finger-Jointed Subsill
- 5" Long Sill Horns
- Non Finger-Jointed Sill
- No Installation Method
- ***Note: Screen/Combo/Storm OSM based on factory applied casing and subsill.
- Field application may require special sizing.
- ***Note: Unit Availability and Price is Subject to Change

Project Subtotal Net Price: USD	10,650.50
9.450% Sales Tax: USD	1,006.47
Project Total Net Price: USD	11,656.97