

NOTE :- "ALL BOS COMPONENTS SHALL BE INSTALLED WITHIN 10 FT OF ADJACENT COMPONENTS"

ROOF SECTION(S):

- ① PITCH - 34  
AZIMUTH - 222  
MATERIAL - COMP. SHINGLE
- ② PITCH - 23  
AZIMUTH - 222  
MATERIAL - COMP. SHINGLE
- ③ PITCH - 23  
AZIMUTH - 42  
MATERIAL - COMP. SHINGLE
- ④ PITCH - 23  
AZIMUTH - 42  
MATERIAL - COMP. SHINGLE

# LEGEND

- METER
- INVERTER
- AC DISCONNECT
- MAIN SERVICE PANEL
- JUNCTION BOX
- OBSTRUCTION
- DRIVEWAY
- SOLAR MODULE
- STRING #1  
12 MODULE
- STRING #2  
12 MODULE
- STRING #3  
12 MODULE
- FIRE CODE OFFSET

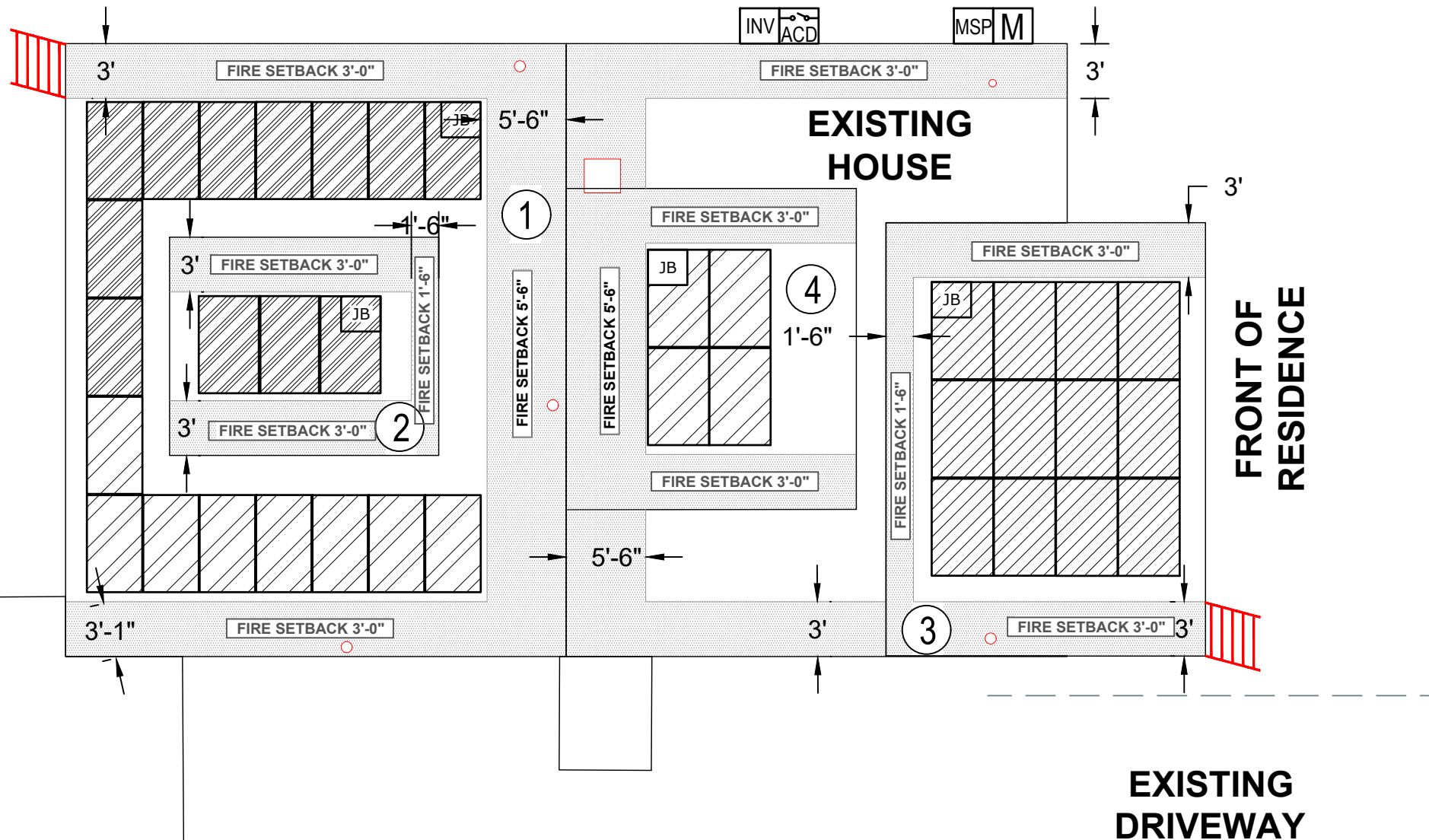

**S CLAIBORNE AVE**

**FRONT OF RESIDENCE**

**EXISTING DRIVEWAY**



JOB NUMBER: P-004358

UTILITY: ENERGY

RACKING: GAF DECOTECH SOLAR

MODULES: (36) SOLARIA POWERXT-360R-PD

OPTIMIZER: (36) SOLAREEDGE P370 OPTIMIZER

INVERTER: (1) SOLAREEDGE SE10000H-US

OWNER:

ROSEMARY C PALMER,  
8232 S CLAIBORNE AVE,  
NEW ORLEANS, LA 70118

ACCOUNT NO.: 154022727

DESCRIPTION:

ROSEMARY C PALMER,  
RESIDENCE

12.96 kWDC ROOF SOLAR SYSTEM  
PRODUCTION: 14,580kWH



DESIGNED BY:

**ENERQUAL**

TECHNOLOGY PVT. LTD.

REV:

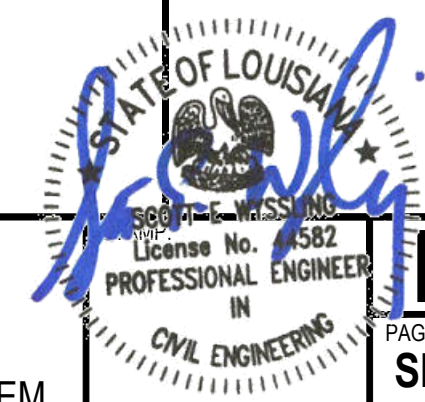

Signed 10/10/2022

**PV-2**

PAGE NAME:  
**SITE PLAN**

SCALE:  
1/8" = 1'

DATE:  
10/10/2022

**POSIGEN DEVELOPER, LLC**  
819 CENTRAL AVE STE 210  
JEFFERSON, LA 70121  
LA ELECTRICAL LICENSE :74446