

NOTES

- 1) ENGINEERED WD. PLANK BENCH, MATERIAL TO MATCH FLOOR DECKING;
- 2) 2x6 TREATED WD. BENCH LEG AND OUT-RIGER SEAT SUPPORTS;
- 3) 2x6 TRTD WD. JOIST LONG WIDTH OF PORCH; GALV. MET JOIST HANGERS AT RIBON JOIST AND DOUBLE JOIST STEP-BEAM; PROVIDE BRIDGING AT 1/3 POINTS.
- 4) PROVIDE CMU SUPPORT UNDER STEP-BEAM W/TREATED WD. SILL, AND TERMITE SHEILD. PROVIDE CONC. FILLED U BLOCK AT STEP BEAM, NOTCH CMU AS REQUIRED. (SEE DET. #2 THIS SHEET)
- 5) 6 X 8 X 16 CMU BLOCK KNEE WALL AT EDGE OF ENG. WD. DECK;
- 6) SINGLE PIER - 6 X 8 X 16 CMU WITH TREATED SILL, TERMITE SHEILD, AND 1/2 MET. ANCHOR BOLT TO FOOTING.
- 7) FOR INFORMATION, DETAILS AND SPECS RELATING TO STURCTUAL CONDITIONS REF. TO SHEETS S-1.0A - S-2.2

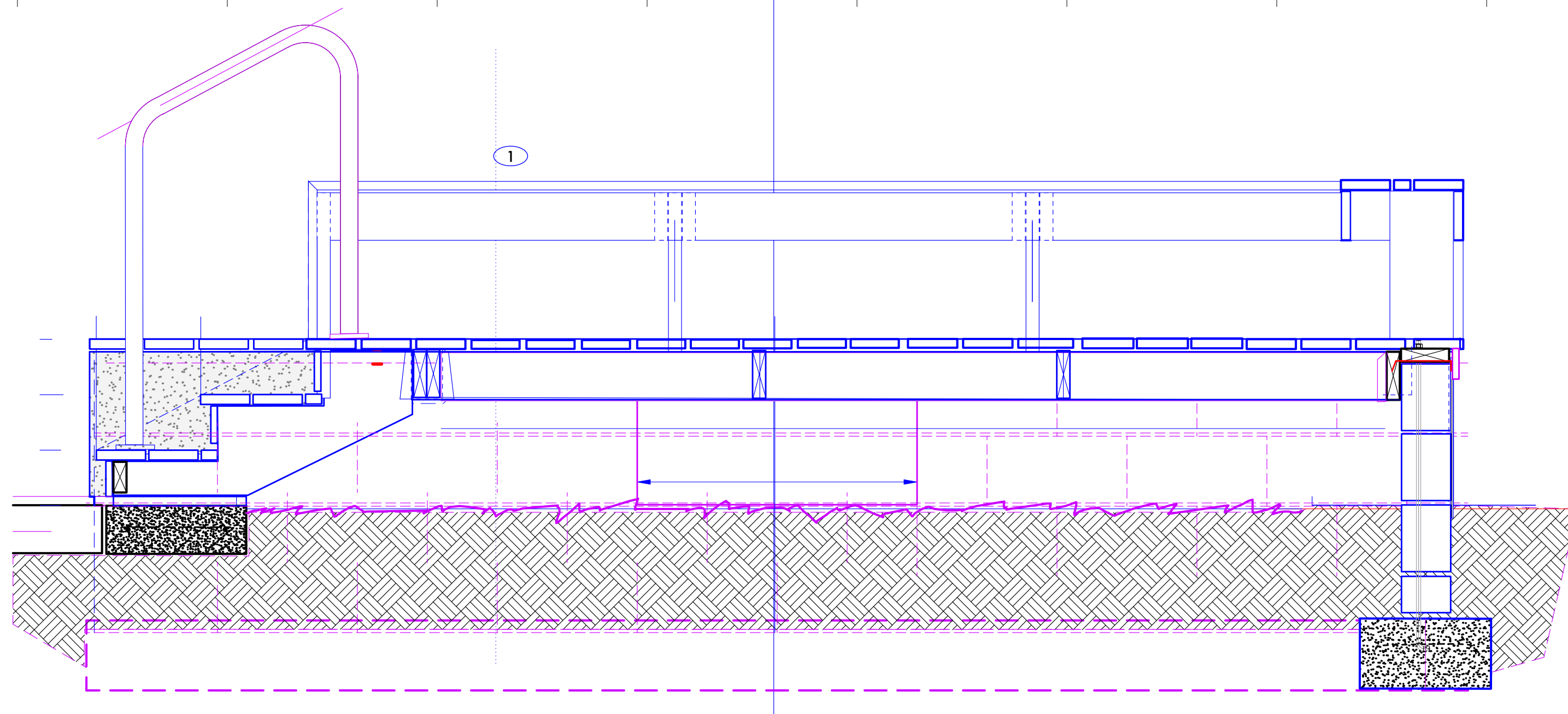

2. PORCH SECTION / HANDRAIL  
A-1.5 Scale: 1" = 1'-0"

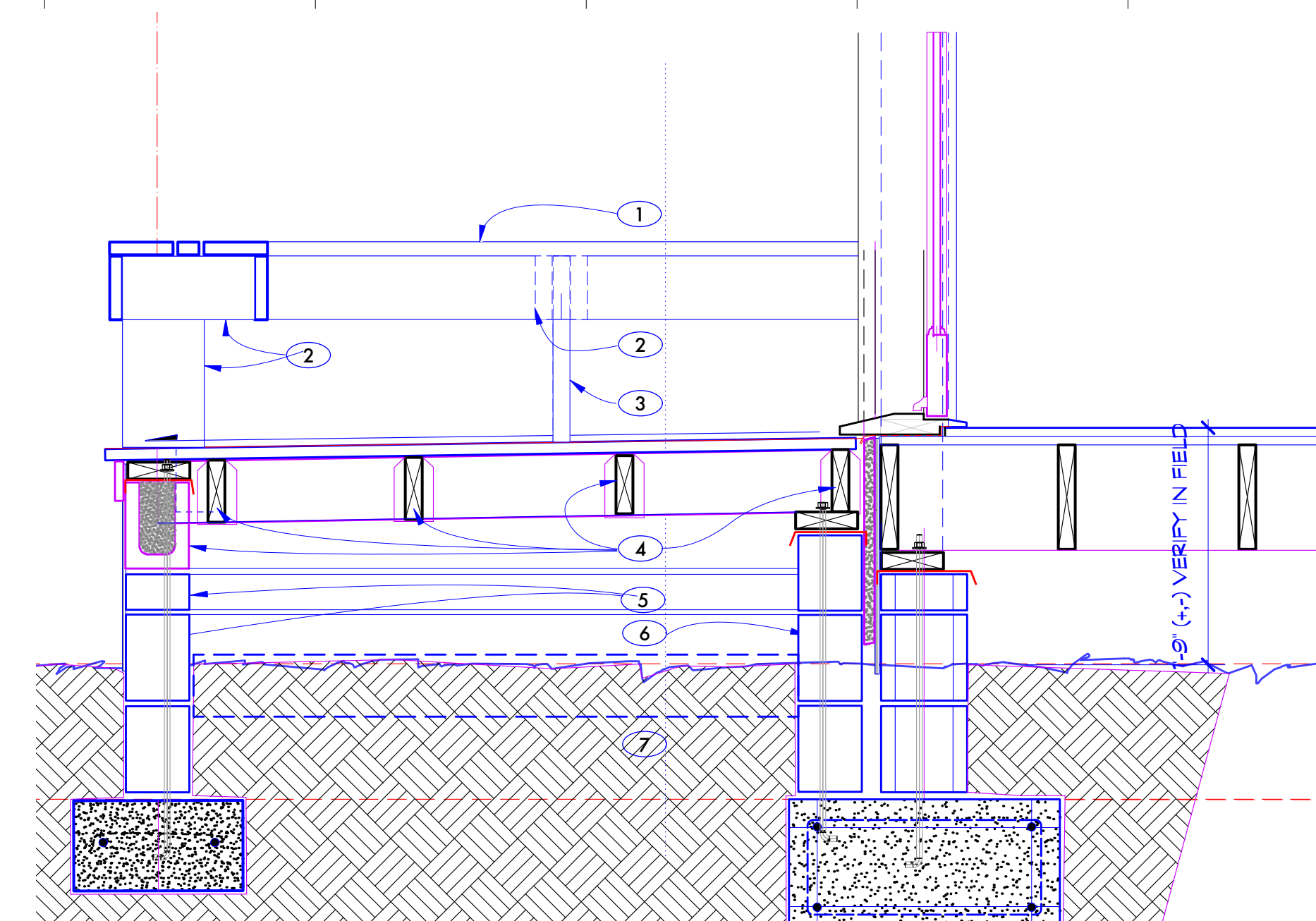

1. PORCH SECTION  
A-1.5 Scale: 1" = 1'-0"

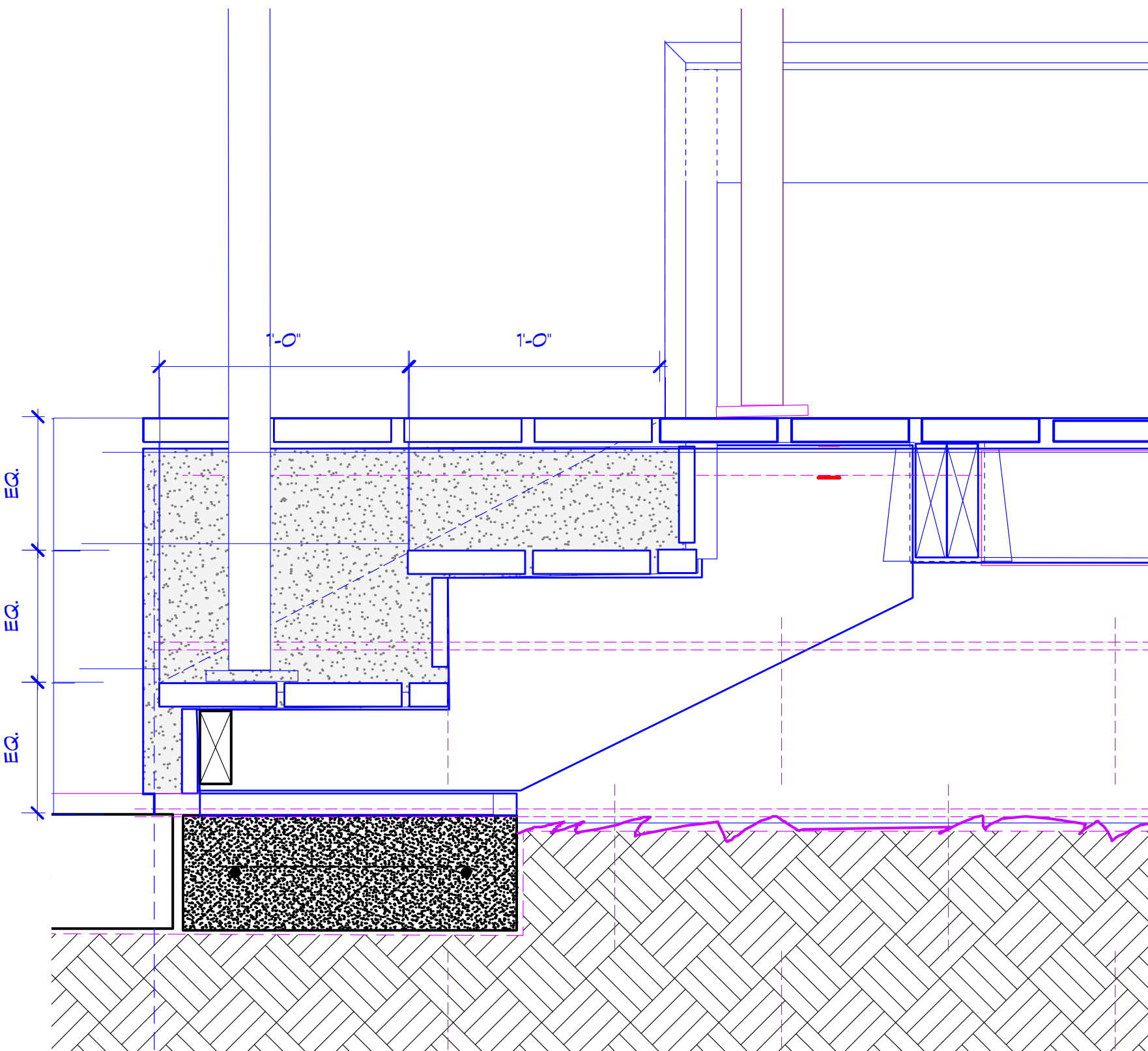

3. [Drawing Title]  
A-1.5 Scale: 2" = 1'-0"

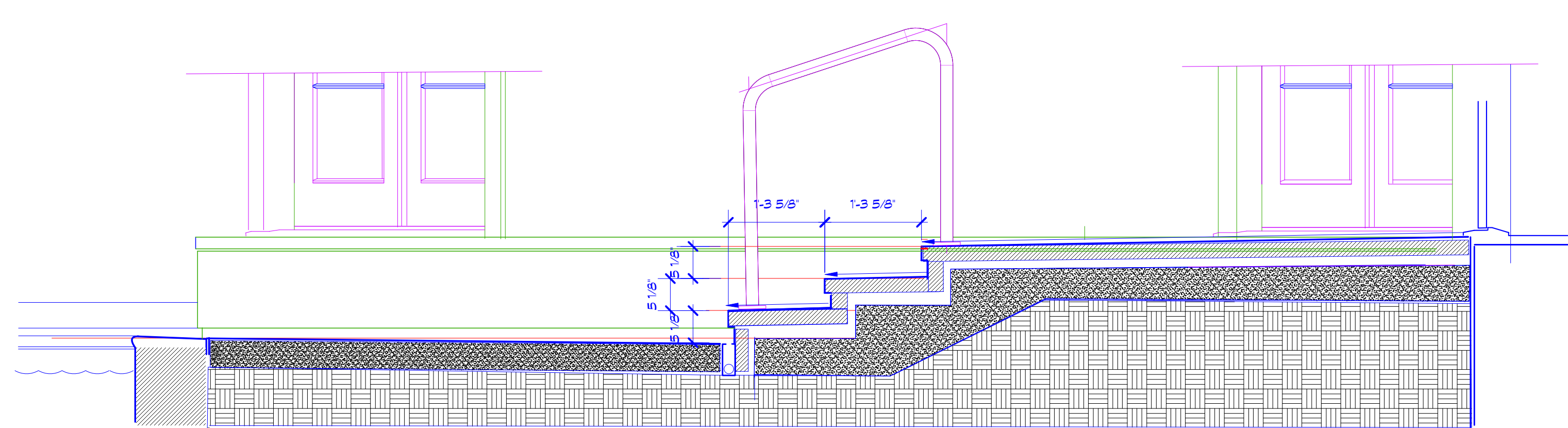

2. DET. SECT. STEPS @ TERRASE  
A-1.5 Scale: 3/4" = 1'-0"

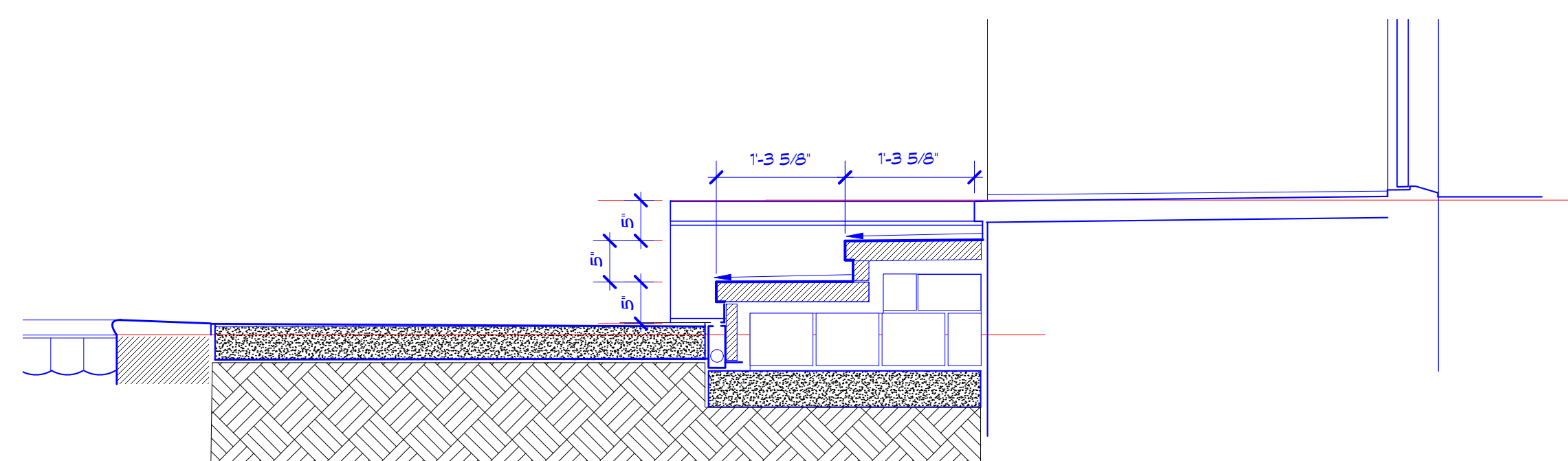

6. SECTION DET. @ Landing to Dining entry  
A-1.5 Scale: 3/4" = 1'-0"

Project Title:

RENOVATIONS  
&  
ADDITIONS TO  
22 VERSAILLES  
BLVD

New Orleans  
Louisiana

FOR  
MR. & MRS.  
PAIGE SENSENBRENER



Drawing Title:

PORCH SECT. /  
DETAILS

Date 10 / 10 / 22  
Drawn D.B.  
Revised

Drawing No.