

Shed placed

09-29
jstephenson
22
REPUBLIC DISTRICT LANDMARKS COMMISSION
REVIEWED

Shed installation must meet the standards set forth by the City of New Orleans Comprehensive Zoning Ordinance.

STATE OF LOUISIANA
RICHMOND W. KREBS
REG. NO. 4836
REGISTERED PROFESSIONAL LAND SURVEYOR

GENERAL NOTES
ANGLES AND/OR BEARINGS ARE BASED ON REFERENCE PLAN #1
REFERENCE PLAN #1: A PLAN OF SURVEY BY ERROL L. KELLY, SURVEYOR DATED AUGUST 7, 1983
THE SERVICES SHOWN ON THIS SURVEY ARE LIMITED TO THOSE FURNISHED ME AND THERE IS NO REPRESENTATION THAT ALL APPLICABLE SERVICES ARE REFLECTED OR SHOWN HEREON. THE SURVEYOR HAS MADE NO TITLE SEARCH OR PUBLIC RECORD SEARCH IN COMPLETING THE DATA FOR THIS SURVEY.
THIS PERMITTED SURVEY SHALL NOT CONSTITUTE A LEGAL OPINION OF TITLE, AND SHALL NOT BE RELIED UPON FOR THAT PURPOSE. THERE IS NO WARRANTY THAT IT CONFORMS TO THE LEGAL TITLE, AND WAS MADE SOLELY ACCORDING TO THE INFORMATION PROVIDED THE SURVEYOR.

ELEVATION NOTES
THIS IS CERTIFY THAT SUBJECT PROPERTY IS LOCATED IN THE FOLLOWING FLOOD ZONE, PER FLOOD INSURANCE RATE MAP (FIRM) DATED SEPTEMBER 30, 2016 FLOOD ZONE X
BASE FLOOD ELEVATION 8/9' CORRELITY PANEL: 225293 6227 F

R.W. KREBS
PROFESSIONAL LAND SURVEYING, LLC
RICHMOND W. KREBS, SR., PLS
8448 N. CAUSEWAY BLVD, SUITE 201
METairie, LA. 70003
PHONE: (504) 889-0818
FAX: (504) 889-0818
E-MAIL: info@rskrebs.com
WWW: www.rskrebs.com

MADE AT THE REQUEST OF ROBERT D. GRAYLEY
REFERRED TO CORRECT CALL TO CORNER JANUARY 31, 2022

DATE: NOVEMBER 1, 2021 DRAWN BY: JSM
SCALE: 1" = 20' CHECKED BY: NDK
JOB #: 212303

↑ 32" from fence
(no structure on adjoining lot)

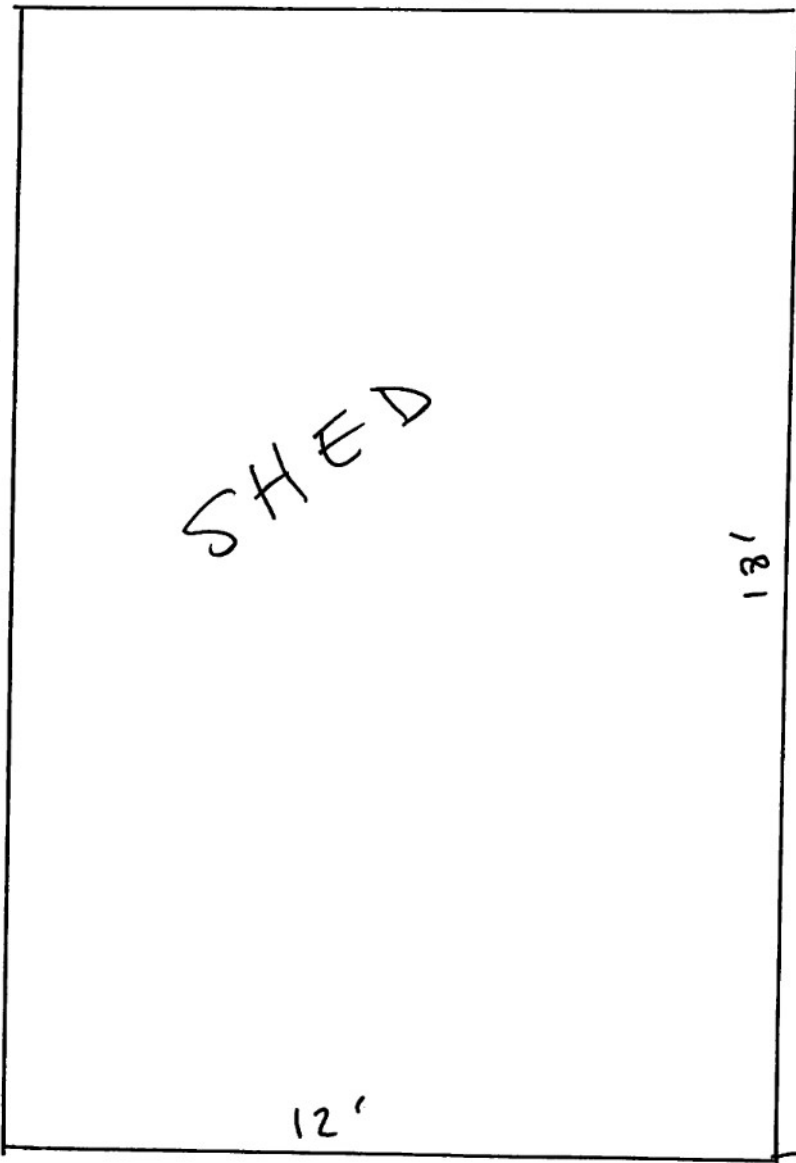

(no structure built adjoining lot)
↑ 5' from fence

sidewalk

House

