

**DEPARTMENT OF SAFETY & PERMITS  
CITY OF NEW ORLEANS**

PERMIT NO: \_\_\_\_\_ DATE: \_\_\_\_\_

ADDRESS: 518 FRENCH STREET. - 70124 SUBDIVISION: LAKEVIEW

DISTRICT: 2ND SQUARE: 284 LOTS: B

COMMUNITY NUMBER	PANEL NUMBER	SUFFIX	DATE OF FIRM INDEX	FIRM ZONE	BASE FLOOD ELEVATION (BFE)	FREEBOARD (ADD 1FT FOR A AND V ZONES) OFFICE USE ONLY
225 203	0113	F	9/30/16	X	N/A N.A.V.D	+1ft = _____

**MINIMUM FLOOR ELEVATION:** \_\_\_\_\_ N.A.V.D.  
\*\*\*\*\*  
**FOR V - ZONES ONLY:** \_\_\_\_\_ N.A.V.D.  
(ELEVATION OF BOTTOM OF LOWEST HORIZONTAL STRUCTURAL MEMBER)

IN ADDITION TO THE FEMA ELEVATIONS, THE FOLLOWING CONDITIONS MUST ALSO BE MET:

- A. TOP OF SLABS ON GRADE OR FILL MUST BE AT LEAST 36" ABOVE THE HIGHEST POINT OF CURB IN FRONT OF THE LOT OR SITE.
- B. PIER CONSTRUCTION: TOP OF PIERS (UNDERSIDE OF SILLS) MUST HAVE AT LEAST 18" CLEARANCE BENEATH THE STRUCTURE. IN ADDITION, THE LOWEST FLOOR MUST BE AT LEAST 36" ABOVE THE HIGHEST POINT OF CURB IN FRONT OF THE LOT OR SITE. (IF NO CURB, USE CENTERLINE OF STREET)
- C. ALL MECHANICAL OR PLUMBING EQUIPMENT SERVICING THE BUILDING MUST BE LOCATED AT OR ABOVE THE REQUIRED FLOOR ELEVATION.
- D. SLABS FOR ATTACHED GARAGES MUST BE AT THE REQUIRED FLOOR ELEVATION OR BE CONSTRUCTED OF WATER-RESISTANT MATERIALS WITH PROPER VENTING IN 2 WALLS.
- E. DETACHED GARAGES WITH PLUMBING MUST BE AT THE REQUIRED FLOOR ELEVATION.
- F. CONSTRUCTION BENCHMARK MUST BE SET AT REQUIRED MINIMUM FLOOR ELEVATION OR GREATER. (ADD 1 FOOT FOR A & V-ZONES)

APPROVED FOR CITY BY: \_\_\_\_\_

**1. CERTIFICATE OF CONSTRUCTION BENCHMARK**

EXISTING HIGHEST TOP OF CURB ELEVATION -7.4' N.A.V.D.  
EXISTING HIGHEST CENTERLINE OF STREET -7.1' N.A.V.D.

FOR PERMIT OFFICE USE ONLY	
ADD 3ft to curb, if no curb use the centerline of street	
_____	+ 3ft = _____

EXISTING LOT ELEVATIONS (PROPERTY CORNERS OR EDGE)  
FRONT (RIGHT) -5.9' N.A.V.D. FRONT (LEFT) -5.9' N.A.V.D.  
REAR (RIGHT) -5.5' N.A.V.D. REAR (LEFT) -5.5' N.A.V.D.  
OTHER: -3.5' N.A.V.D.

DESCRIBE: EXISTING FRONT DOOR  
DESCRIPTION OF CONSTRUCTION BENCHMARK: 60d NAIL IN POWER POLE BY LEFT PROPERTY LINE, NAIL ON WEST SIDE OF POLE.

ELEVATION OF CONSTRUCTION BENCHMARK: -4.4' N.A.V.D. (SEE NOTE F.)  
REFERENCE BENCHMARK USED TO ESTABLISH CONSTRUCTION BENCHMARK: ALCO  
ELEVATION OF REFERENCE BENCHMARK: 5.8' N.A.V.D.

SIGNATURE: \_\_\_\_\_ DATE: SEPTEMBER 19, 2022  
(LA. REGISTERED PROFESSIONAL LAND SURVEYOR OR CIVIL ENGINEER)

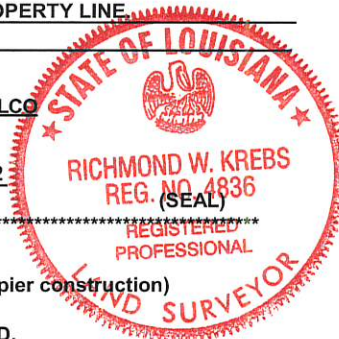

**2. CERTIFICATE OF TOP OF FORM OR TOP OF PIER ELEVATION**

(To be submitted before pouring concrete for slab construction or framing floor for pier construction)

AS BUILT ELEVATIONS: FORM \_\_\_\_\_ N.A.V.D. PIER \_\_\_\_\_ N.A.V.D.

**PIER CONSTRUCTION:**  
ALL FRAMING MATERIALS BELOW THE MINIMUM FLOOR ELEVATION (B.F.E.) MUST BE CONSTRUCTED WITH WATER-RESISTANT MATERIALS AND THE FIRST FLOOR MUST BE AT OR ABOVE THE MINIMUM FLOOR ELEVATION (B.F.E.).

**V ZONES ONLY:**  
BOTTOM OF LOWEST HORIZONTAL STRUCTURAL MEMBER \_\_\_\_\_ N.A.V.D.

(Must be submitted before framing begins)  
IN V ZONES, ALL ENCLOSURES BELOW THE B.F.E. MUST BE DESIGNED WITH BREAK-AWAY WALLS CONSTRUCTION.

SIGNATURE: \_\_\_\_\_ DATE: \_\_\_\_\_  
(LA. REGISTERED PROFESSIONAL LAND SURVEYOR OR CIVIL ENGINEER) (SEAL)

**3. FILLING, GRADING, DRAINAGE, SIDEWALK AND DRIVEWAY CERTIFICATION AND AFFIDAVIT**  
(To be submitted before Use & Occupancy Certificate can be issued)

THIS WILL CONFIRM THAT ALL FILLING, GRADING, DRAINAGE, SIDEWALKS AND DRIVEWAYS HAVE MET THE REQUIREMENTS OF THE APPLICABLE SECTIONS OF THE CODE OF THE CITY OF NEW ORLEANS.

OWNER: \_\_\_\_\_ DATE: \_\_\_\_\_

APPLICANT: \_\_\_\_\_ DATE: \_\_\_\_\_

(NOTARY)

OR  
IS LOT PROPERLY FILLED TO GRADE? YES NO

(minimum lot slope, rear to front, 1 inch every 20 feet)  
ARE SIDEWALKS PROPERLY INSTALLED? YES NO  
ARE DRIVEWAYS PROPERLY INSTALLED? YES NO  
ARE RETAINING WALLS REQUIRED? YES NO  
(if yes, then on which side(s)) RIGHT LEFT REAR  
ARE EQUIPMENT SLABS, SUCH AS A/C COMPRESSORS, AT MINIMUM FLOOR ELEVATION? YES NO  
DO ATTACHED GARAGES IN A-ZONES, THAT ARE BELOW MINIMUM FLOOR ELEVATION, HAVE PROPER VENTING AND WATERPROOFING? YES NO N/A

SIGNATURE: \_\_\_\_\_ DATE: \_\_\_\_\_  
(LA. REGISTERED PROFESSIONAL CIVIL ENGINEER) (SEAL)



