

SCREENING TO BE INSTALLED TO
MINIMIZE VISIBILITY

Ground Mounted Equipment

Ground mounted equipment, which includes air conditioner condensers, generators, back-flow preventers, ground-mounted solar collectors, trash dumpsters, satellite dishes and antenna, and mobile telecommunication equipment are all examples of modern mechanical equipment that can affect the historic integrity of a site and its surroundings.

Property owners are required to locate ground-mounted equipment in a rear yard, or when this is not possible, at a side yard to minimize visibility. In addition, the HDLC requires that all ground-mounted equipment that is visible from the public right of way be screened.

**SQ NO 420
ST. JOSEPH
SIXTH DISTRICT**

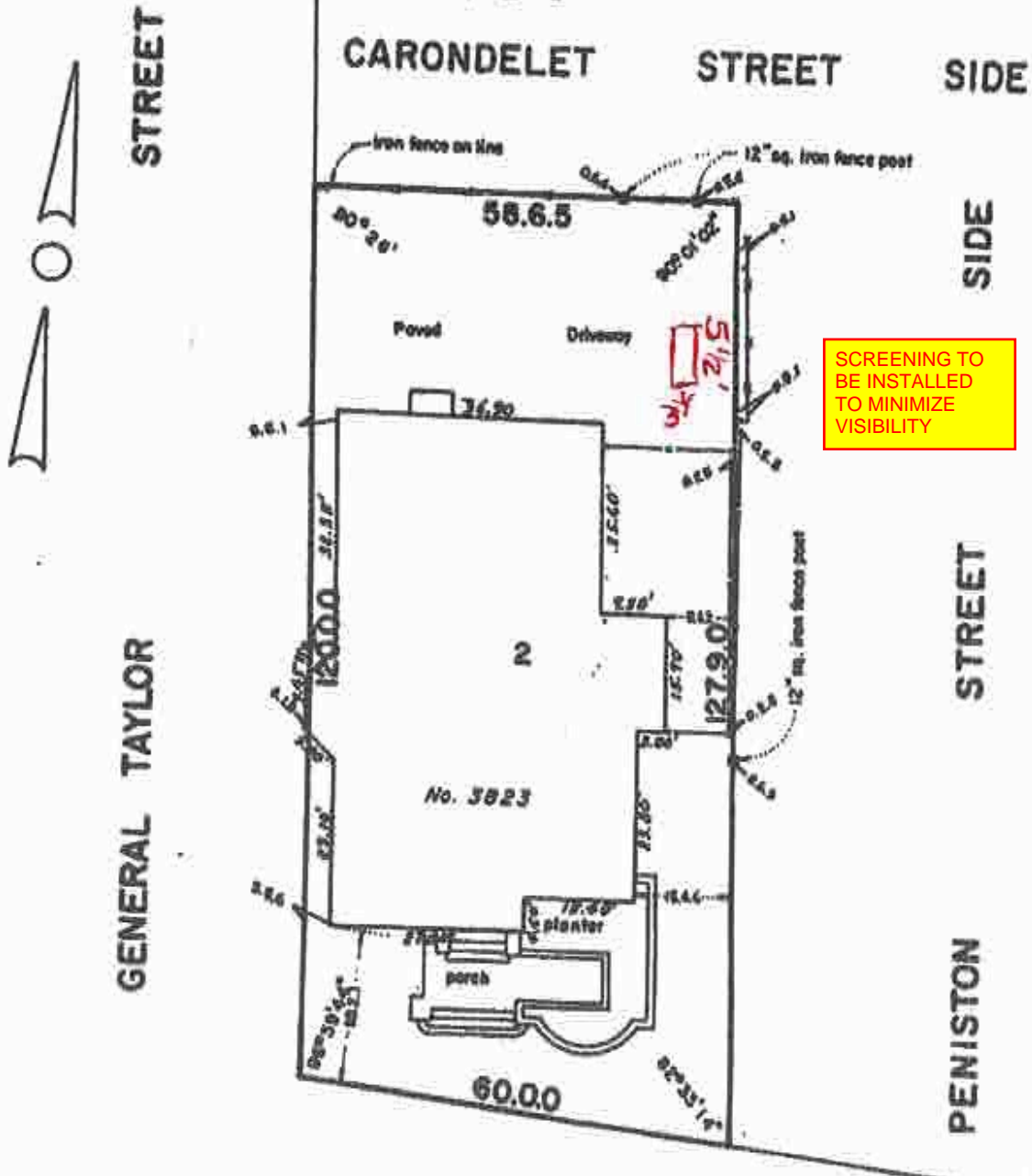

□ - Generator
5 1/2' From property line
3' From Gate

SCREENING TO BE INSTALLED TO MINIMIZE VISIBILITY

**ST. CHARLES AVENUE
EMLAH COURT CONDOMINIUM**

Survey for Emlah Court Condominium
New Orleans, July 27, 1992

Certified correct

John E. Walker
Civil Engineer

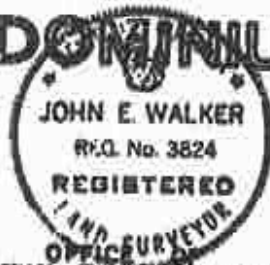

JOHN E. WALKER INC.

SCALE: 1" = 20'

NOTE: DIMENSIONS ARE IN FEET, INCHES & EIGHTHS

SHEET 1 OF 7