

**PLOT PLAN OF
LOTS 41 & 42
SQUARE 7
BEHRMAN HEIGHTS
FIFTH DISTRICT
ORLEANS PARISH, LA**

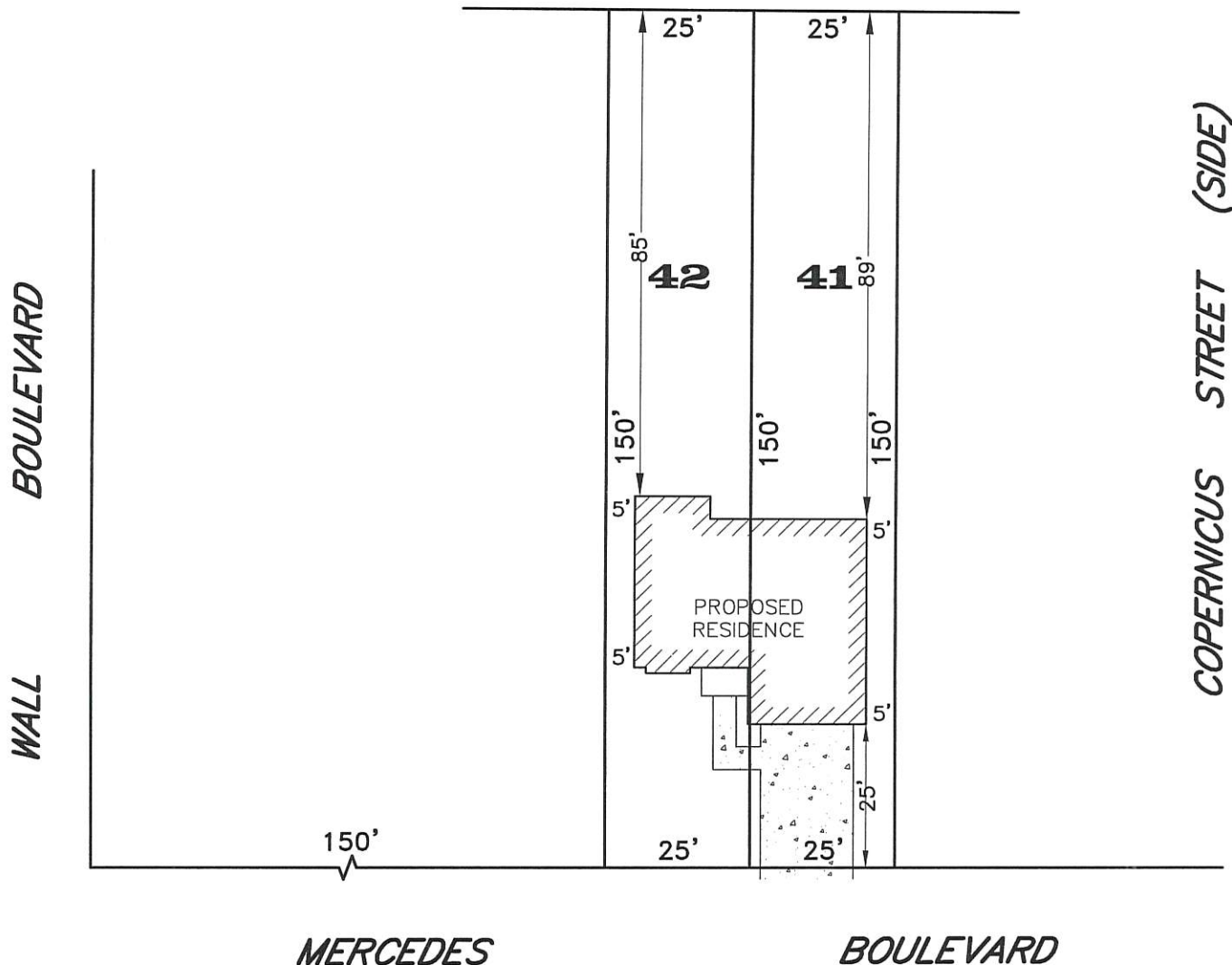

GEN. COLLINS AVENUE (SIDE)



NOTE:

ALL ANGLES ARE 90° UNLESS OTHERWISE NOTED. SOME ITEMS MAY NOT BE TO SCALE FOR CLARITY. DIMENSIONS ON SURVEY PREVAIL OVER THE SCALE. FENCES ARE SHOWN FOR GENERAL INFORMATION PURPOSES ONLY AND DO NOT REFLECT EXACT LOCATION OR CONDITION.



GENERAL NOTES

ANGLES AND/OR BEARINGS ARE BASED ON REFERENCE PLAN #1
REFERENCE PLAN #1: A PLAN OF SURVEY BY F. G. STEWART, SURVEYOR DATED JANUARY 29, 1962

THE SERVITUDES SHOWN ON THIS SURVEY ARE LIMITED TO THOSE FURNISHED US AND THERE IS NO REPRESENTATION THAT ALL APPLICABLE SERVITUDES ARE REFLECTED OR SHOWN HEREON. THE SURVEYOR HAS MADE NO TITLE SEARCH OR PUBLIC RECORD SEARCH IN COMPILING THE DATA FOR THIS SURVEY.

THIS PERIMETER SURVEY SHALL NOT CONSTITUTE A LEGAL OPINION OF TITLE, AND SHALL NOT BE RELIED UPON FOR THAT PURPOSE. THERE IS NO WARRANTY THAT IT CONFORMS TO THE LEGAL TITLE, AND WAS MADE SOLELY ACCORDING TO THE INFORMATION PROVIDED THE SURVEYOR.

ELEVATION NOTES

THIS IS CERTIFY THAT SUBJECT PROPERTY IS LOCATED IN THE FOLLOWING FLOOD ZONE, PER FLOOD INSURANCE RATE MAP (FIRM) DATED: SEPTEMBER 30, 2016 FLOOD ZONE: X
BASE FLOOD ELEVATION: N/A COMMUNITY PANEL: 225203 0242 F

R.W. KREBS
PROFESSIONAL LAND SURVEYING, LLC
RICHMOND W. KREBS, SR., PLS
3445 N. CAUSEWAY BLVD, SUITE 201
METAIRIE, LA. 70002
PHONE: (504) 889-9616
FAX: (504) 889-0916
E-MAIL: infonola@rwkrebs.com
WEB: www.rwkrebs.com

MADE AT THE REQUEST OF GEVONI BOLDEN

BY: 
RICHMOND W. KREBS, PLS, LIC. #4836

DATE: AUGUST 15, 2022	DRAWN BY: NDK
SCALE: 1" = 30'	CHECKED BY: RWK
JOB #: 221660	