

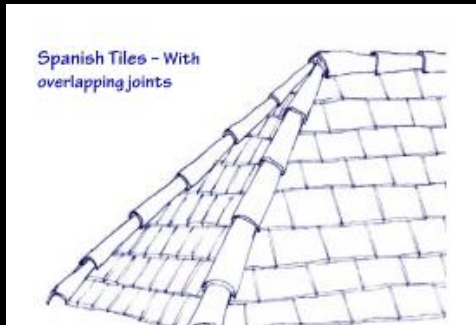

By the Way, Did You Know?



Existing ridge tiles should be salvaged and reinstalled!



The HDLC does NOT approve wind turbines. The HDLC does approve Chinese Cap and Low Profile Power Vents!

Atlas

- Atlas Stormmaster Shake
 - Black Shadow, Heathstone Grey, Pewter, Weathered Wood
- Atlas Pinnacle Pristine
 - Pristine Black, Pristine Hearthstone, Pristine Pewter, Pristine Weathered wood

Roof ventilation systems are generally located along or on the roof ridge and can greatly reduce the heat in an attic and home in the summer months.



Chinese Cap
Most appropriate for all buildings in Historic Districts



Turbine Ventilator
Not appropriate - Can only be installed as a replacement in-kind



Power Roof Vent
Approved only in less visible locations



Ridge Vent
Approved only where ridge tiles are not present

LOW-PROFILE ROOF VENTS MUST BE LOCATED AT LEAST 10'-0" BACK FROM THE FRONT WALL OF THE BUILDING (NOT THE FRONT OF THE ROOF) AT LEAST 1'-0" DOWN FROM THE ROOF RIDGE. SUBMIT PRODUCT SPECIFICATIONS FOR ANY VENT LARGER THAN 4" IN DIAMETER FOR APPROVAL BEFORE PURCHASE OR INSTALLATION.

Certainteed

- Certainteed – Landmark
 - Colonial Slate, Georgetown Grey, Max Def Georgian Grey, Max Def Maine Black, Moire Black, Weathered Wood
- Certainteed Landmark IR
 - Colonial Slate, Cumberland, Moire Black, Weathered Wood
- Certainteed Landmark Premium
 - Max Def Moire Black
- Certainteed Landmark Pro
 - Max Def Colonial Slate, Max Def Georgetown, Max Def Moire
- Certainteed Landmark TL
 - Max Def Colonial Slate, Max Def Moire Black, Max Def Old Overton
- Certainteed Grand Manor
 - Black Pearl, Colonial Slate, Gatehouse Slate, Stonegate Grey
- Certainteed Climateflex
 - Colonial Slate, Weathered Wood, Moire Black

BP

- Everest 42
 - Silver Grey, Fossil Wood, Twilight Grey, Brownstone, Driftwood
- Vanguard – Class IV
 - Twilight Grey, Shadow Black, Silver Grey



GAF – Timberline UHD

Slate, Pewter Gray, Charcoal, Weathered Wood

GAF- Timberline HDZ

Pewter Grey, Charcoal, Oyster Gray, Weathered wood

GAF – Timberline – NS

Charcoal, Weathered Wood, Slate, Pewter Grey

GAF – Timberline – AS II

Charcoal, Slate, Weathered Wood, Pewter Grey

GAF – CS

Antique Slate, Weathered Wood

IKO

Cambridge Collection

Dual Black, Dual Grey, Weathered Wood, Harvard Slate, Charcoal Grey

Cambridge Natural Cool

Dual Gray

Cambridge Cool Plus

Harvard Slate, Graphite Black

Dynasty

Castle Grey, Glacier, Granite Black

Malarkey

Legacy/Legacy Scotchguard/Highlander NEX AR/Vista AR

Midnight Black, Black Oak, Weathered Wood, Storm Grey

Owens Corning

Owens Corning – Oakridge

Driftwood, Estate Grey, Flagstone, Onyx Black, Peppermill, Twilight Black

Owens Corning –Duration

Driftwood, Estate Grey, Onyx Black, Quarry Grey

Owens Corning – Duration Flex

Estate Grey, Onyx Black, Driftwood,

Owens Corning – Berkshire Collection

Canterbury Black, Colonial, Concord, Manchester Grey

Tamko

Tamko Heritage Woodgate

Antique Wood, Weathered Wood, Black Sage

Tamko Titan

Rustic Black, Virginia Slate, Weathered Wood

Tamko Stormfighter

Weathered Wood, Rustic Black

Tamko Heritage

Antique Slate, Oxford Grey, Weathered Wood, Rustic Black, Shadow grey, Virginia Slate



WINDOW DETAIL

WINDOWS MUST BE RECESS MOUNTED INTO THE OPENING

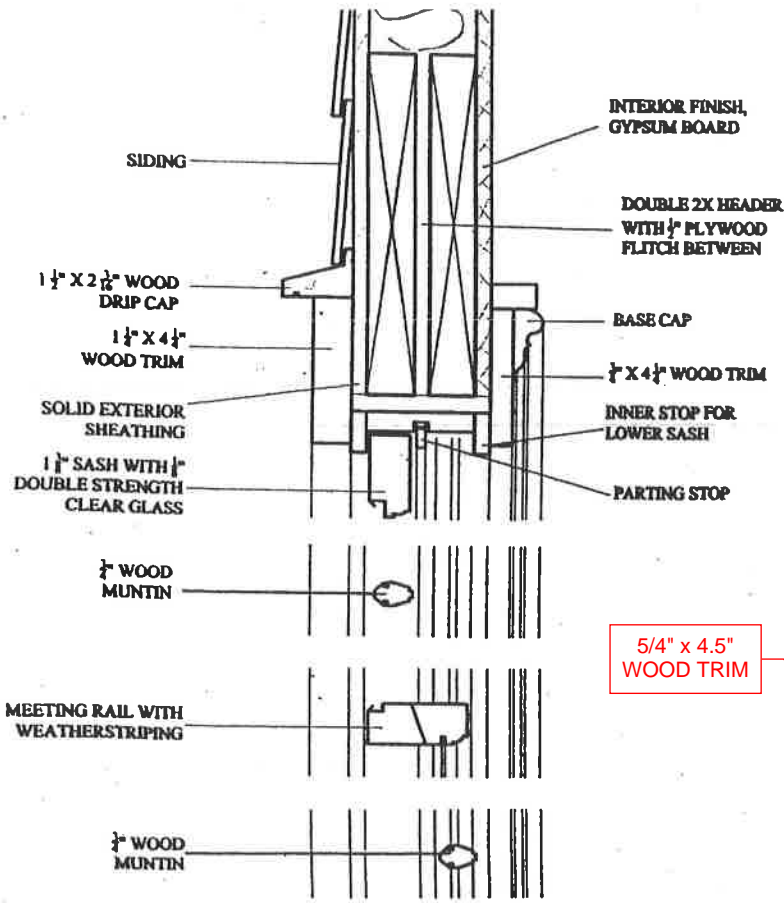

5/4" x 4.5" WOOD TRIM

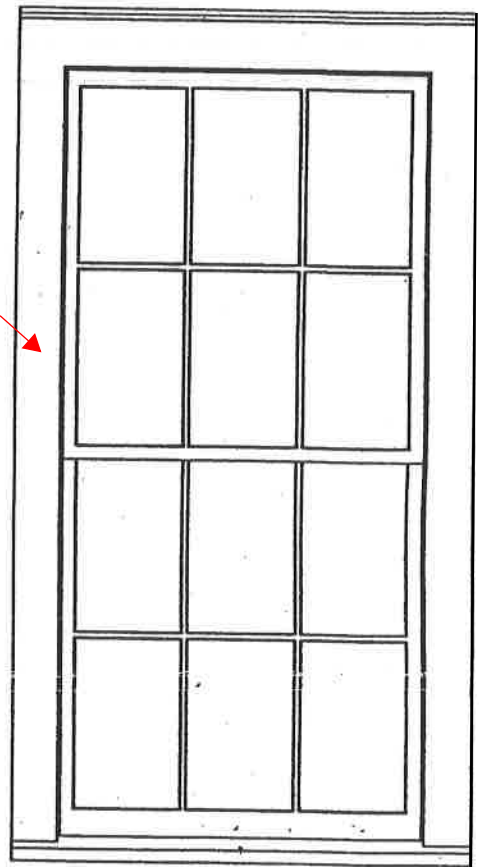

EXTERIOR ELEVATION
1 1/2" = 1'

FACE OF SILL SHOULD BE PARALLEL TO WALL

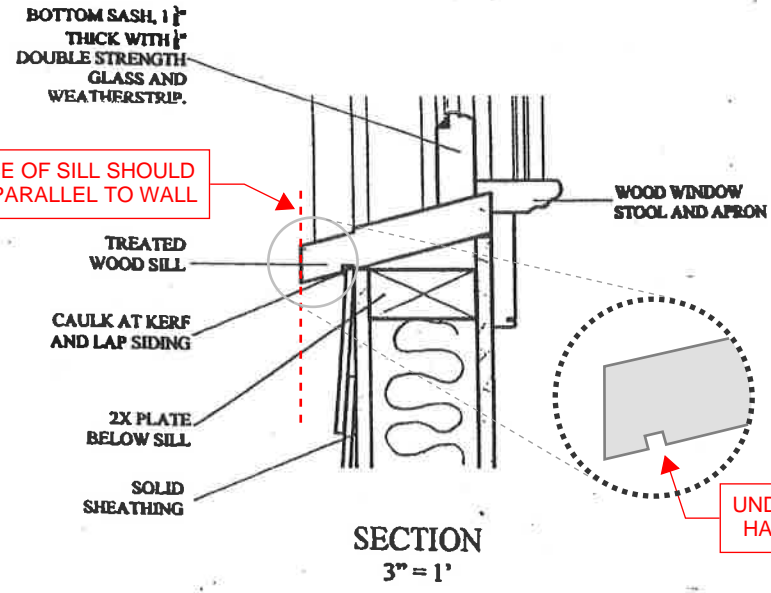

UNDERSIDE OF SILL SHOULD HAVE A ROUTED DRIP LINE

SECTION
3" = 1'

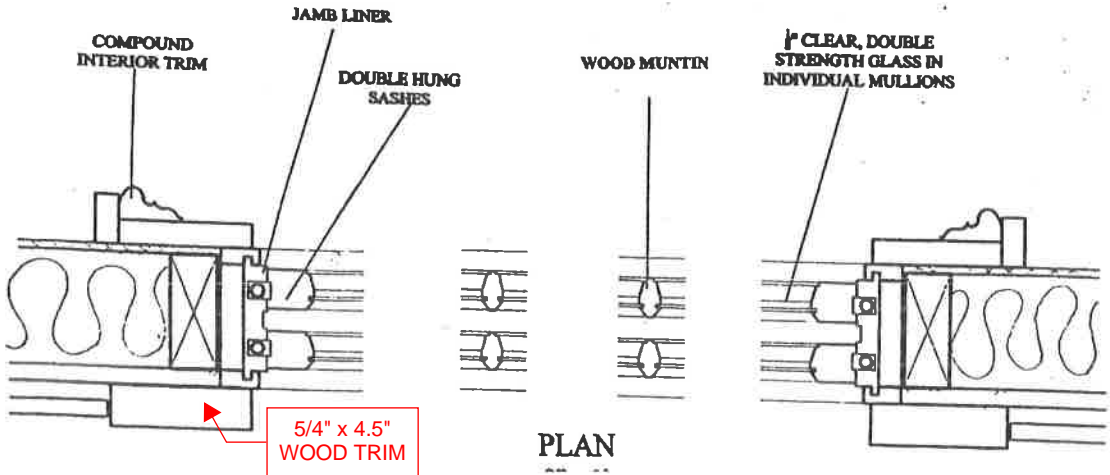

PLAN