

LAYOUT IS APPROVED
BY THE CUSTOMER

GG17010

12.96 kW DC PV SYSTEM
Opp ID #151575
6753 MORRISON ROAD - NEW
ORLEANS Louisiana 70126

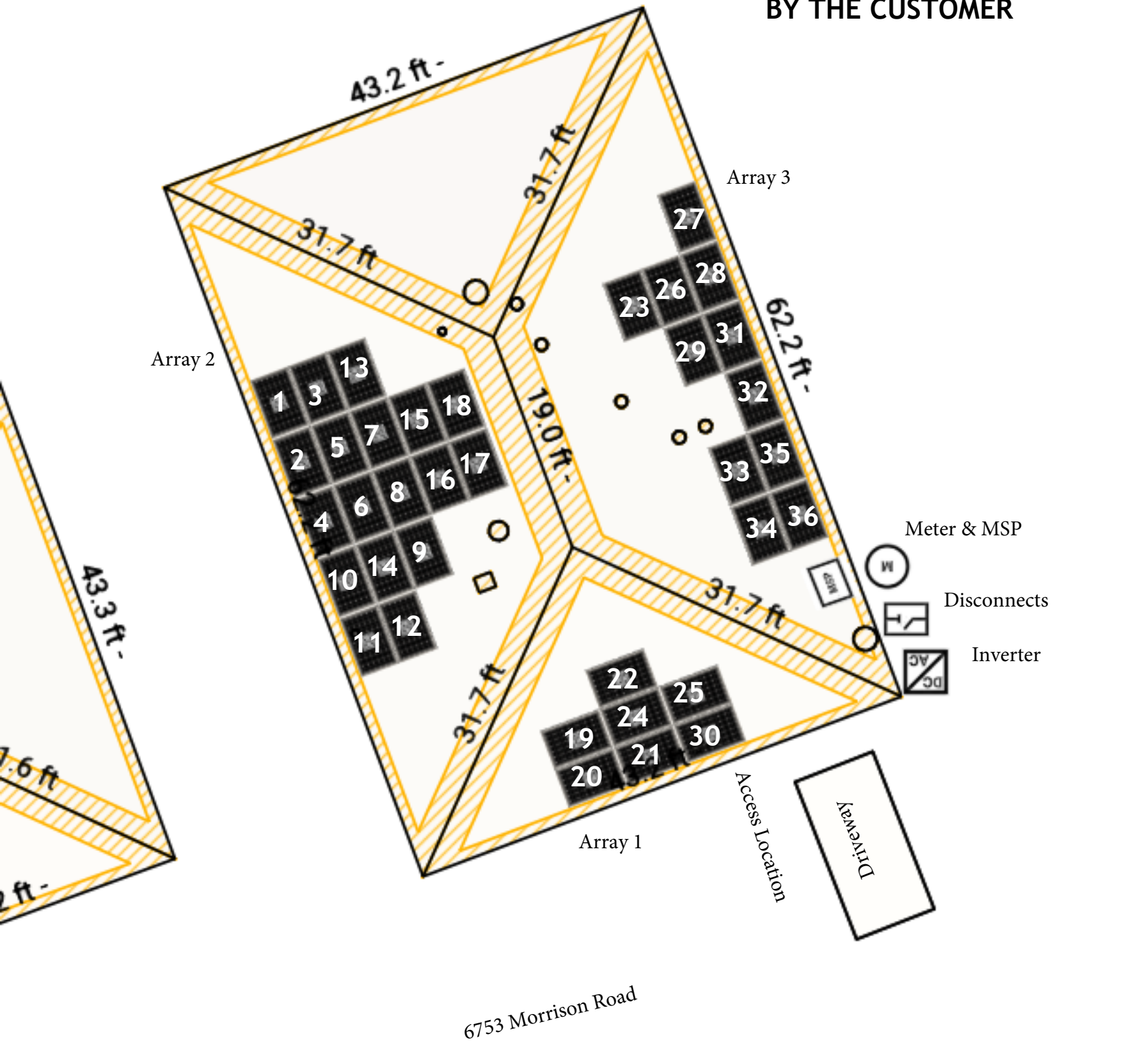

Manufacturer	Model	Quantity
Solaria	PowerXT-360R-PD	36
SolarEdge Technologies Inc.	P370	36
SolarEdge Technologies Inc.	SE10000H-US	1

Array Information

Array	Modules	Tilt	Azimuth
1	7	21	159
2	18	21	249
3	11	21	69

**12.96 SE SOLARIA
POWER XT-360
DECO-TECH**

Date Drawn: July 25th, 2021

Drawn By: James Weldon

Revision Number :

Setbacks Applied

- Ridge: 36"
- Rake: 36"
- Valley: 18"
- Hip: 18"
- Eave: 6"

Contractor is responsible for verifying all on-site conditions and measurements, complying with local and national code requirements and manufacturers' manuals.