

3' off left Property line  
 5' off Rear Property line  
 6' off Wall of House

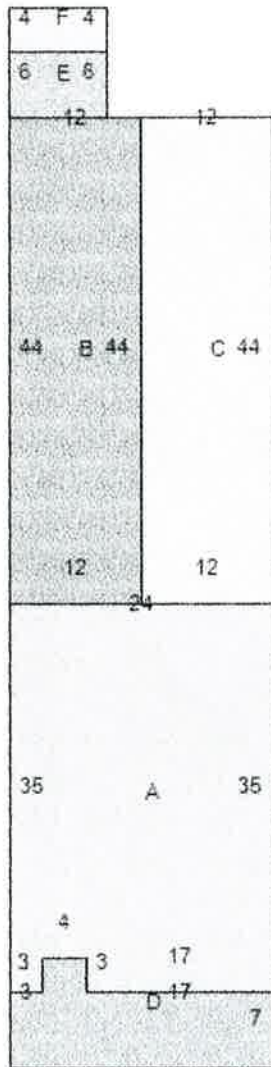

Installing a 24KW General generator w/ a 200 amp ATS.  
 We are setting the generator on a 3' tall stand. Clear of windows, doors, vents.

Proposed location is minimally visible from the public right of way.  
 Any conduit or other mechanical equipment must be approved by the HDLC.



1221 7th Street  
 New Orleans La 70115