

840 TCHOUPITALOUS 840 TCHOUPITALOUS

Quote #: NP46PD5

A Proposal for Window and Door Products prepared for:

Job Site:
70115

Shipping Address:
SUNCOAST CONTRACTORS SUPPLY
5104 A AVE
LONG BEACH, MS 39560

Project Description:
840 TCHOUPITALOUS

Featuring products from:



GREG MAREK
SUNCOAST CONTRACTORS SUPPLY
3160 KUTAK RD
FORT MYERS, FL 33916
Phone: (985) 237-9826

Email: greg@suncoastsupply.net

This report was generated on 8/25/2022 8:38:34 AM using the Marvin Order Management System, version 0003.15.00 (Current). Price in USD. Unit availability and prices are subject to change. Dealer terms and conditions may apply.



OMS Ver. 0003.15.00 (Current)
Product availability and pricing subject to change.

840 TCHOUPITALOUS
840 TCHOUPITALOUS
Quote Number: NP46PD5

UNIT SUMMARY

The following is a schedule of the windows and doors for this project. For additional unit details, please see Line Item Quotes.

Additional charges, tax or Terms and Conditions may apply. Detail pricing is per unit.

NUMBER OF LINES: 1		TOTAL UNIT QTY: 14		EXT NET PRICE: USD 47,492.06		
LINE	MARK UNIT	PRODUCT LINE	ITEM	NET PRICE	QTY	EXTENDED NET PRICE
1	SECOND FLOOR	Ultimate	Single Hung Round Top G2 RO 42 1/2" X 85 5/16" Entered as FS 41 1/2" X 84 13/16"	3,392.29	14	47,492.06

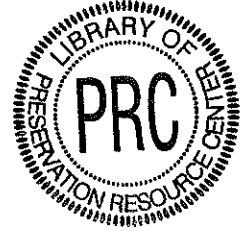

OMS Ver. 0003.15.00 (Current)
 Product availability and pricing subject to change.



840 TCHOUPITALOUS
 840 TCHOUPITALOUS
 Quote Number: NP46PD5

LINE ITEM QUOTES

The following is a schedule of the windows and doors for this project. For additional unit details, please see Line Item Quotes. Additional charges, tax or Terms and Conditions may apply. Detail pricing is per unit.

Line #1	Mark Unit: SECOND FLOOR	Net Price:		3,392.29
Qty: 14		Ext. Net Price:	USD	47,492.06

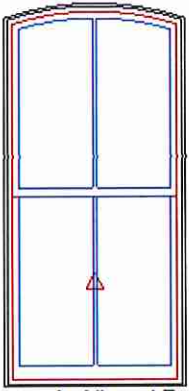

As Viewed From The Exterior

Entered As: FS
 FS 41 1/2" X 84 13/16"
 RO 42 1/2" X 85 5/16"
Egress Information
 No Egress Information available.
Performance Information
 Product Performance Information is currently unavailable in the OMS for this product and glazing option. To request product performance information not in the OMS, contact your Marvin representative or submit an Assistance Request.
Performance Grade
 Licensee #1127
 AAMA/WDMA/CSA/101/ I.S.2/A440-08
 LC-PG50 1149X2223 mm (45.3X87.5 in)
 LC-PG50 DP +50/-50
 FL17635

Stone White Clad Exterior
 Bare Pine Interior
 Ultimate Single Hung Round Top G2 - RT6 3,135.14
 Frame Size 41 1/2" X 84 13/16"
 Frame Size Springline from bottom: 81 1/2"
 Rough Opening 42 1/2" X 85 5/16"
 Rough Opening Springline from bottom: 81 55/64"
 Equal 1-Lite DLO Heights
Partial travel - current dimensions will not allow full travel of the bottom sash.
 Top Sash
 Stone White Clad Sash Exterior
 Bare Pine Sash Interior
 IG
 Low E2 w/Argon
 Black Perimeter and Spacer Bar
 7/8" SDL - With Spacer Bar - Black 197.44
 Rectangular - Special Cut 2W1H
 2 Rect Lites
 Stone White Clad Ext - Bare Pine Int
 Ogee Interior Glazing Profile
 Bottom Sash
 Stone White Clad Sash Exterior
 Bare Pine Sash Interior
 IG
 Low E2 w/Argon
 Black Perimeter and Spacer Bar
 7/8" SDL - With Spacer Bar - Black 59.71
 Rectangular - Special Cut 2W1H
 Stone White Clad Ext - Bare Pine Int
 Ogee Interior Glazing Profile
 Beige Interior Weather Strip Package
 White Exterior Weather Strip Package
 White Sash Lock
 White Top Sash Strike Plate Assembly Color
 No Screen
 4 9/16" Jamb
 Nailing Fin

All glazing to be clear.
 Textured and tinted glass is not permitted, TYP

Windows must be installed recess mounted into existing openings. Nailing fin must be removed or modified such that windows can be properly installed to match existing condition and as per attached window detail, TYP

***Note: Unit Availability and Price is Subject to Change

Project Subtotal Net Price: USD 47,492.06
 9.450% Sales Tax: USD 4,488.00
 Project Total Net Price: USD 51,980.06



OMS Ver. 0003.15.00 (Current)
Product availability and pricing subject to change.

840 TCHOUPITOUS
840 TCHOUPITOUS
Quote Number: NP46PD5



TERMS AND CONDITIONS



OMS Ver. 0003.15.00 (Current)
 Product availability and pricing subject to change.

PRODUCT AND PERFORMANCE INFORMATION

NFRC energy ratings and values may vary depending on the exact configuration of glass thickness used on the unit. This data may change over time due to ongoing product changes or updated test results or requirements.

The National Fenestration Rating Council (NFRC) has developed and operates a uniform national rating system for the energy performance of fenestration products, including windows and doors. For additional information regarding this rating system, see www.nfrc.org.

NFRC energy values and ratings may change over time due to ongoing product changes, updated test results or requirements.

Review the map below to determine if your units meet ENERGY STAR for your location.

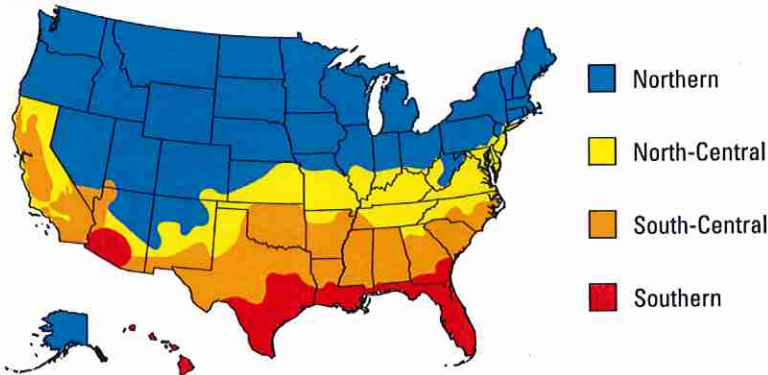

International Energy Conservation Code (IECC) Climate Regions

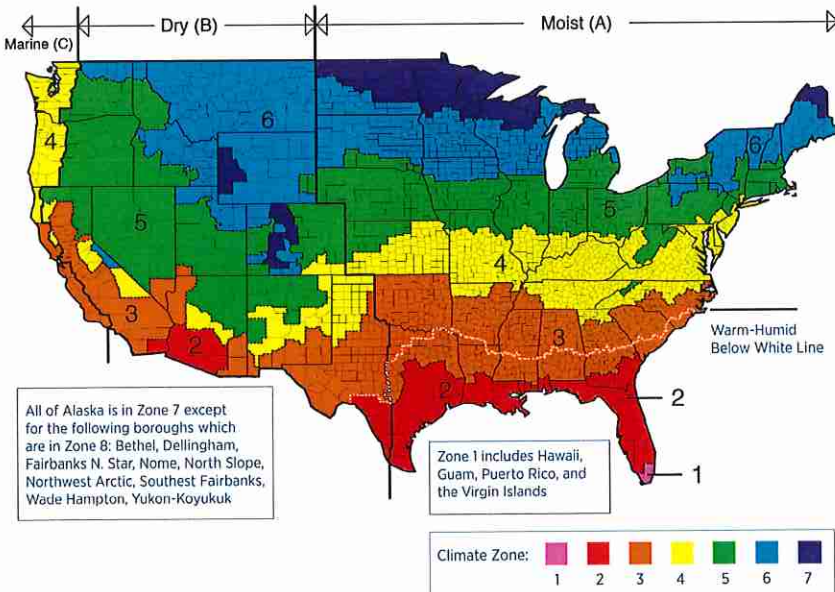

OMS Ver. 0003.15.00 (Current)
Product availability and pricing subject to change.

840 TCHOUPITALOUS
840 TCHOUPITALOUS
Quote Number: NP46PD5

PURCHASE APPROVAL/SIGN OFF



Project Subtotal Net Price: USD 47,492.06
9.450% Sales Tax: USD 4,488.00
Project Total Net Price: USD 51,980.06

I have reviewed all line item quotes in detail and agree that the product specifications and pricing are accurate, and I approve the project for order. I acknowledge that additional charges, tax or Terms and Conditions may apply.

BUYER:

Signature: _____

Title: _____

Date: _____

Seller: _____

Buyer: _____

WINDOW DETAIL

WINDOWS MUST BE RECESS MOUNTED INTO THE OPENING

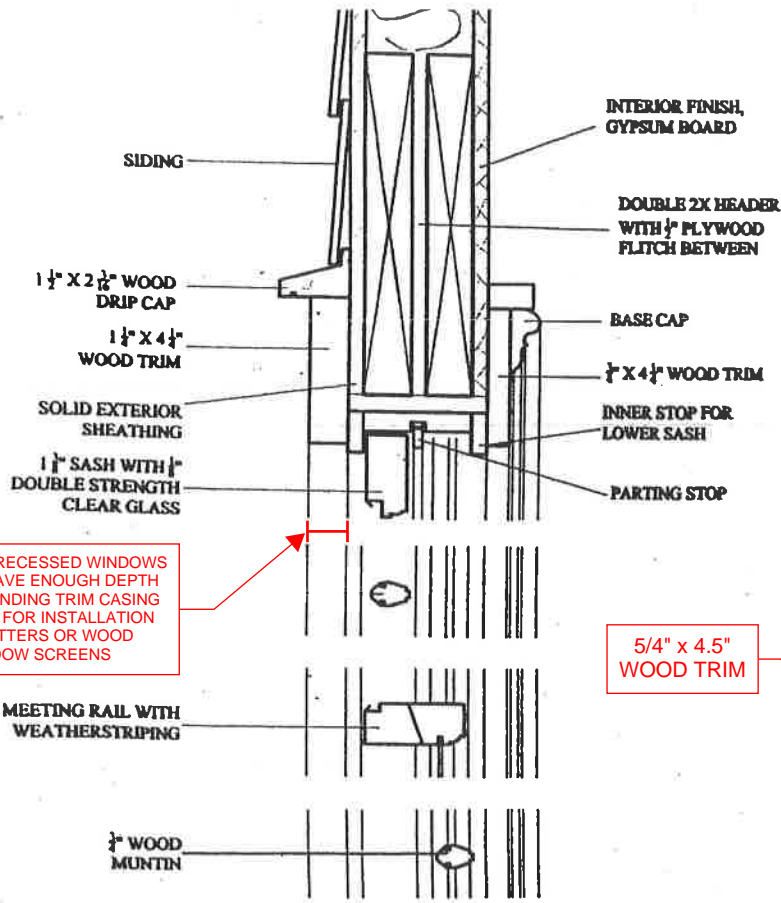

PROPERLY RECESSED WINDOWS SHOULD HAVE ENOUGH DEPTH IN SURROUNDING TRIM CASING TO ALLOW FOR INSTALLATION OF SHUTTERS OR WOOD WINDOW SCREENS

5/4" x 4.5" WOOD TRIM

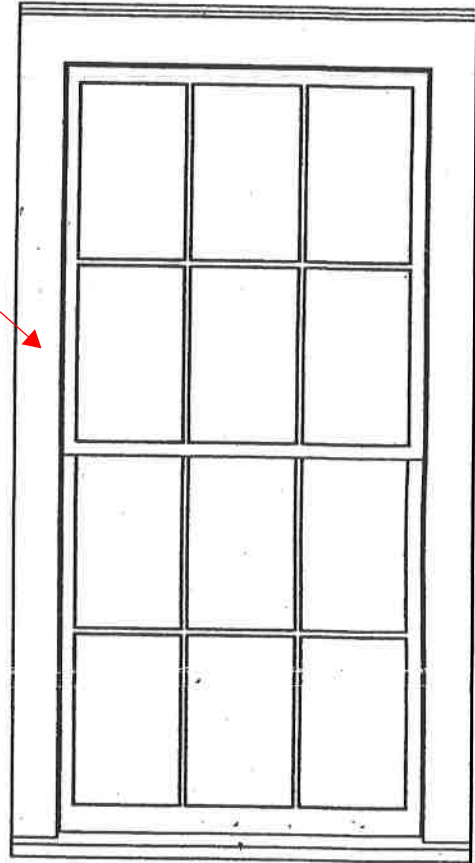

FACE OF SILL SHOULD BE PARALLEL TO WALL

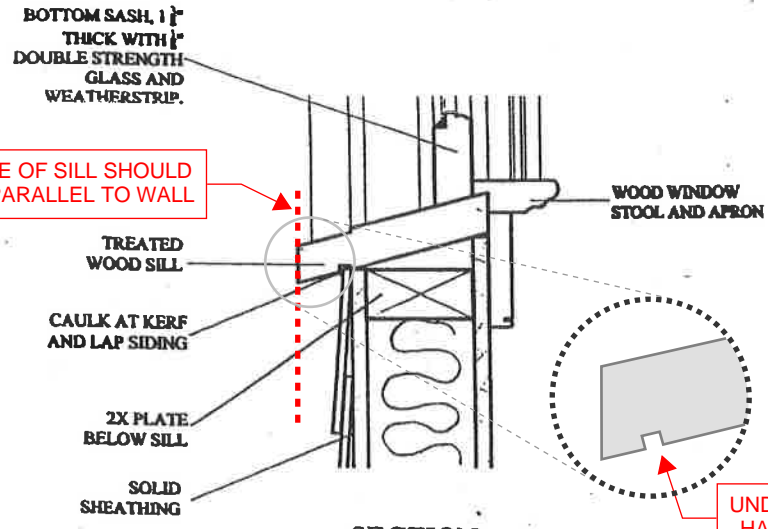

EXTERIOR ELEVATION
1 1/2" = 1'



UNDERSIDE OF SILL SHOULD HAVE A ROUTED DRIP LINE

SECTION
3" = 1'

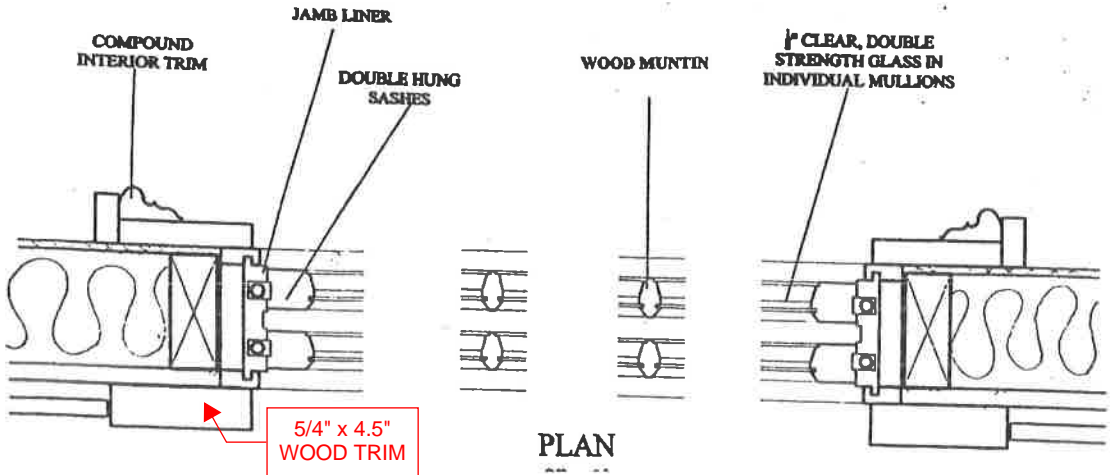

PLAN