

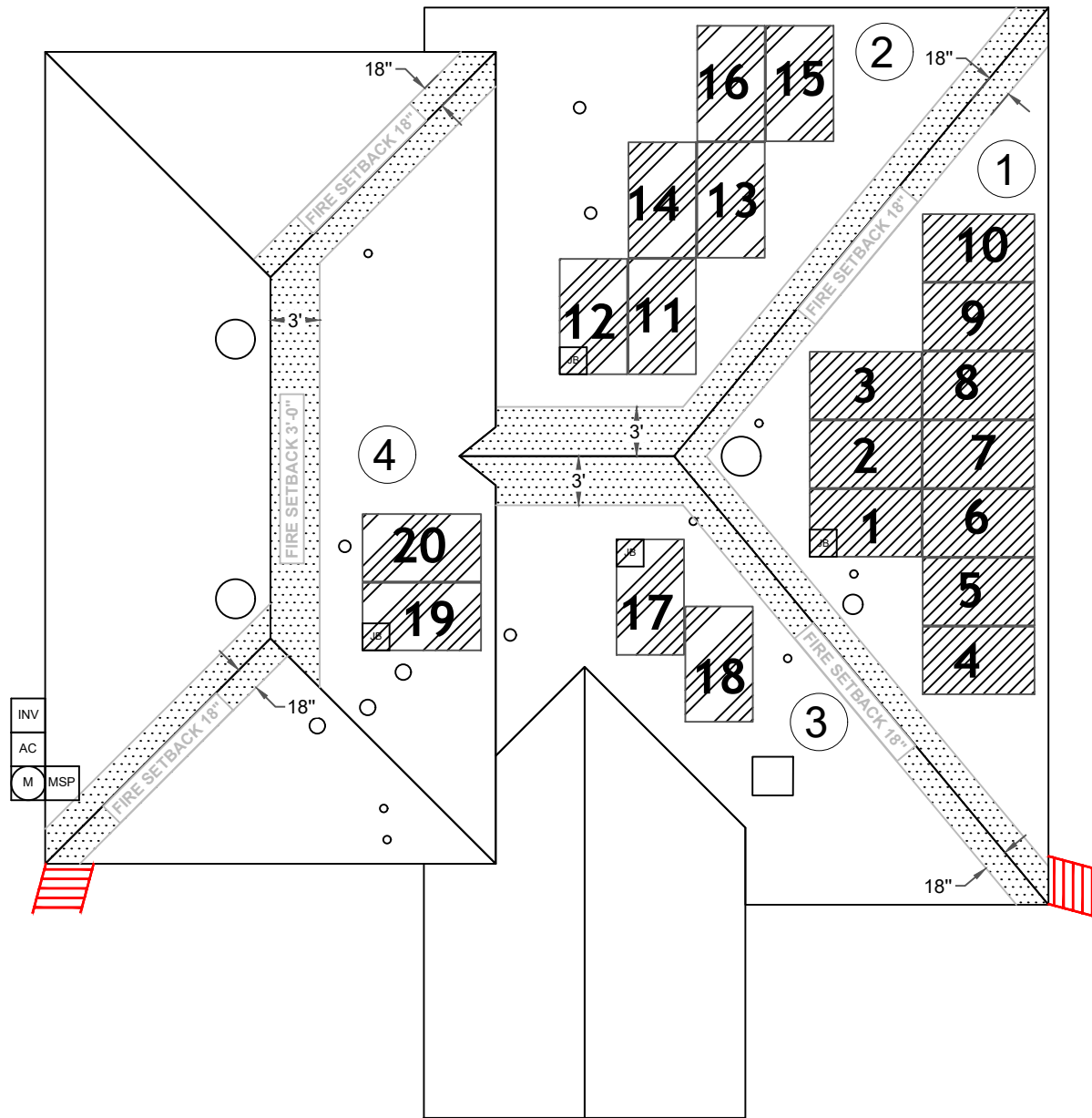

HYMAN CT



**P-003284**  
**GG18027**  
**3537 HYMAN CT**  
**NEW ORLEANS, LA**  
**70131**  
 FIRE CODE OFFSET  
 GROUND ACCESS POINT

**CNO**  
**OPP # 194235**

**STRING'S**  
 STRING #1 - 10 MODULES  
 STRING #2 - 10 MODULES

**SYSTEM UPGRADE**  
**8.30 SE CANADIAN**  
**SOLAR 415**

**ROOF SECTION(S):**

①	SLOPE:	26
	MODULE:	10
	AZIMUTH:	124
②	SLOPE:	23
	MODULE:	6
	AZIMUTH:	34
③	SLOPE:	23
	MODULE:	2
	AZIMUTH:	214
④	SLOPE:	18
	MODULE:	2
	AZIMUTH:	124

**PosiGen**  
Solar • Energy Efficiency • Roofing

**POSIGEN DEVELOPER, LLC**  
819 Central Ave, Suite 210  
Jefferson, LA 70121

JOB NUMBER: 194235  
 UTILITY: ENTERGY ALGIERS  
 RACKING: K2 CROSS RAIL SYSTEM  
 MODULES: (20) CANADIAN SOLAR CS3N-415MS  
 OPTIMIZER: (20) SOLAREEDGE OPTIMIZER S440/P505  
 INVERTER: (1) SOLAREEDGE SE7600H-US

PRODUCTION: 9,670 KWH

DESIGNED BY: **solaroot**  
ENGINEERING SERVICES PRIVATE LIMITED

REV:

STAMP:

**PV-2.0**

PAGE NAME:  
**PLOT/SITE PLAN**

SCALE:  
3/32" = 1'-0"

DATE:  
**7/14/2022**