

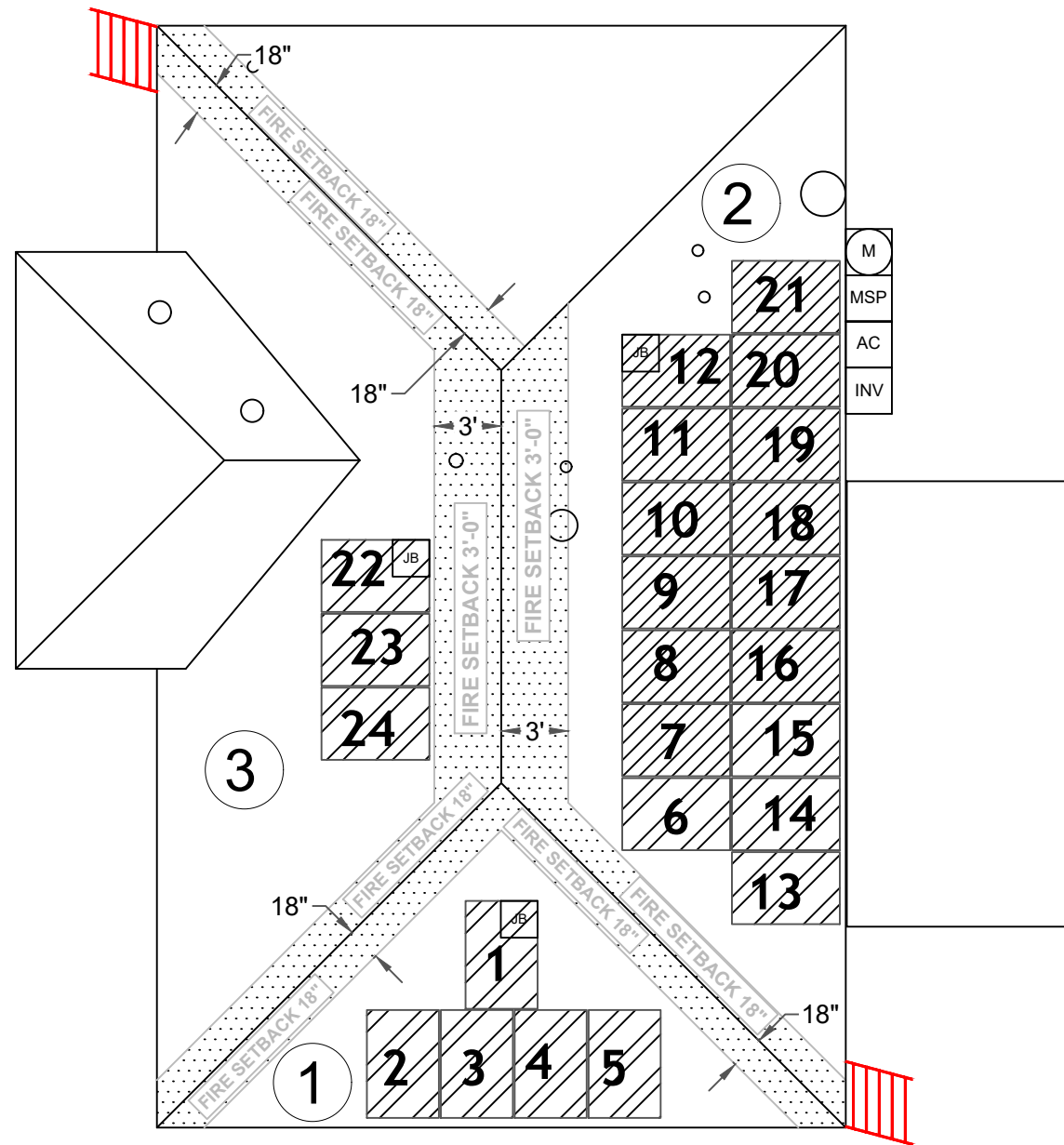

BRISTOL PL



P-003137

GG17986

2444 BRISTOL PL
NEW ORLEANS, LA
70131

CNO
OPP # 199782

STRING'S

STRING #1 - 12 MODULES
 STRING #2 - 12 MODULES

REDEPLOY
6.0 SE HYU 250
SYSTEM # S-012850

ROOF SECTION(S):

①	SLOPE:	27
	MODULE:	5
	AZIMUTH:	183
②	SLOPE:	27
	MODULE:	16
	AZIMUTH:	93
③	SLOPE:	27
	MODULE:	3
	AZIMUTH:	273



JOB NUMBER: 199782

UTILITY: ENTERGY

RACKING: K2 CROSS RAIL SYSTEM

MODULES: (24) HYUNDAI HIS- M250G(SL)

OPTIMIZER: (24) SOLAREEDGE OPTIMIZER P300

INVERTER: (1) SOLAREEDGE SE5000H-US

PRODUCTION: 7,176 KWH

REV:

DESIGNED BY: KARAN RANA

PV-2.0

PAGE NAME:
PLOT/SITE PLAN

SCALE:
 1/8" = 1'-0"

DATE:
8/8/2022