

**DEPARTMENT OF SAFETY & PERMITS
CITY OF NEW ORLEANS**

PERMIT NO: _____

DATE: _____

ADDRESS: WALL BLVD.- 70114

SUBDIVISION: PLAZA PARK

DISTRICT: 5TH

SQUARE: F

LOTS: 1-B-1

| COMMUNITY NUMBER | PANEL NUMBER | SUFFIX | DATE OF FIRM INDEX | FIRM ZONE | BASE FLOOD ELEVATION (BFE) | FREEBOARD (ADD 1FT FOR A AND V ZONES) <small>OFFICE USE ONLY</small> |
|------------------|--------------|--------|--------------------|-----------|----------------------------|---|
| 225 203 | 0242 | F | 09/30/2016 | X | N/A N.A.V.D | +1ft = _____ |

MINIMUM FLOOR ELEVATION: _____ N.A.V.D.

IN ADDITION TO THE FEMA ELEVATIONS, THE FOLLOWING CONDITIONS MUST ALSO BE MET:

FOR V - ZONES ONLY:

_____ N.A.V.D.
(ELEVATION OF BOTTOM OF LOWEST HORIZONTAL STRUCTURAL MEMBER)

- A. TOP OF SLABS ON GRADE OR FILL MUST BE AT LEAST 36" ABOVE THE HIGHEST POINT OF CURB IN FRONT OF THE LOT OR SITE.
- B. PIER CONSTRUCTION: TOP OF PIERS (UNDERSIDE OF SILLS) MUST HAVE AT LEAST 18" CLEARANCE BENEATH THE STRUCTURE. IN ADDITION, THE LOWEST FLOOR MUST BE AT LEAST 36" ABOVE THE HIGHEST POINT OF CURB IN FRONT OF THE LOT OR SITE. (IF NO CURB, USE CENTERLINE OF STREET)
- C. ALL MECHANICAL OR PLUMBING EQUIPMENT SERVICING THE BUILDING MUST BE LOCATED AT OR ABOVE THE REQUIRED FLOOR ELEVATION.
- D. SLABS FOR ATTACHED GARAGES MUST BE AT THE REQUIRED FLOOR ELEVATION OR BE CONSTRUCTED OF WATER-RESISTANT MATERIALS WITH PROPER VENTING IN 2 WALLS.
- E. DETACHED GARAGES WITH PLUMBING MUST BE AT THE REQUIRED FLOOR ELEVATION.
- F. CONSTRUCTION BENCHMARK MUST BE SET AT REQUIRED MINIMUM FLOOR ELEVATION OR GREATER. (ADD 1 FOOT FOR A & V-ZONES)

APPROVED FOR CITY BY: _____

1. CERTIFICATE OF CONSTRUCTION BENCHMARK

EXISTING HIGHEST TOP OF CURB ELEVATION -3.6' N.A.V.D.
EXISTING HIGHEST CENTERLINE OF STREET -3.5' N.A.V.D.

| |
|--|
| <small>FOR PERMIT OFFICE USE ONLY</small> |
| ADD 3ft to curb, if no curb use the centerline of street |
| + 3ft = _____ |

EXISTING LOT ELEVATIONS (PROPERTY CORNERS OR EDGE)
FRONT (RIGHT) -3.04' N.A.V.D. FRONT (LEFT) -2.52' N.A.V.D.
REAR (RIGHT) -1.73' N.A.V.D. REAR (LEFT) -1.75' N.A.V.D.
OTHER: _____ N.A.V.D.

DESCRIBE: _____
DESCRIPTION OF CONSTRUCTION BENCHMARK: 60D NAIL SET IN POWER POLE NEAR RIGHT PROPERTY LINE NAIL ON WEST SIDE OF POWER POLE.

ELEVATION OF CONSTRUCTION BENCHMARK: -0.63' N.A.V.D. (SEE NOTE F.)
REFERENCE BENCHMARK USED TO ESTABLISH CONSTRUCTION BENCHMARK: ALCO
ELEVATION OF REFERENCE BENCHMARK: 5.8' N.A.V.D.

SIGNATURE: _____ DATE: JUNE 20, 2022
(L.A. REGISTERED PROFESSIONAL LAND SURVEYOR OR CIVIL ENGINEER)

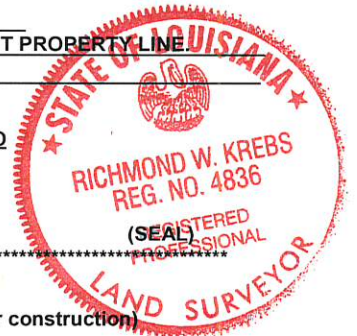

2. CERTIFICATE OF TOP OF FORM OR TOP OF PIER ELEVATION

(To be submitted before pouring concrete for slab construction or framing floor for pier construction)

AS BUILT ELEVATIONS: FORM _____ N.A.V.D. PIER _____ N.A.V.D.

PIER CONSTRUCTION:

ALL FRAMING MATERIALS BELOW THE MINIMUM FLOOR ELEVATION (B.F.E.) MUST BE CONSTRUCTED WITH WATER-RESISTANT MATERIALS AND THE FIRST FLOOR MUST BE AT OR ABOVE THE MINIMUM FLOOR ELEVATION (B.F.E.).

V ZONES ONLY:

BOTTOM OF LOWEST HORIZONTAL STRUCTURAL MEMBER _____ N.A.V.D.

(Must be submitted before framing begins)

IN V ZONES, ALL ENCLOSURES BELOW THE B.F.E. MUST BE DESIGNED WITH BREAK-AWAY WALLS CONSTRUCTION.

SIGNATURE: _____ DATE: _____
(L.A. REGISTERED PROFESSIONAL LAND SURVEYOR OR CIVIL ENGINEER) (SEAL)

3. FILLING, GRADING, DRAINAGE, SIDEWALK AND DRIVEWAY CERTIFICATION AND AFFIDAVIT
(To be submitted before Use & Occupancy Certificate can be issued)

THIS WILL CONFIRM THAT ALL FILLING, GRADING, DRAINAGE, SIDEWALKS AND DRIVEWAYS HAVE MET THE REQUIREMENTS OF THE APPLICABLE SECTIONS OF THE CODE OF THE CITY OF NEW ORLEANS.

OWNER: _____ DATE: _____

APPLICANT: _____ DATE: _____ (NOTARY)

OR

IS LOT PROPERLY FILLED TO GRADE? YES NO

(minimum lot slope, rear to front, 1 inch every 20 feet)

ARE SIDEWALKS PROPERLY INSTALLED? YES NO

ARE DRIVEWAYS PROPERLY INSTALLED? YES NO

ARE RETAINING WALLS REQUIRED? YES NO

(if yes, then on which side(s)) RIGHT LEFT REAR

ARE EQUIPMENT SLABS, SUCH AS A/C COMPRESSORS, AT MINIMUM FLOOR ELEVATION? YES NO

DO ATTACHED GARAGES IN A-ZONES, THAT ARE BELOW MINIMUM FLOOR ELEVATION, HAVE PROPER VENTING AND WATERPROOFING? YES NO N/A

SIGNATURE: _____ DATE: _____
(L.A. REGISTERED PROFESSIONAL CIVIL ENGINEER) (SEAL)

WALL BLVD.- 70114

