

PLAN

On this page draw a sketch of the plumbing (not necessarily to scale), showing as nearly as possible relative position of the fixtures. In elevation show the floor of the house, and upon which floor each fixture is. Specify the length, size, weight or quality and grade of all soil waste or ventilating pipes, and such description not clearly set forth in the preceding list. Plot plans or blue prints showing underground pipe lines and arrangement of fixtures shall be attached to and become part of the application, affording sufficient and definite information. pipe, fittings, and fixtures must be shown in BLACK. Old pipe, fittings and fixtures must be shown in RED.

NEW ONE STORY PIER HOUSE

4912 DREUX AVE

APPROVED
maevans, 8/12/2022, 11:45:03 AM

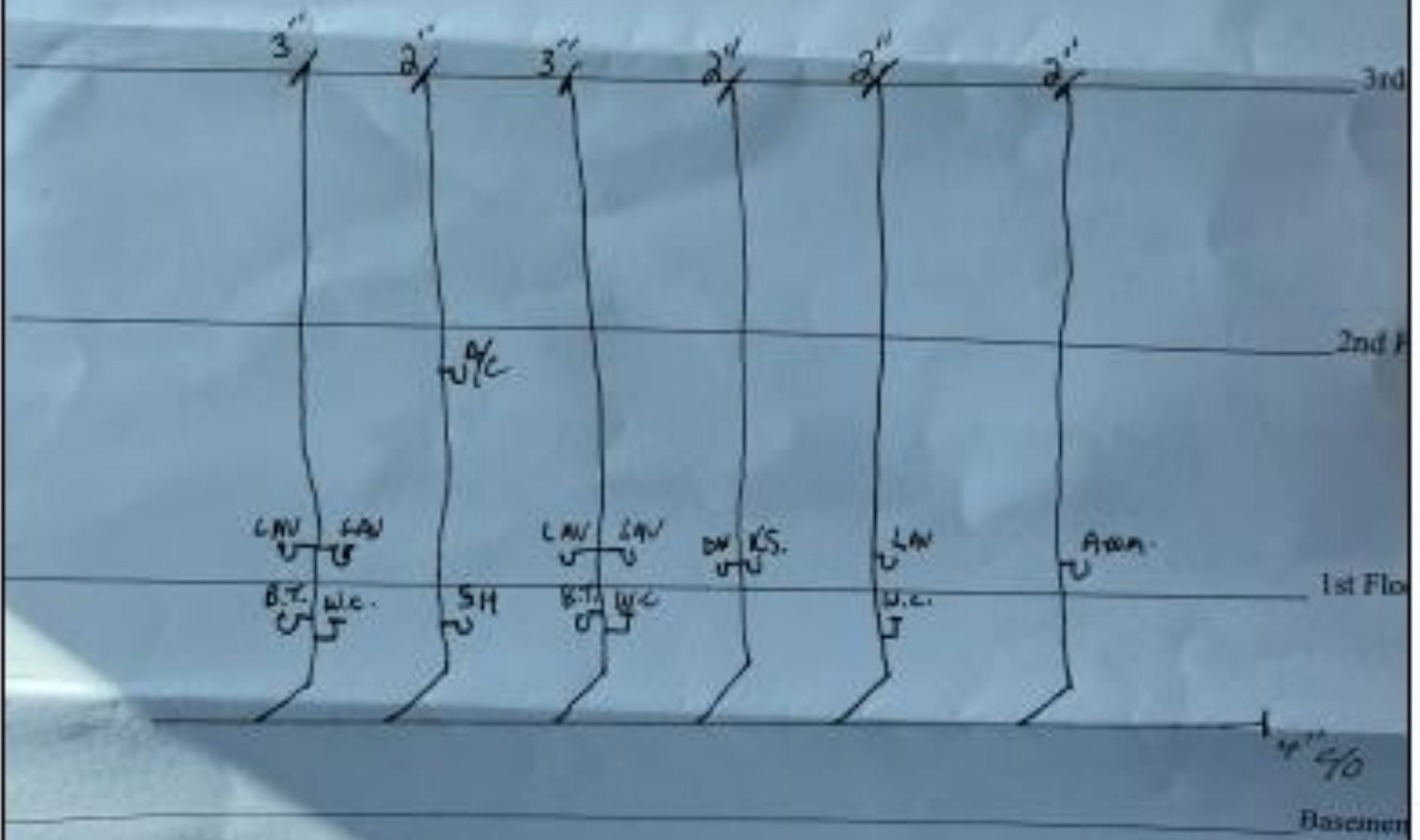

PERMIT

Plans and specifications above indicated are approved and permission is hereby granted to do the above indicated plumbing under the provisions of Section 2.7 of the Plumbing Rules and Regulations.

PERMIT ISSUED _____

Approved _____