

N. MIRO STREET
48.0'

ANNETTE STREET
32.0'

32.0'
ALLEN STREET (SIDE)

48.0'
1962 N. TONTI STREET

SITE PLAN

SCALE: 1/8" = 1'-0"

GENERAL NOTES:

ATTIC VENTILATION WILL BE CONTINUOUS RIDGE VENTS AND PERFORATED SOFFITS. OR EQUAL

TERMITE SHIELDS WILL BE 26 GA GALVANIZED AT EACH PIER UNDER SILLS

#2 PINE LUMBER WILL BE USED FOR FRAMING LUMBER

CONTRACTOR TO REMOVE DEBRIS FROM PROPERTY

ENCLOSED AREAS BELOW FLOOD GRADE SHALL HAVE A MINIMUM OF 1 SQ. IN. PER 1 SQ. FT. OF WATER FLOW VENTING.

MINIMUM INSULATION REQUIRED
FLOORS- R-19
WALL- R-13
CEILING- R-30

BUILDING MATERIAL USED BELOW DESIGN FLOOD ELEVATION MUST BE WATER RESISTANT

WINDOWS INSTALLED IN BATHTUB ENCLOSURES LESS THAN 60" F.F.F. REQUIRE SAFETY GLAZING AND WINDOWS WITHIN 2' OF DOORS AND WITHIN 5' OF STAIRS

FLOOD VENTS WHERE APPLICABLE SHALL BE 1'-0" OR LESS ABOVE GRADE.

WINDOWS WHERE BOTTOM EDGE IS LESS THAN 18" REQUIRES SAFET

ALL EXTERIOR WALL TO BE 6" STUDS

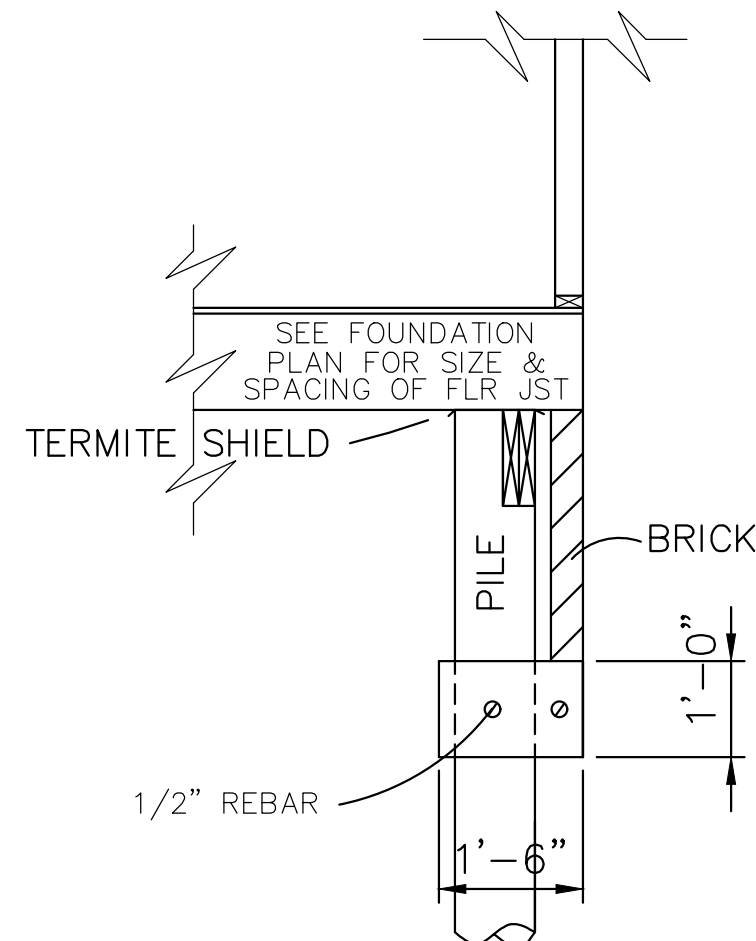

EXTERIOR BRICK DETAIL

SCALE: 1/2" = 1'-0"

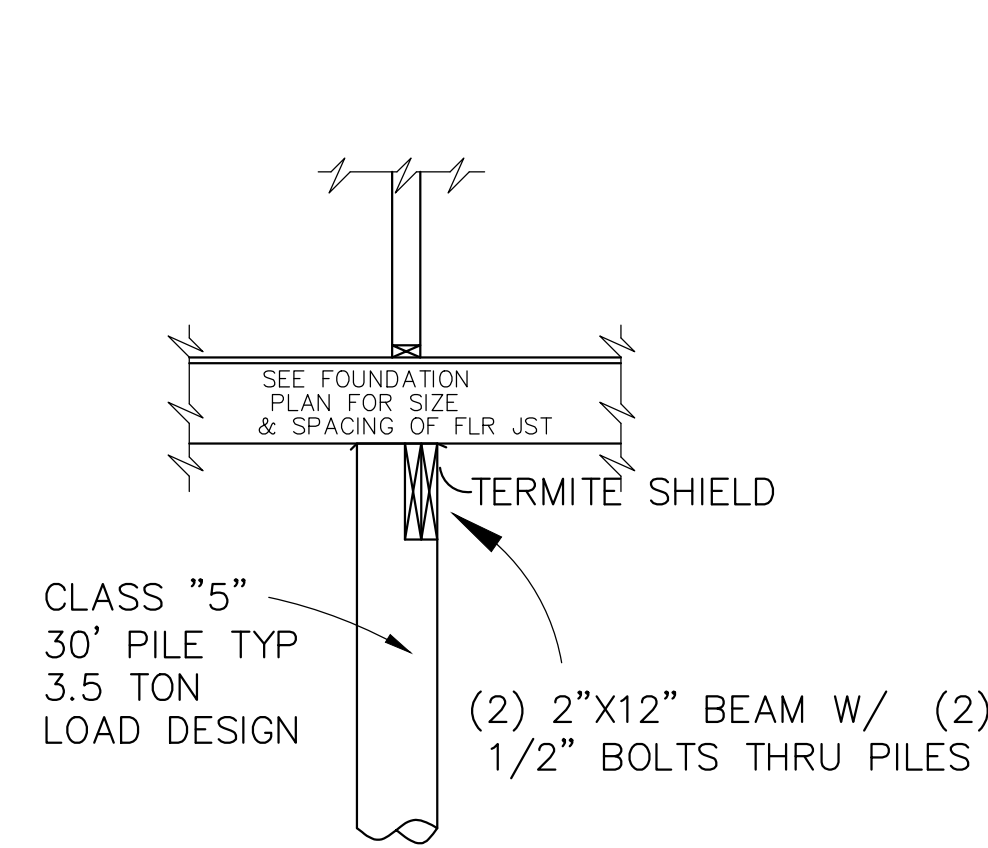

INTERIOR FOOTING DETAIL

SCALE: 1/2" = 1'

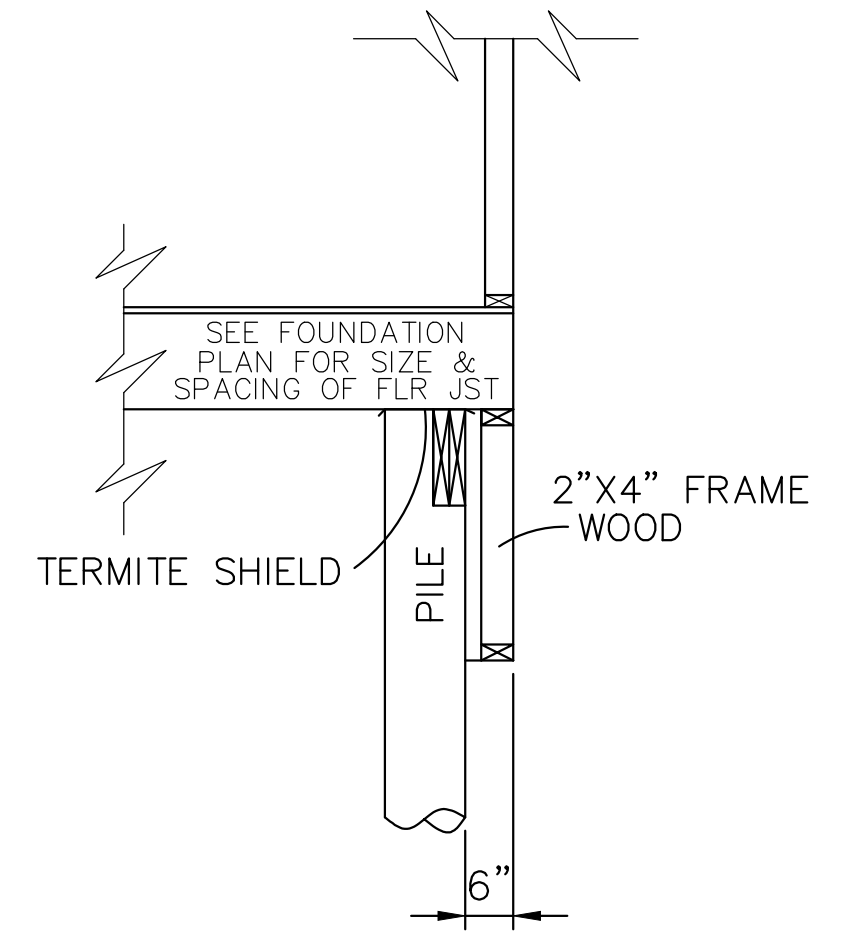

EXTERIOR WOOD DETAIL

SCALE: 1/2" = 1'-0"

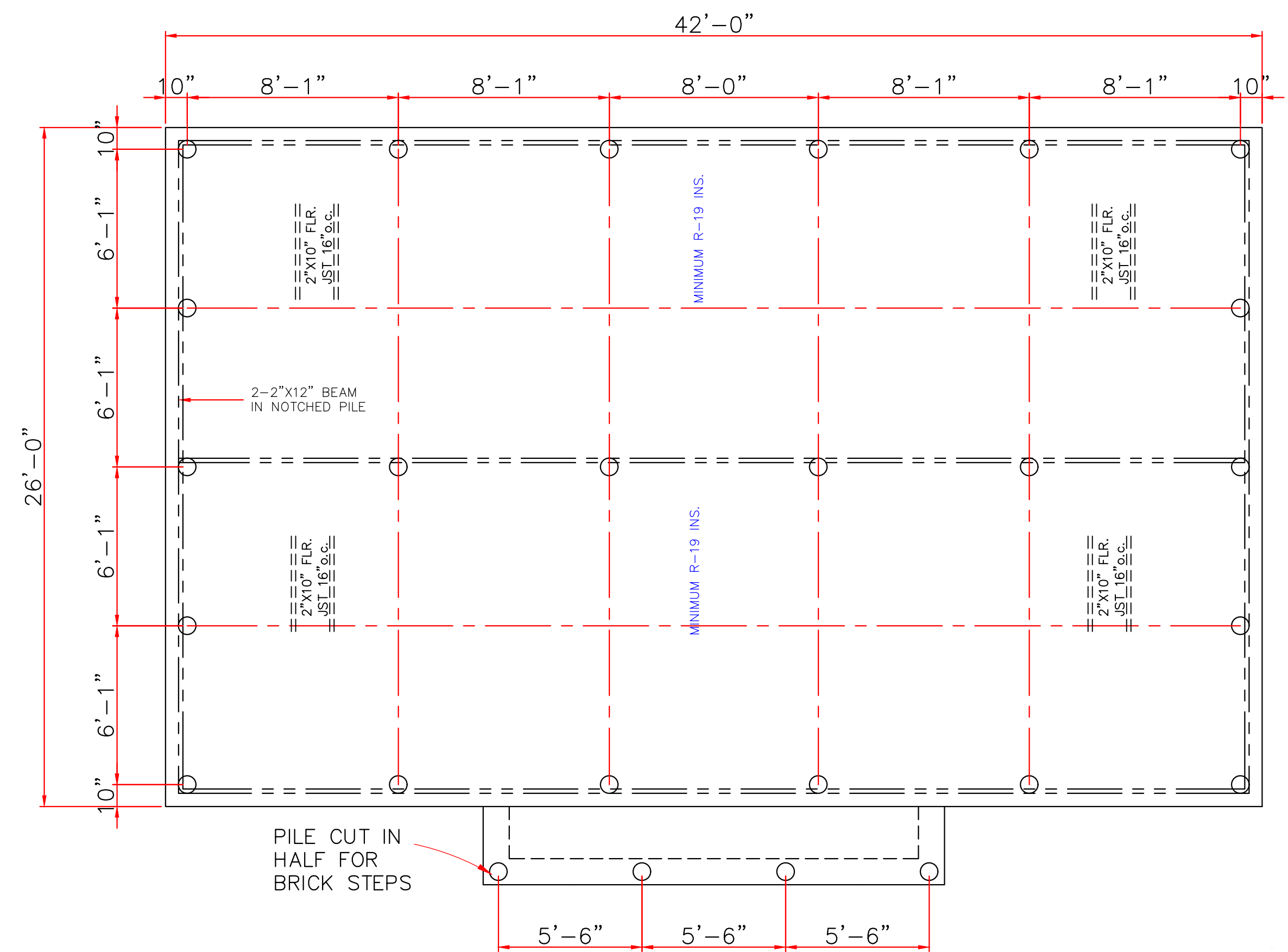

FOUNDATION PLAN

SCALE: 1/4" = 1'-0"

CLASS 5 30' PILE WITH 3.5 TON LOAD DESIGN
DRIVEN WITH STEEL DROP HAMMER OR RAPID
IMPACT HAMMER METHOD, TO REFUSAL

SOIL TREATMENT, CHEMICAL TERMITICIDE OR
TEMITE SHIELDS WILL BE USED FOR TERMITE
PROTECTION, BUILDER VERIFY

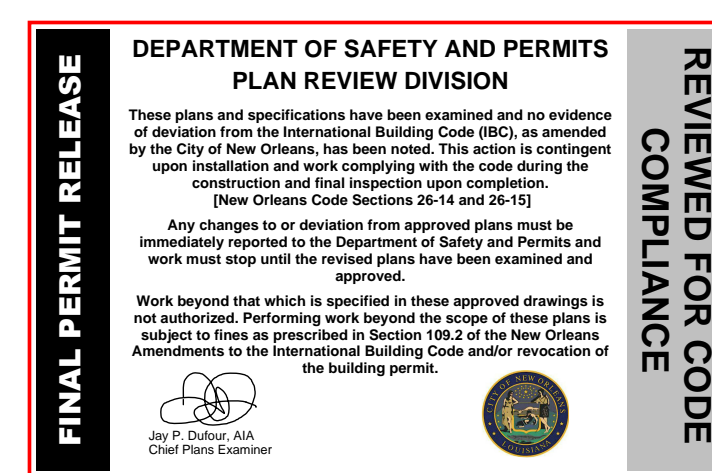

jcthibodeaux

07/19/2022

IN THE EVENT THAT A DIMENSIONAL DISCREPANCY IN THE DRAWINGS IS DISCOVERED BY THE GENERAL CONTRACTOR, SUBCONTRACTORS, ENGINEER, CONSULTANT, OR A SUPPLIER, SAID PARTY SHALL IMMEDIATELY NOTIFY THE ARCHITECT AND SUSPEND ALL ASSOCIATED WORK UNTIL SUCH TIME THAT A PROPER DETERMINATION HAS BEEN MADE BY THE ARCHITECT, WITH APPROPRIATE INSTRUCTIONS FOR RESOLUTION OF THE ISSUE. FAILURE TO REPORT KNOWN DISCREPANCIES AND CONTINUING WITH THE WORK WITHOUT NOTIFYING THE ARCHITECT SHALL RESULT IN AN ASSUMPTION OF RESPONSIBILITY FOR CORRECTIVE WORK TO ACHIEVE THE INTENDED DESIGN.

THESE PLANS HAVE BEEN PROPERLY EXAMINED BY THE UNDERSIGNED. I HAVE DETERMINED THAT THEY COMPLY WITH THE FOLLOWING EXISTING STATE AND LOCAL BUILDING CODES FOR THE JURISDICTION IN WHICH THE RESIDENCE IS TO BE LOCATED.

	LARRY TRUMBATUR		LIZZELL BROOKS 1962 N. TONTI STREET ORLEANS PARISH 504-874-7266	
	8307 LAFITTE CT. CHALMETTE, LA 70043		DATE	SHEET NO
	504-279-3508		11/1/21	1 OF 4

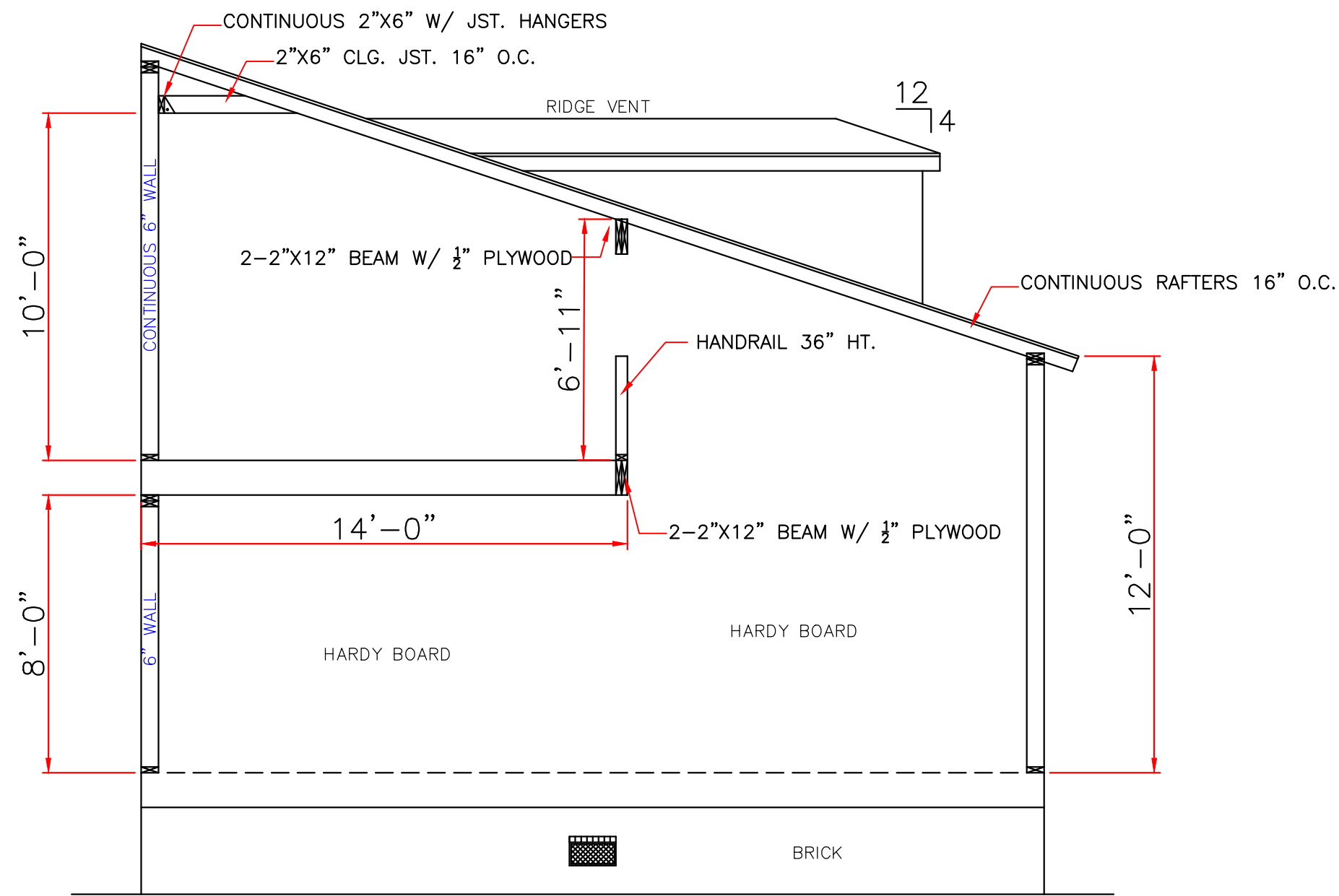

RIGHT ELEVATION
SCALE: 1/4" = 1'-0"

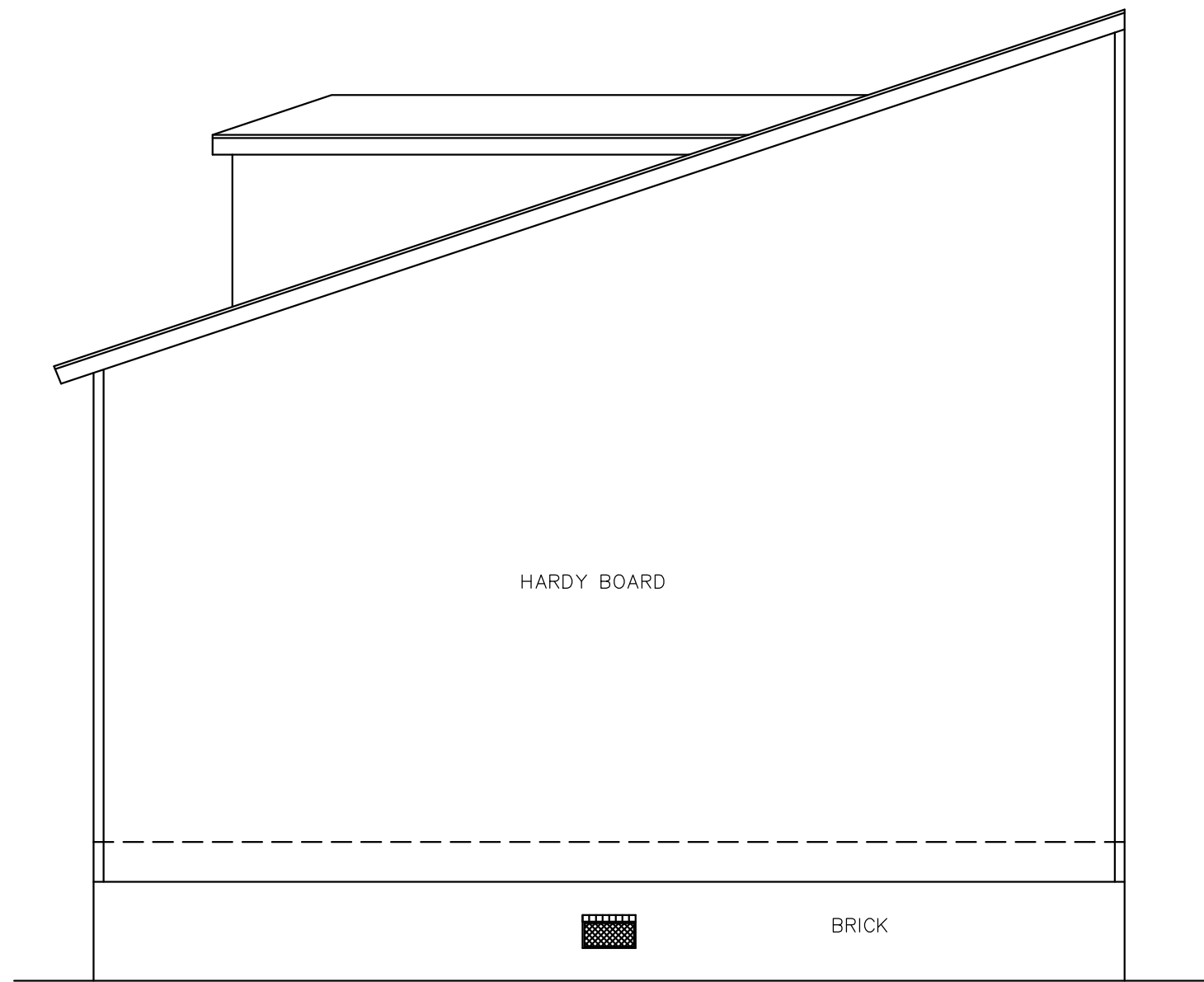

LEFT ELEVATION
SCALE: 1/4" = 1'-0"



FRONT ELEVATION
SCALE: 1/4" = 1'-0"

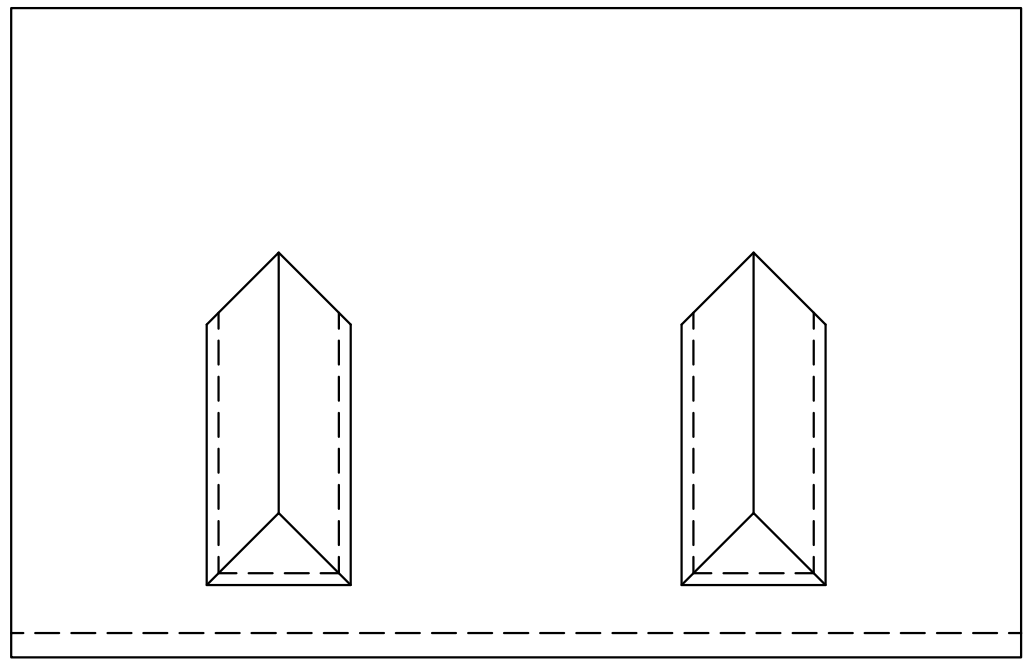

ROOF PLAN
SCALE: 1/8" = 1'-0"

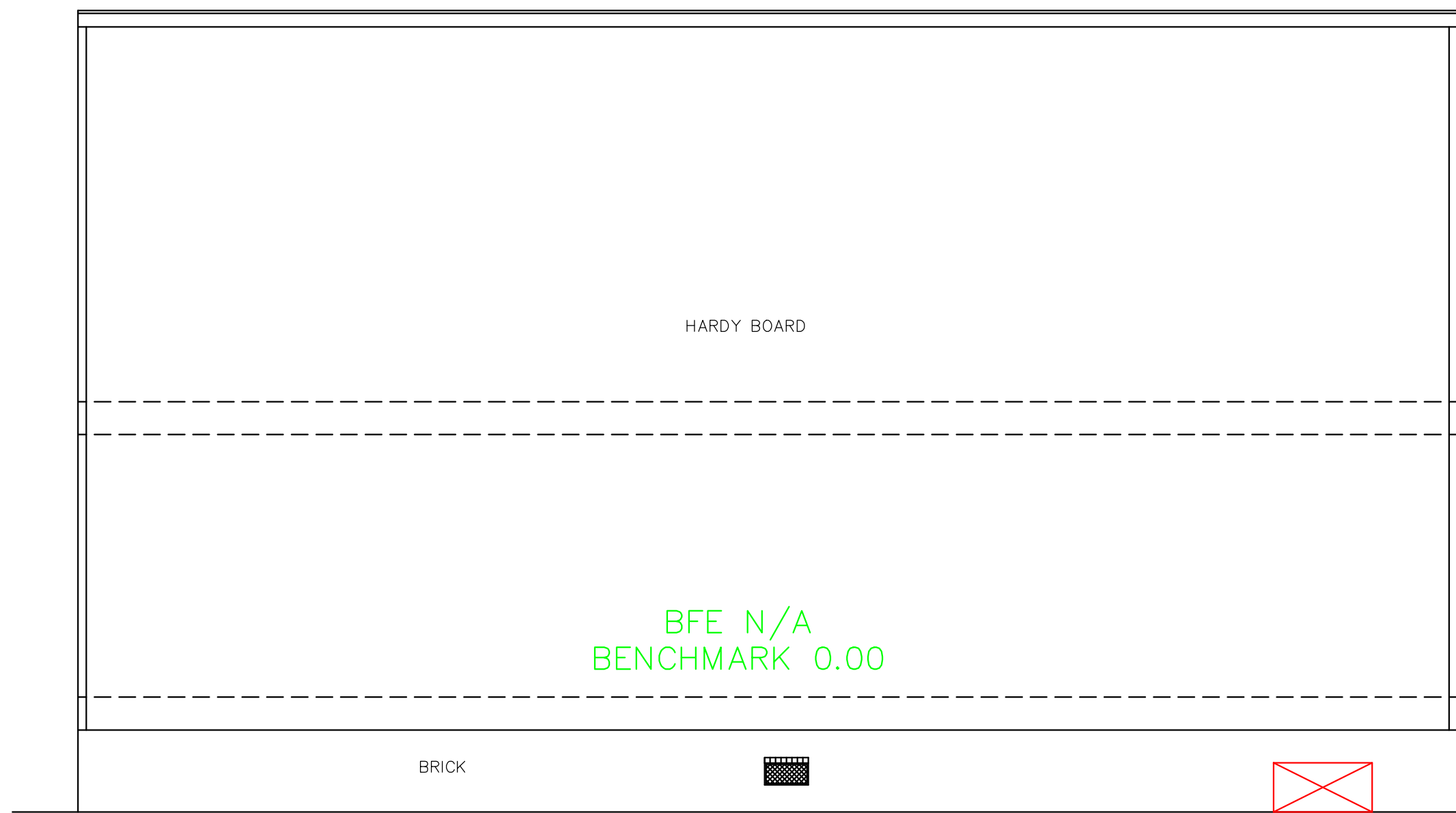

REAR ELEVATION
SCALE: 1/4" = 1'-0"

TOP OF FINISH FLOOR AT
OR ABOVE MINIMUM BASE FLOOD.

ALL MATERIALS BELOW
BASE FLOOD MUST
BE WATER RESISTANT

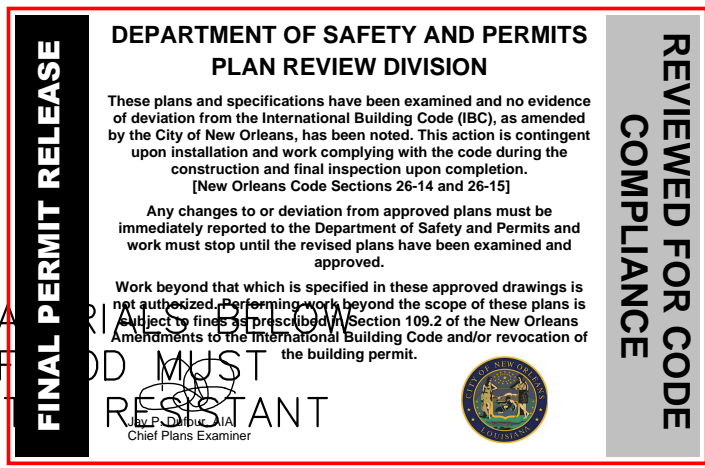

ALL MATERIALS BELOW
BASE FLOOD MUST
BE WATER RESISTANT

jcthibodeaux

07/19/2022

	LARRY TRUMBATUR	LIZZELL BROOKS 1962 N. TONTI STREET ORLEANS PARISH 504-874-7266	
	8307 LAFITTE CT. CHALMETTE, LA 70043	DATE 11/1/21	SHEET NO 2 OF 4
	504-279-3508	JOB NO 7710	

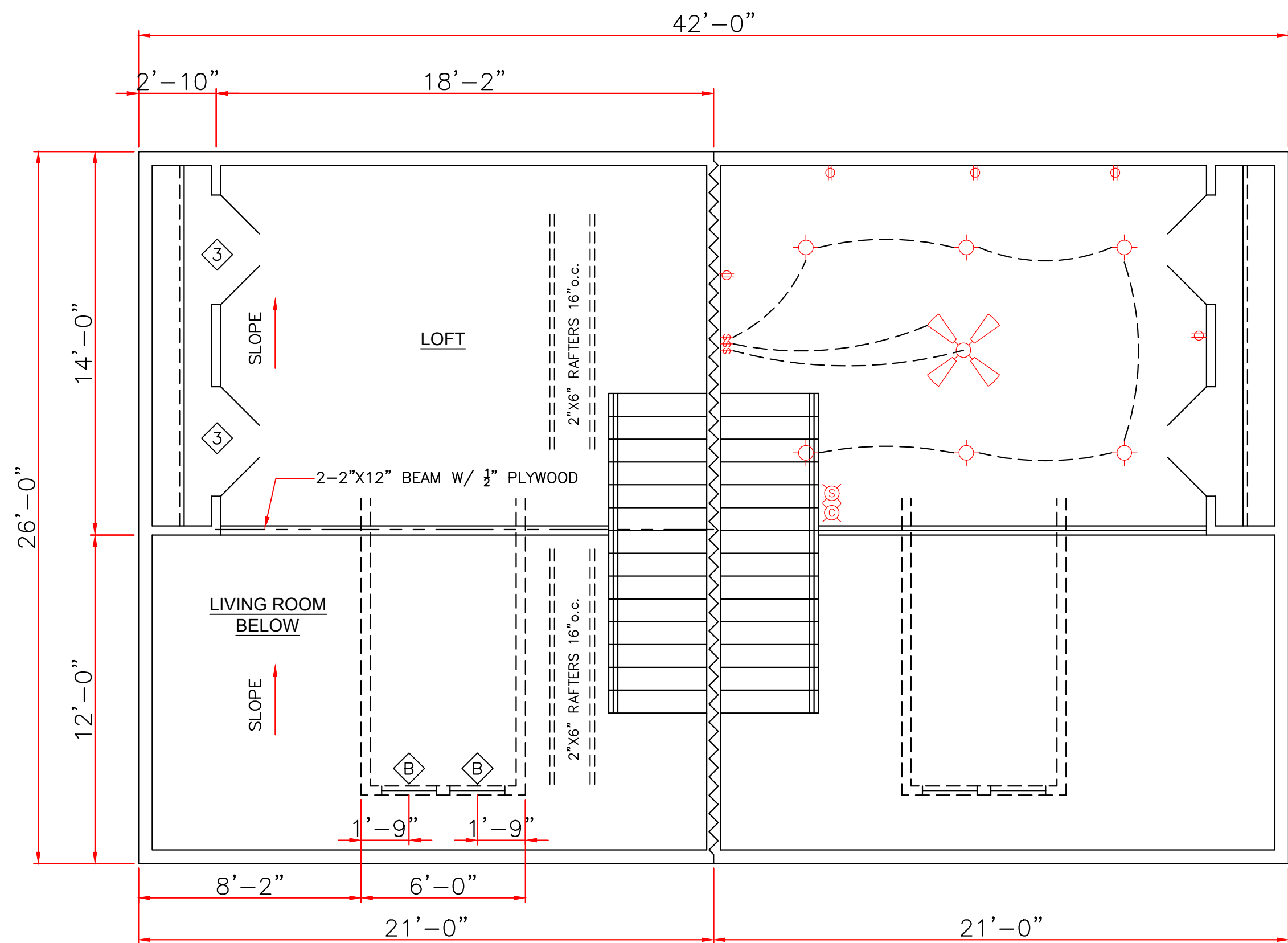

SECOND FLOOR PLAN
SCALE: 1/4" = 1'-0"

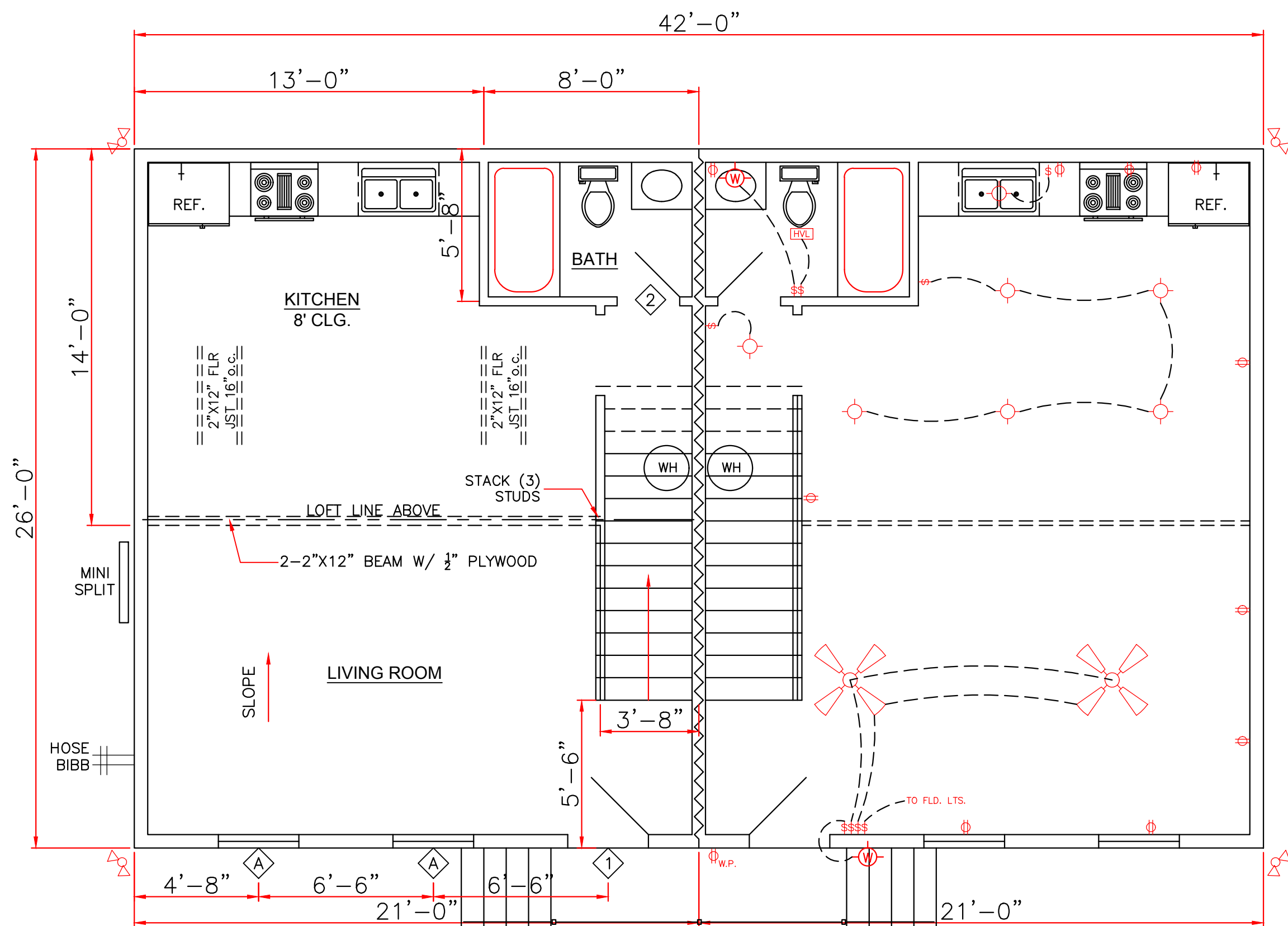

FIRST FLOOR PLAN
SCALE: 1/4" = 1'-0"

SQUARE FOOTAGE	
LIVING	1092
LOFT	588
TOTAL	1680

DOORS		
1	3'0"x8'0"x1 3/4"	EXT. INSUL. W/ 12" TRANSDM
2	2'0"x8'0"x1 3/8"	INTERIOR RAISED PANEL
3	2-2'0"x6'8"x1 3/8"	INTERIOR RAISED PANEL PAIR

WINDOWS		
A	3'0"x6'0"	VINYL S.H. 2/2 LTS W/ 12" TRANSDM
B	2'0"x3'0"	VINYL S.H. 2/2 LTS

ENERGY PERFORMANCE RATING: U-FACTOR=.55; SOLAR HEAT GAIN COEFFICIENT=.35

ELECTRICAL NOTES

1. AFCI PROTECTION SHALL BE PROVIDED FOR DINING ROOMS, FAMILY ROOMS, LIVING ROOMS, HALLWAYS, CLOSETS, BEDROOMS, ETC.
2. SMOKE DETECTORS: (A) SHALL BE INSTALLED IN EACH SLEEPING ROOM. (B) SHALL BE INSTALLED OUTSIDE, IN THE VICINITY OF EACH SLEEPING ROOM. (C) SHALL BE 120 VOLT, HARDWIRED, INTERCONNECTED, WITH A BATTERY BACKUP. (D) SHALL NOT BE INSTALLED WITHIN 36 INCHES OF A RETURN AIR GRILLE OR ANY PADDLE FAN BLADE.
3. KITCHEN: (A) ALL RECEPTACLES OVER COUNTERTOP SHALL BE GFI PROTECTED REGARDLESS OF DISTANCE FROM THE SINK. (B) THE DISHWASHER SHALL BE CONNECTED BY MEANS OF AN APPLIANCE CORD TO A RECEPTACLE UNDER THE SINK. THE RECEPTACLE WILL NOT BE GFI PROTECTED.
4. BATHROOMS: (A) ALL RECEPTACLES SHALL BE GFI PROTECTED. (B) LIGHTS OVER BATHTUBS SHALL HAVE COVERS THAT ARE LISTED FOR "DAMP LOCATION" (C) LIGHTS OVER SHOWERS SHALL HAVE COVERS LISTED FOR "WET LOCATION."
5. EXTERIOR RECEPTACLES SHALL ALL BE GFI PROTECTED AND SHALL HAVE WEATHERPROOF COVERS.
6. A RECEPTACLE (NOT SHOWN ON THE PLAN) WILL BE INSTALLED ON THE EXTERIOR WALL WITHIN 25 FEET OF THE AIR CONDITIONING EQUIPMENT.

LEGEND		
	CEILING FAN	110 VOLT OUTLET
		110 VOLT WATER PROOF OUTLET
	RECESSED LIGHTS	FLOOD LIGHTS
	WALL SWITCH 15A., 120V., SINGLE POLE SINGLE THROW, MOUNT AT 60" AFF	3 WAY WALL SWITCH 15A., 120V. MOUNT AT 60" AFF
	CARBON MONOXIDE DETECTOR	SMOKE DETECTOR
	CEILING LIGHT INCANDESCENT, 2-2"	LIGHT FIXTURE
	VENT/LIGHT FIXTURE	LIGHT FIXTURE

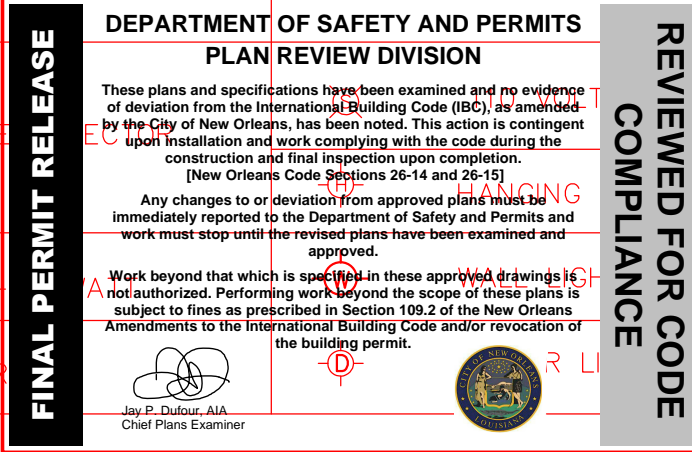

LARRY TRUMBATUR

8307 LAFITTE CT. CHALMETTE, LA 70043
504-279-3508

DATE
11/1/21

SHEET NO
3 OF 4

LIZZELL BROOKS
1962 N. TONTI STREET
ORLEANS PARISH
504-874-7266

WIND BORNE DEBRIS PROTECTION

WINDOWS IN BUILDING LOCATED IN WIND BORNE DEBRIS REGIONS SHALL HAVE GLAZED OPENINGS PROTECTED FROM WIND BORNE DEBRIS. WOOD STRUCTURAL PANELS WITH A MIN. THICKNESS OF 1/2" AND A MAX. SPAN OF 8 FEET SHALL BE PERMITTED FOR OPENING PROTECTION IN ONE AND TWO STORY BUILDINGS. PANELS SHALL BE PRECUT TO COVER THE GLAZED OPENINGS WITH ATTACHMENT HARDWARE PROVIDED.

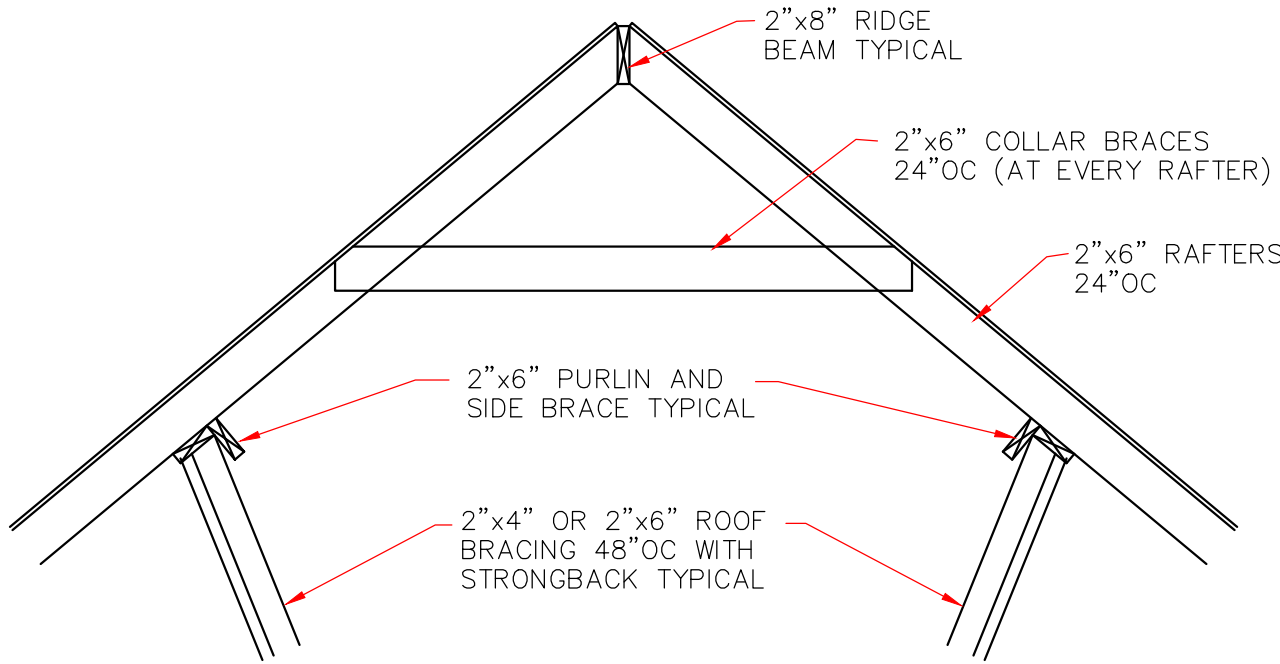
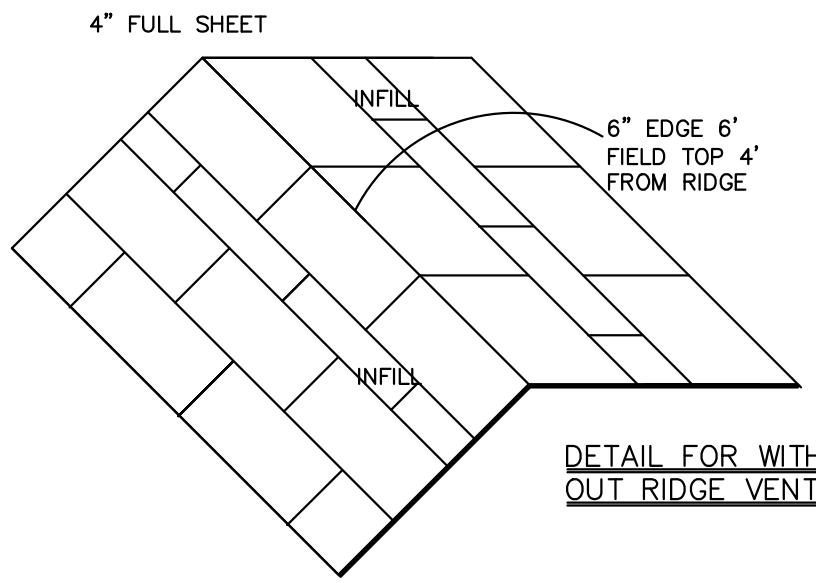

TYPICAL ROOF BRACING DETAIL
NOT TO SCALE

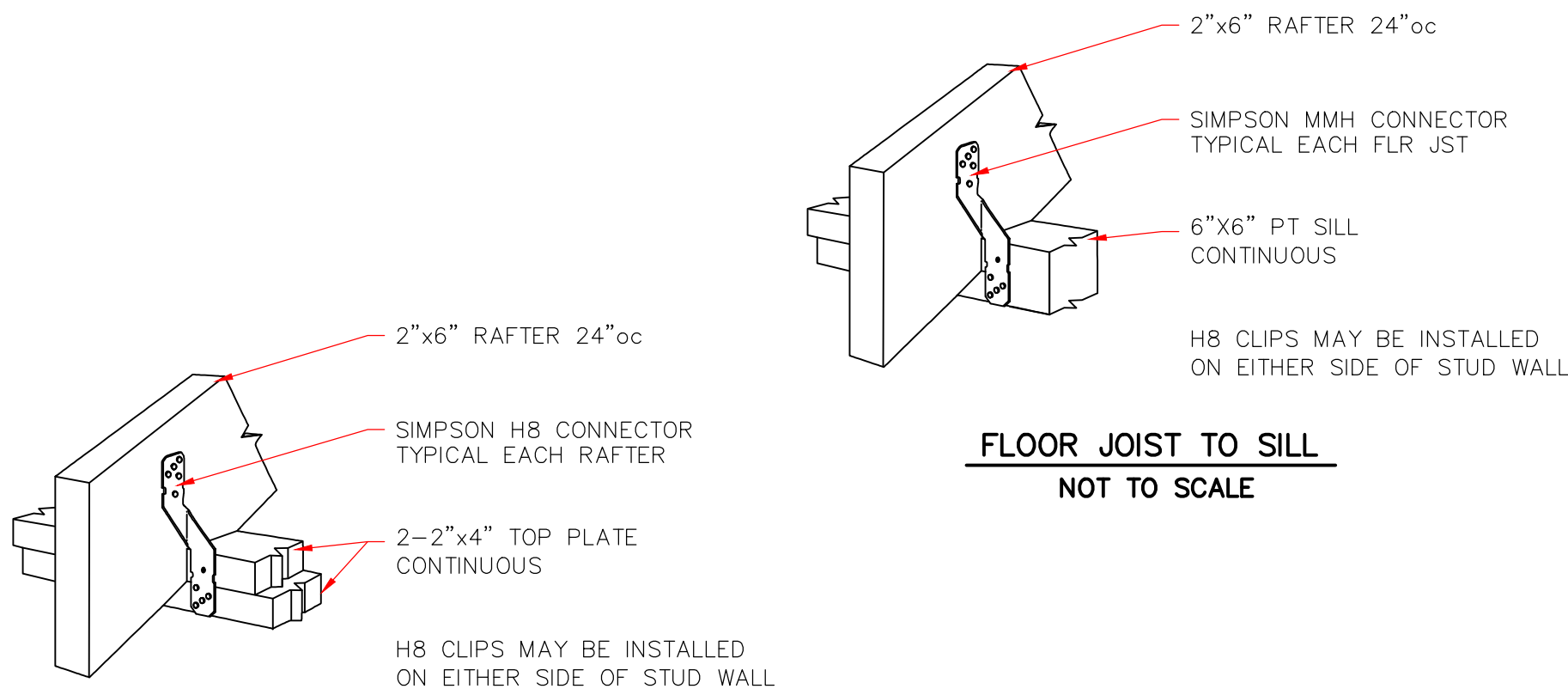

RAFTER TO TOP PLATES
NOT TO SCALE

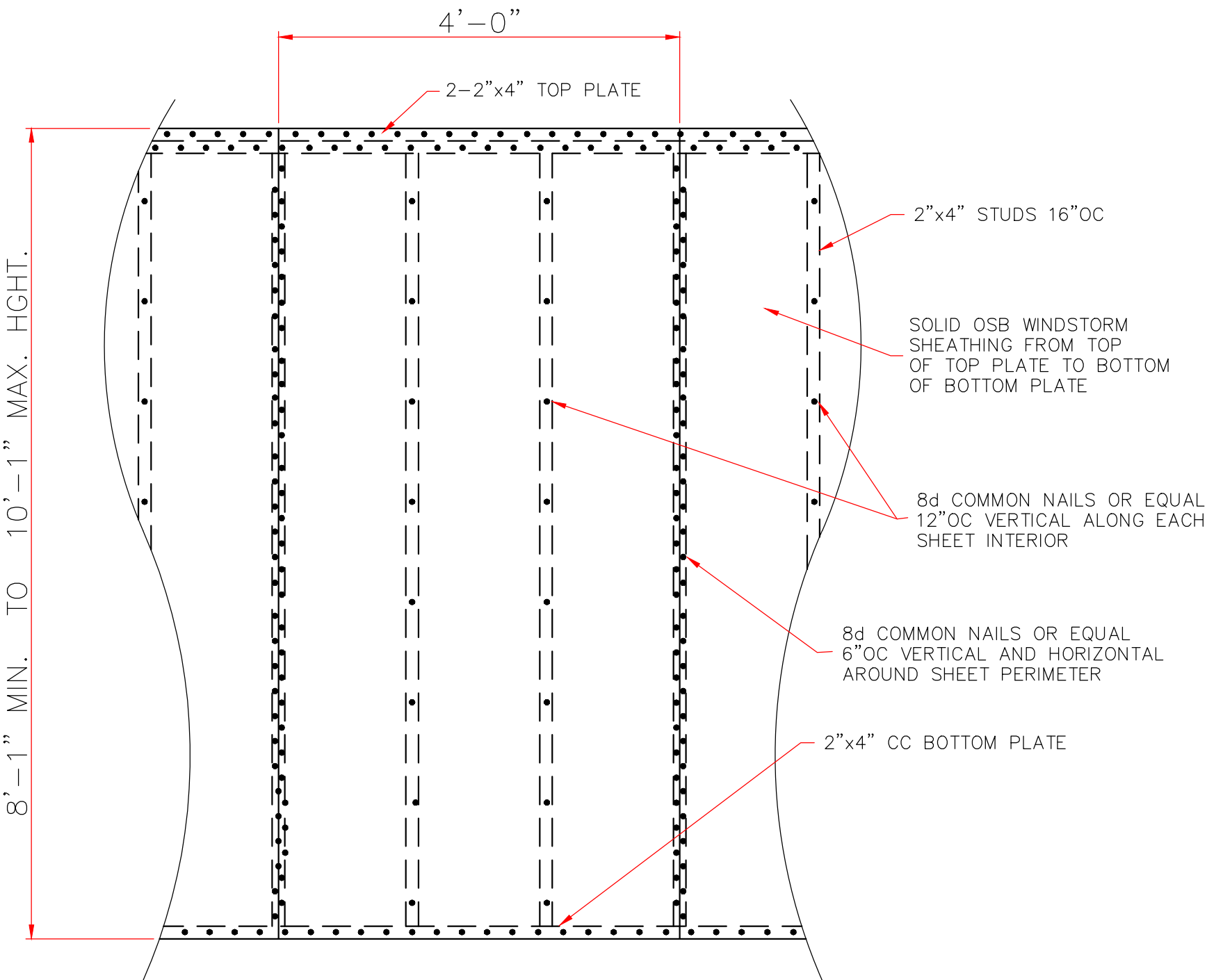

7/16" STORM SHEATHING
TYPICAL ALL EXTERIOR WALLS
SCALE: 3/4" = 1'-0"

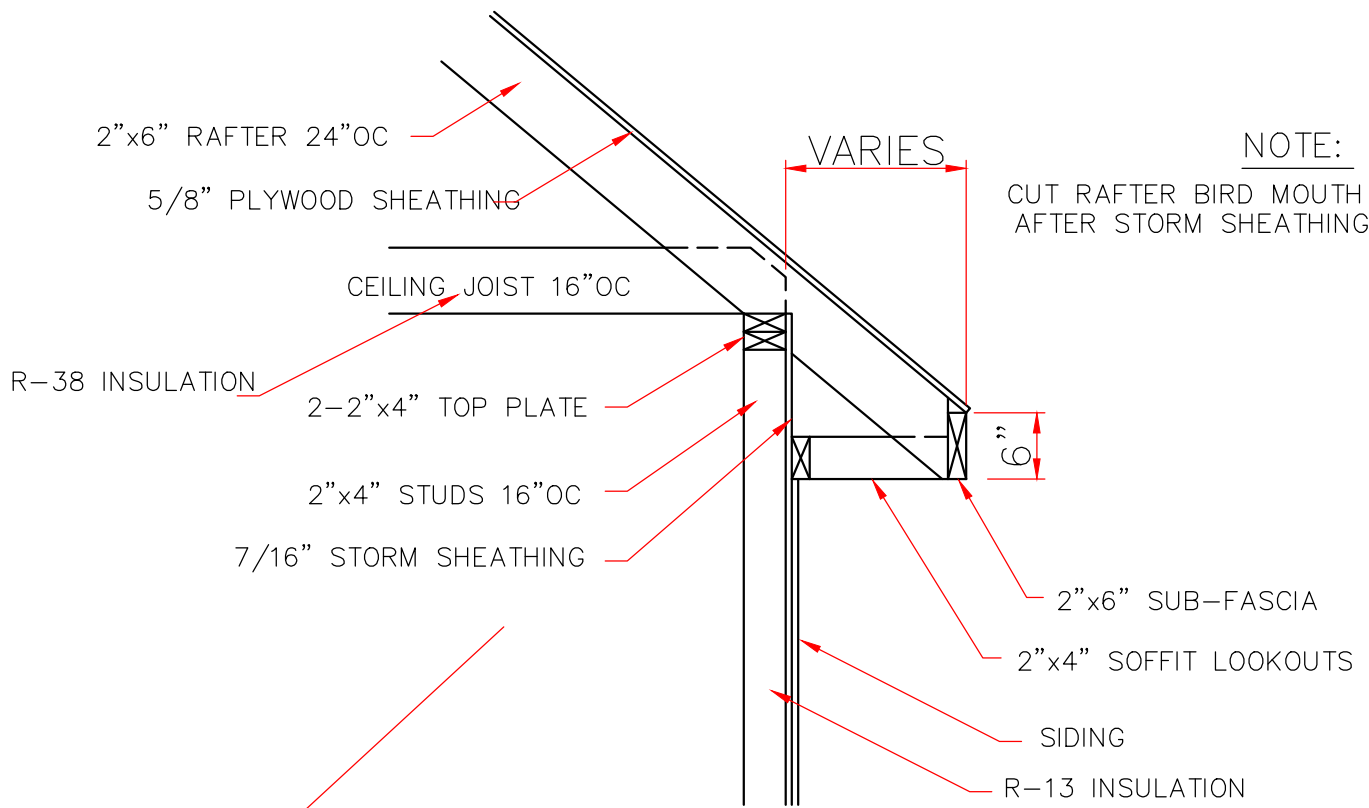

ROOF SOFFIT DETAIL
SCALE: 3/4" = 1'-0"
WITH FRAME CONSTRUCTION

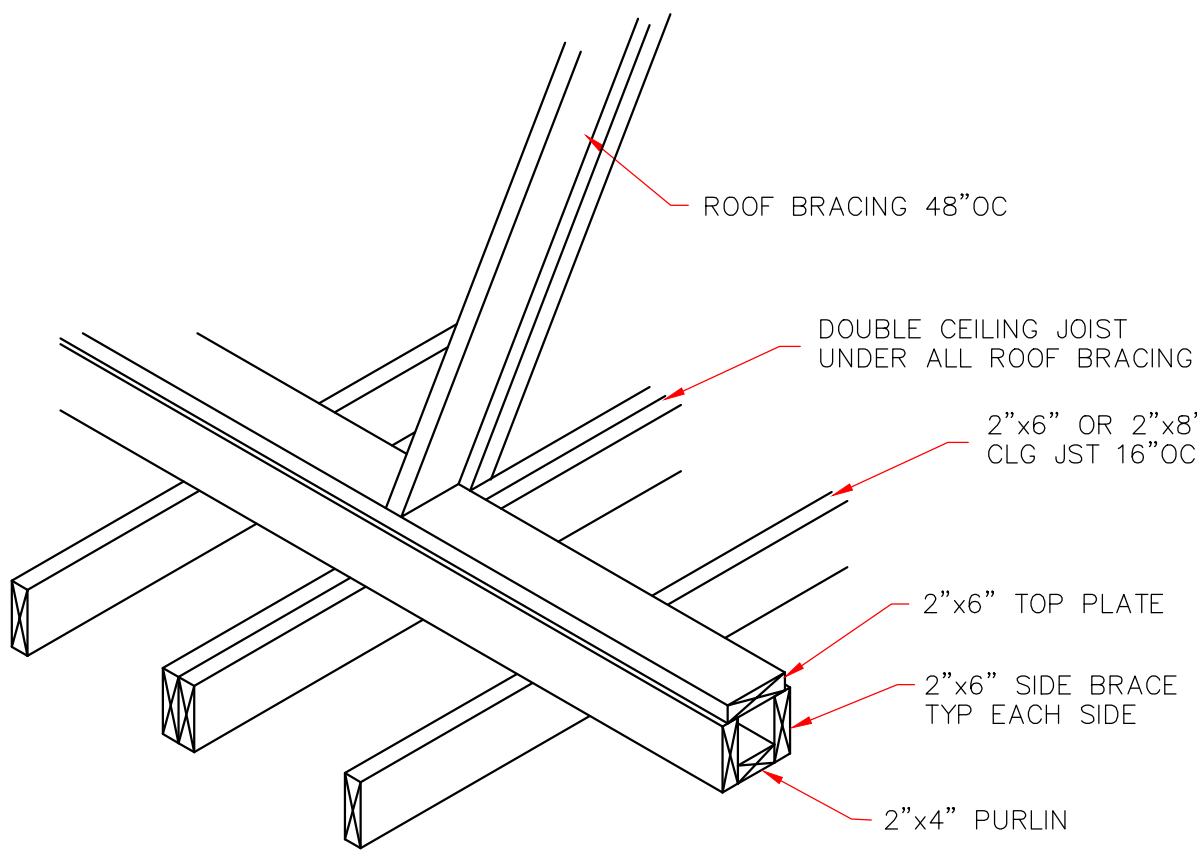

STRONGBACK DETAIL
FOR 2"x6" OR 2"x8" JOIST
NOT TO SCALE

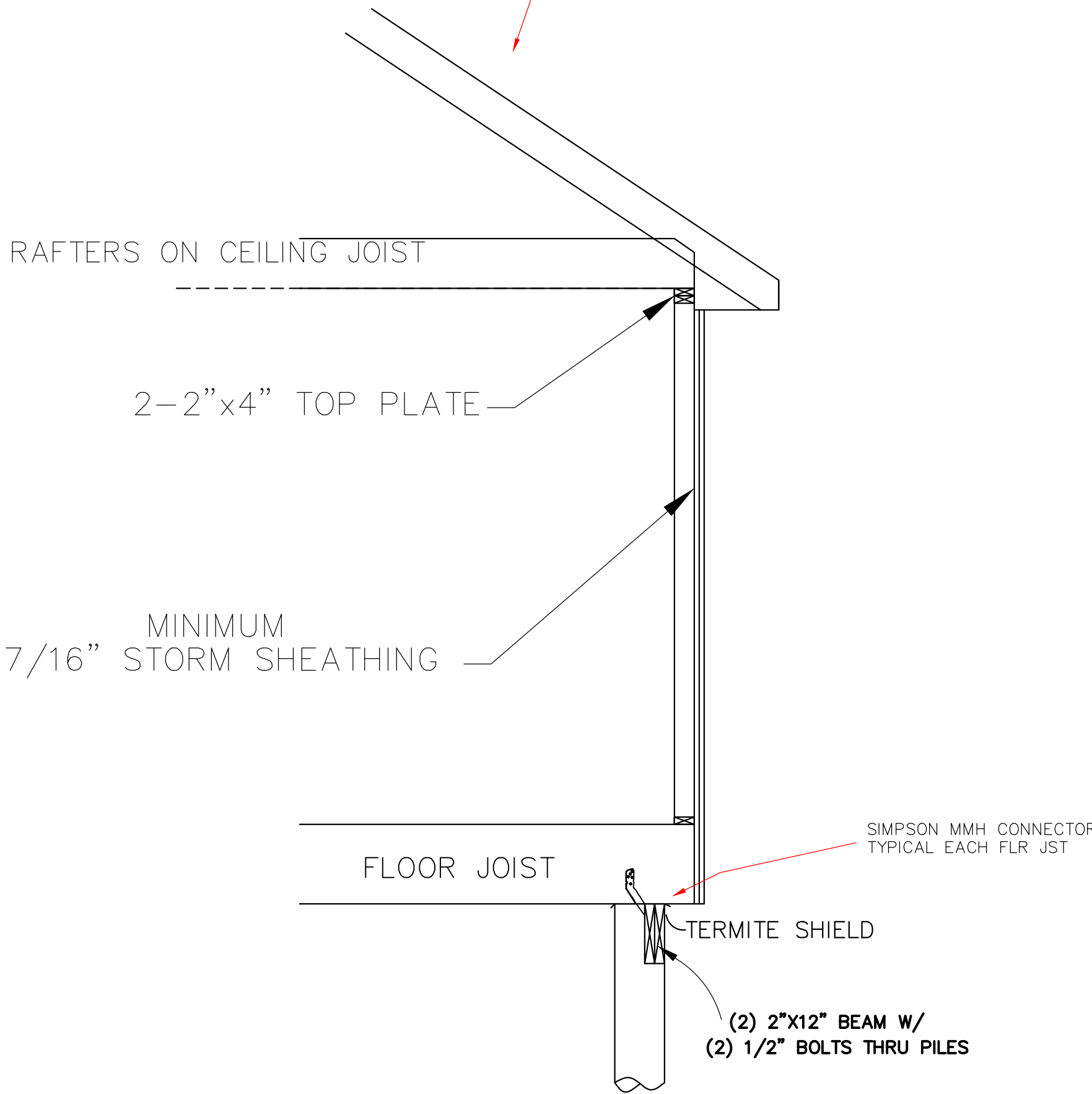

SEE FOUNDATION DETAIL

CONTINUOUS LOAD PATH
1/2" SCALE

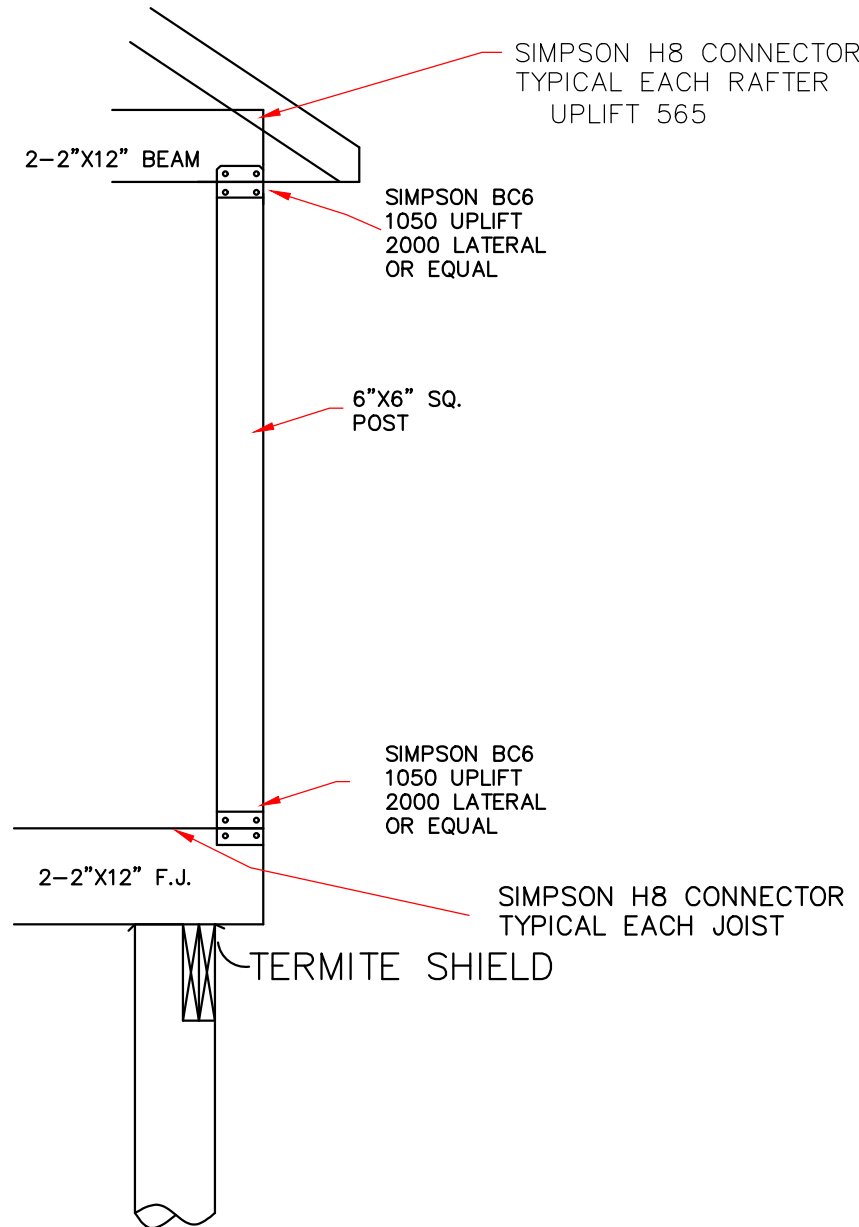

COLUMN SECTION
NOT TO SCALE

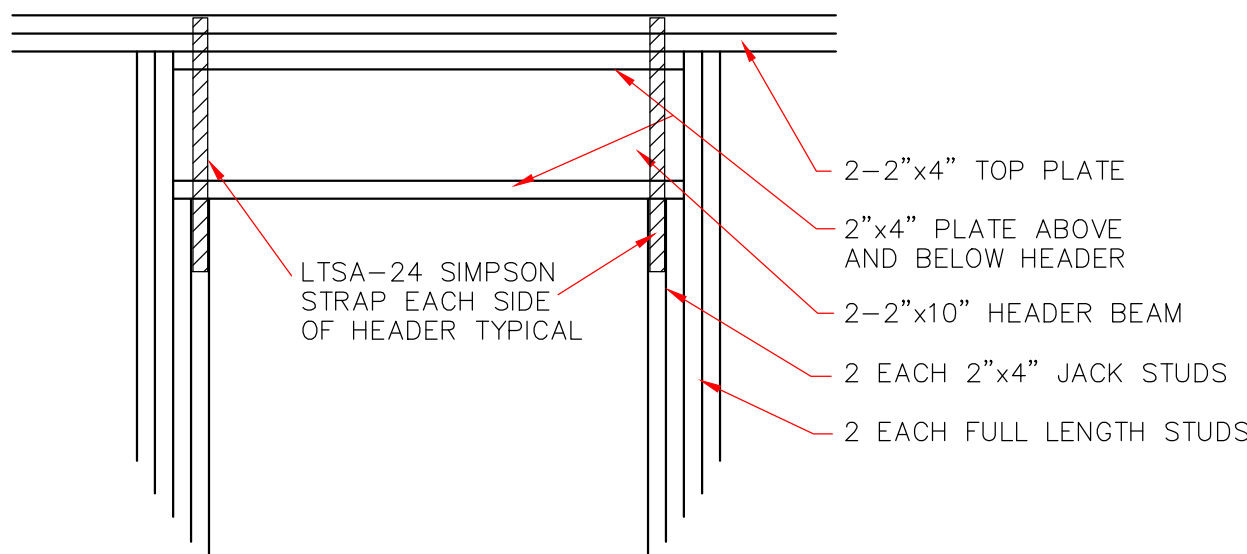

TYPICAL EXTERIOR DOOR
OR WINDOW HEADER
SCALE: 3/4" = 1'-0"

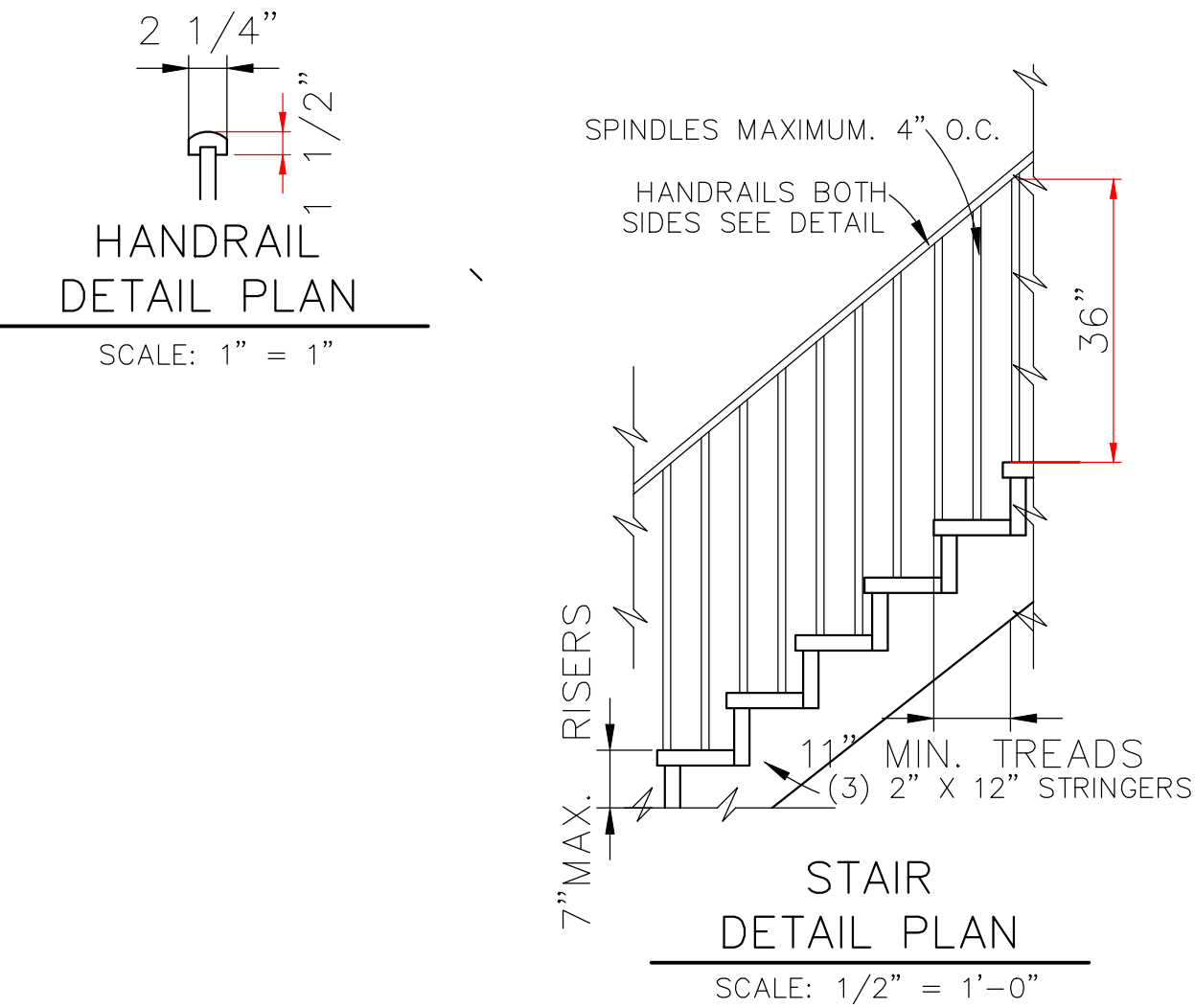

HANDRAIL
DETAIL PLAN
SCALE: 1" = 1"

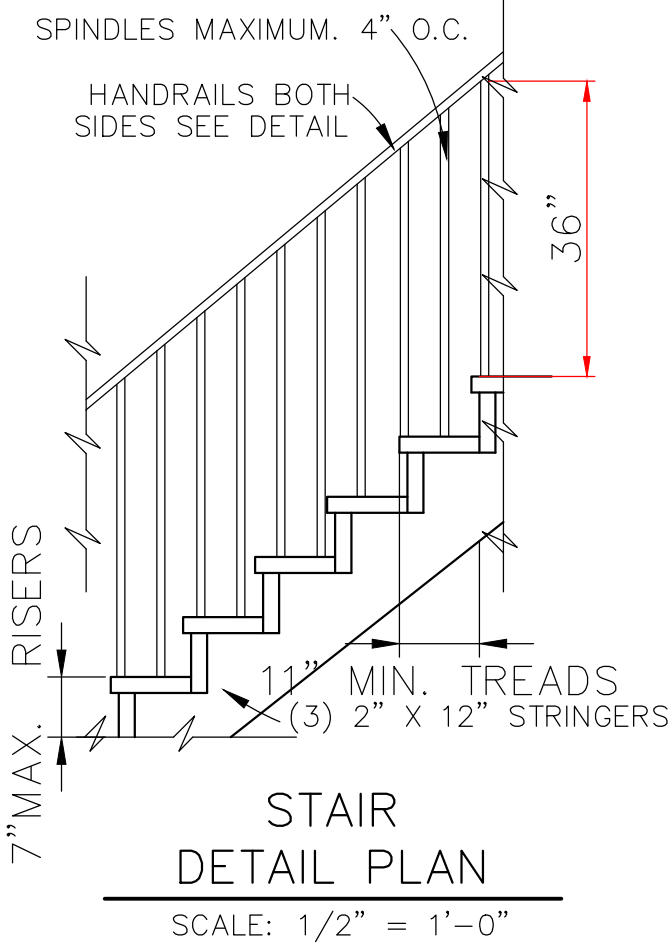

STAIR
DETAIL PLAN
SCALE: 1/2" = 1'-0"

CODE COMPLIANCE

DEPARTMENT OF SAFETY AND PERMITS
PLAN REVIEW DIVISION

WIND SPEED 130 MPH

1. THE 5 INTERMEDIATE RESIDENTIAL (New Orleans Code Sections 25-14 and 25-15)

2. WOOD FRAME CONSTRUCTION (ICC600)

3. INTERNATIONAL CODE COUNCIL STANDARD FOR RESIDENTIAL CONSTRUCTION IN HIGH WIND REGIONS (ICC600).

FINAL PERMIT RELEASE

REVIEWED FOR CODE COMPLIANCE

07/19/2022

jcthibodeaux

IN THE EVENT THAT A DIMENSIONAL DISCREPANCY IN THE DRAWINGS IS DISCOVERED BY THE GENERAL CONTRACTOR, SUBCONTRACTORS, ENGINEER, CONSULTANT, OR A SUPPLIER, SAID PARTY SHALL IMMEDIATELY NOTIFY THE ARCHITECT AND SUSPEND ALL ASSOCIATED WORK UNTIL SUCH TIME THAT A PROPER DETERMINATION HAS BEEN MADE BY THE ARCHITECT, WITH APPROPRIATE INSTRUCTIONS FOR RESOLUTION OF THE ISSUE. FAILURE TO REPORT KNOWN DISCREPANCIES AND CONTINUING WITH THE WORK WITHOUT NOTIFYING THE ARCHITECT SHALL RESULT IN AN ASSUMPTION OF RESPONSIBILITY FOR CORRECTIVE WORK TO ACHIEVE THE INTENDED DESIGN.

THESE PLANS HAVE BEEN PROPERLY EXAMINED BY THE UNDERSIGNED. I HAVE DETERMINED THAT THEY COMPLY WITH THE FOLLOWING EXISTING STATE AND LOCAL BUILDING CODES FOR THE JURISDICTION IN WHICH THE RESIDENCE IS TO BE LOCATED.

LARRY TRUMBATUR

8307 LAFITTE CT. CHALMETTE, LA 70043
504-279-3508

LIZZELL BROOKS
1962 N. TONTI STREET
ORLEANS PARISH
504-874-7266

DATE
11/1/21

SHEET NO
4 OF 4