

PROPOSED UPPER FLOOR PLAN
SCALE: 1/4" = 1'-0"

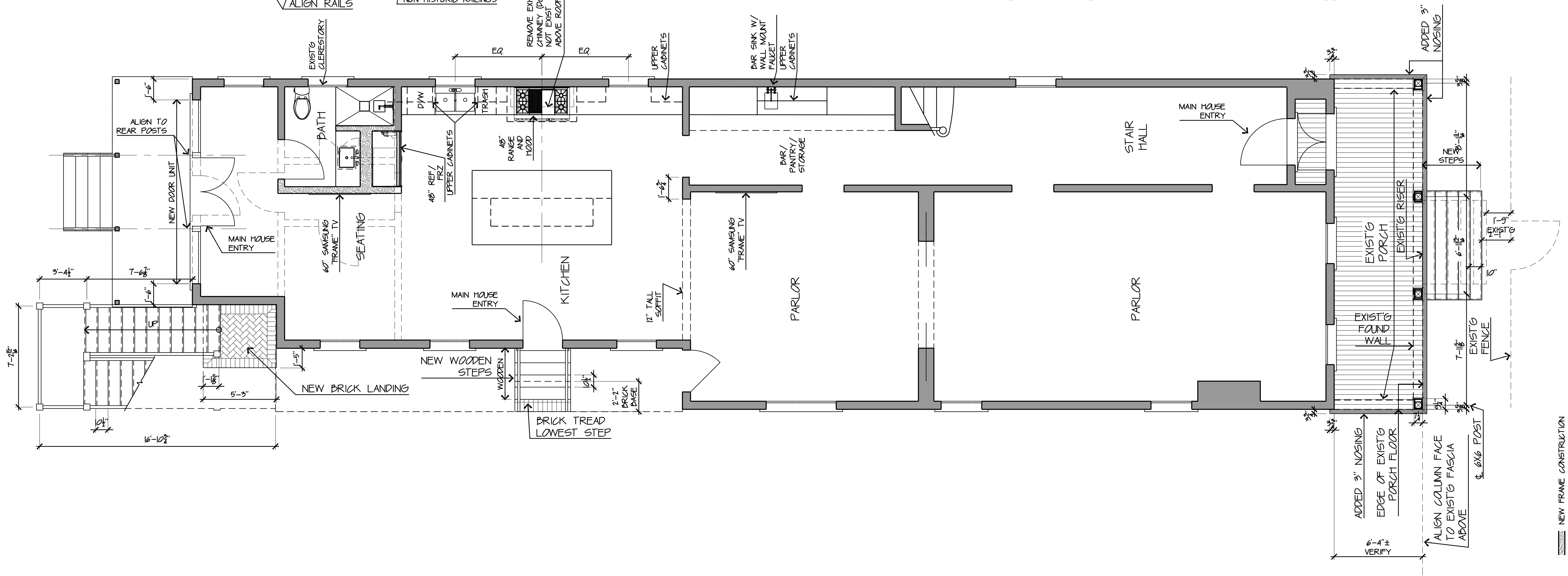

PROPOSED MAIN FLOOR PLAN
SCALE: 1/4" = 1'-0"

NEW FRAME CONSTRUCTION
EXIST'G WALLS
TO BE DEMOLISHED

NOTE:
AT NEW DOORS MATCH ADJACENT TRIM EXACTLY, INCLUDING TRIM AND CASING. DOORS TO MATCH ADJACENT HISTORIC DOORS W/ PANEL MOLD ON ALL SIDES. DOORS OF PANEL INTERIORS ONLY ON TOP AND BOTTOM OF THE PANELS. DO NOT MATCH THIS DOOR LIKEWISE THE MASTER BEDROOM HAS DOOR BUILT ON FLYWOOD BACK DO NOT MATCH

NOTE:
CONTRACTOR TO MEET W/ STRUCTURAL ENGINEER AFTER PERM TO REVIEW UNFORESEEN STRUCTURAL CONDITIONS BEFORE FRAMING. NO PERMANENT FRAMING TO BE INSTALLED WITHOUT THIS MEETING

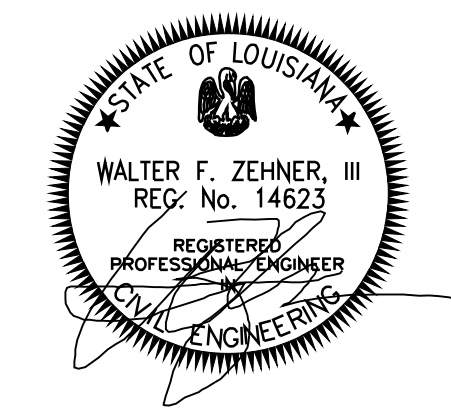

PORCH RESTORATION AND INTERIOR RENOVATIONS 1465 MAGAZINE STREET NEW ORLEANS, LA		Revised
		7/11/22
STUDIO L+R, LLC 1208 BARRACKS STREET NEW ORLEANS, LA 70116 256.609.4313	Issued	6/30/22
	Printed	6/30/22
	CAD File	MAIN FLOOR PLAN
Project No.	LER	Drawn by
MAIN FLOOR PLAN / UPPER FLOOR PLAN		Sheet No.
		2