

**SQ. NO. 138
THIRD DISTRICT**

**NEW ORLEANS, LA
ORLEANS PARISH**

A Resubdivision of Lot 16-A into Lots 16-X & 16-Y.

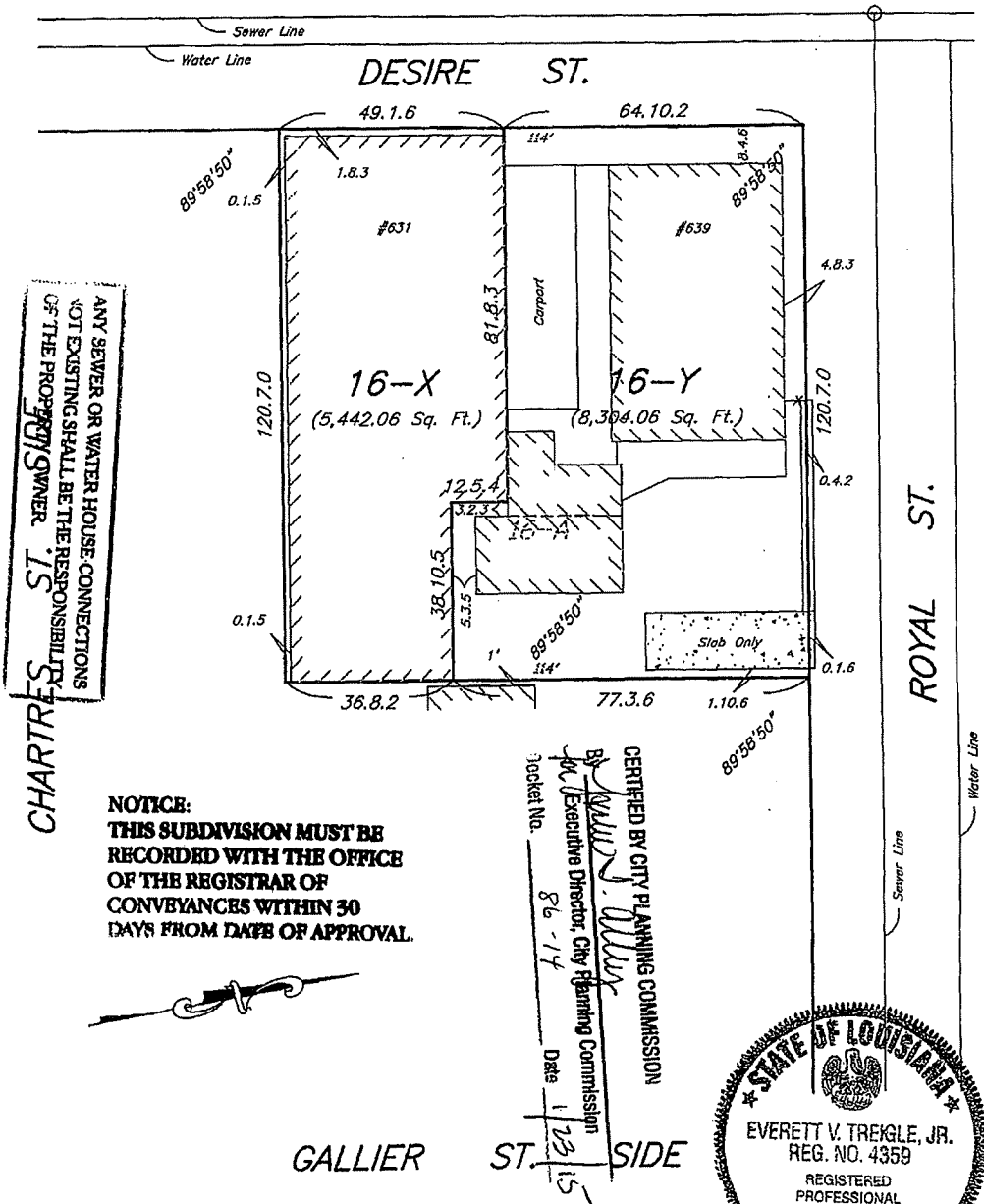

NOTICE:
THIS SUBDIVISION MUST BE
RECORDED WITH THE OFFICE
OF THE REGISTRAR OF
CONVEYANCES WITHIN 30
DAYS FROM DATE OF APPROVAL.

CERTIFIED BY CITY PLANNING COMMISSION
By *[Signature]*
Executive Director, City Planning Commission
Booklet No. 86-14
Date 8/6/14

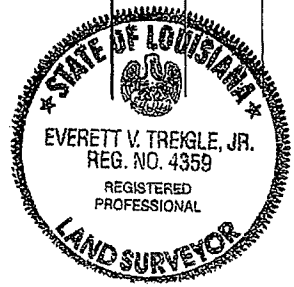

No Trees in Public R/W

Note:
Improvements may not be to scale for clarity.
The dimensions shown prevail over scale.

THE SERVITUDES SHOWN ON THIS PLAT ARE LIMITED TO THOSE FURNISHED TO US. THERE IS NO REPRESENTATION THAT ALL APPLICABLE SERVITUDES ARE SHOWN HEREON. THE SURVEYOR HAS MADE NO TITLE SEARCH OR PUBLIC RECORD SEARCH IN COMPILING DATA FOR THIS SURVEY.

THE FEDERAL INSURANCE ADMINISTRATION FLOOD HAZARD BOUNDARY MAP INDICATES THAT THE ABOVE DESCRIBED PROPERTY IS LOCATED IN FIA ZONE
Lot angles as per plan.

Date: August 1, 2014

Scale: 1" = 30'

This plat represents an actual ground survey made by me or under my direct supervision and control and meets the requirements for the Standards of Practice for Boundary Surveys as found in Louisiana Administrative Code TITLE 46:LXI, Chapter 25 for a Class "C" survey.
Made at the request of Paul J. Poggi.

Gilbert, Kelly & Couturie, Inc., Surveying & Engineering
2121 N. Causeway Blvd., Metairie LA 70001 (504) 836-2121 *[Signature]*